



Proctor Way, Upper Rissington, GL54 2RA

**SHELDON
BOSLEY
KNIGHT**

LAND AND
PROPERTY
PROFESSIONALS

Property Description

*** AVAILABLE 24th MAY *** A splendid, four bedroom, detached, family home, located on the edge of a modern development, just opposite a beautiful green space and countryside beyond, ideal for dog walking. Upper Rissington is a desirable Cotswold village and this home is conveniently located just around the corner from the local Primary School and shop.

Accommodation comprises of a welcoming entrance hall with WC off, the generous kitchen diner has ample room to seat 6 at a dining table, there are also double doors leading out to the walled garden. The Living room has been decorated in striking and contemporary blue however this room remains light due to the dual aspect windows. Upstairs bedroom one has an en-suite, there are three further good sized bedrooms and a family bathroom. Externally the walled garden has a patio and lawn area and access leading to the rear driveway and single garage. Offered unfurnished. Council Tax Band E. Energy Rating B. A pet considered.





Key Features

- *** AVAILABLE 24th MAY ***
- Upper Rissington
- 4 Bedrooms
- Detached Home
- Unfurnished
- Walled Garden
- Garage & Driveway Parking
- Council Tax Band E
- Energy Rating B
- Edge of town, overlooking green space

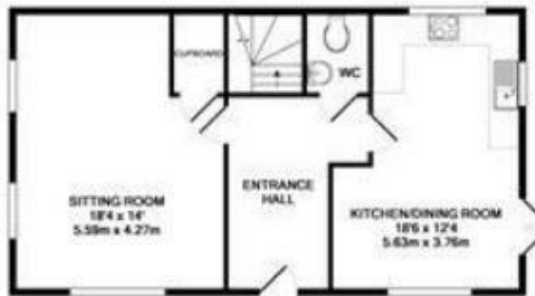

GROUND FLOOR

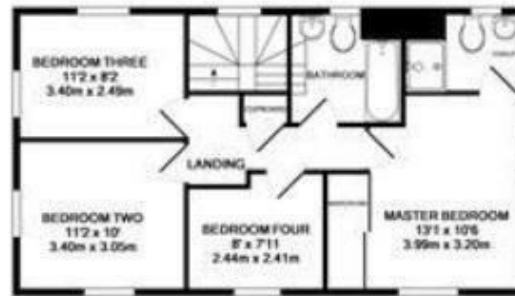

1ST FLOOR

While every attempt has been made to ensure the accuracy of the floor plan contained here, measurements of doors, windows, rooms and any other items are approximate and no responsibility is taken for any error, omission or misstatement. This plan is for illustrative purposes only, and should be used as such by any prospective purchaser. The services, systems and appliances shown here have not been tested and no guarantee as to their operability or efficiency can be given.
Made with Metron 6278

£1,900 PCM