



Bradley Drive, Shipston-On-Stour, CV36 4RP

**SHELDON
BOSLEY
KNIGHT**

LAND AND
PROPERTY
PROFESSIONALS

Property Description

An immaculately presented open-plan semi-detached home with two double bedrooms built by Taylor Wimpey in 2020 benefitting from the remainder of its NHBC warranty.

On entering you will find a large downstairs WC to the right and a useful utility/ storage cupboard on the left with plumbing for a washing machine. The kitchen area has a good range of units, a built-in electric oven with an induction hob over and a slim line dishwasher, the sitting/ dining area overlooks the garden and has large patio doors allowing lots of natural light in. Upstairs, you'll find two double bedrooms, one of which has a large storage cupboard. The bathroom has a bath with a shower head over it. The rear of the property boasts a westerly-facing garden with a good sized patio and lawn. To the front there are 2 allocated parking spaces side by side.

The property is heated via gas-fired central heating and has UPVC double glazing throughout.





Key Features

- NO ONWARD CHAIN
- 2 Double bedrooms
- Sunny rear garden
- Walking distance to the towns amenities
- Nursery, primary & secondary schools within the town
- 10 mins drive from mainline Oxford/ London rail
- Remainder of NHBC warranty
- Ideal for first time buyers and investors
- Separate utility cupboard
- 2 Parking spaces side by side

Guide Price
£275,000



Ground Floor

Approx. 34.8 sq. metres (374.2 sq. feet)

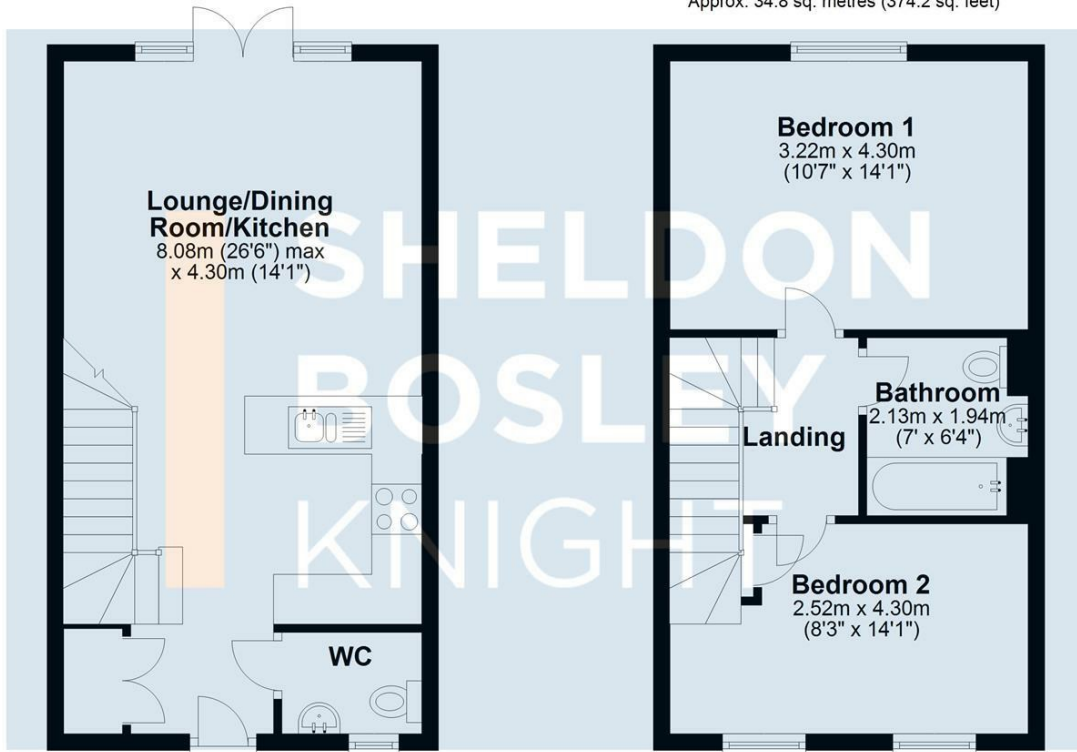

First Floor

Approx. 34.8 sq. metres (374.2 sq. feet)



Total area: approx. 69.5 sq. metres (748.4 sq. feet)

All efforts have been made to ensure that the measurements on this floorplan are accurate however these are for guidance purposes only.
Plan produced using PlanUp.



EPC Rating - B

Tenure - Freehold

Council Tax Band - C

Local Authority
Statford District Council



We routinely refer clients to both our recommended legal firm and a panel of financial services providers. It is your decision whether you choose to deal with these companies. In making that decision, you should know that we receive a referral fee.

**SHELDON
BOSLEY
KNIGHT**

LAND AND
PROPERTY
PROFESSIONALS