



FORD & PARTNERS

ESTATE AGENTS



32, Cedarwood Court Pettifer Way, High Wycombe, HP12 3UH

Introducing Cedarwood Court, an exceptional boutique development offering just six newly renovated two-bedroom apartments.

LIMITED-TIME INCENTIVE: Enjoy 50% off your first month's rent

Each apartment boasts two well-sized double bedrooms, a contemporary fully fitted kitchen with integrated appliances, and a brand-new family bathroom. Bright, spacious reception rooms provide the perfect setting for unwinding or hosting guests.

With only a few apartments still available, now is the ideal moment to secure your new home. Contact our office today to arrange a viewing.

£1,350 Per month

- **Stunning Two Double Bedroom Apartment**
- **Modern Family Bathroom**
- **Modern Kitchen with Brand-New Appliances**
- **Ground, First or Second Floor Apartments Available**
- **Ample Residents Parking**
- **Far Reaching View over the Town Centre**
- **Fully Managed Tenancy by Ford & Partners**
- **Close Proximity to Town Centre & M40**
- **Reserve your New Home Today!**
- **Private & Quiet Residential Area**

Pettifer Way, HP12 3UH

Approximate Gross Internal Area = 660 sq ft / 61.3 sq m
Store = 17 sq ft / 1.6 sq m
Total = 677 sq ft / 62.9 sq m



CH
2.24 = Ceiling Height

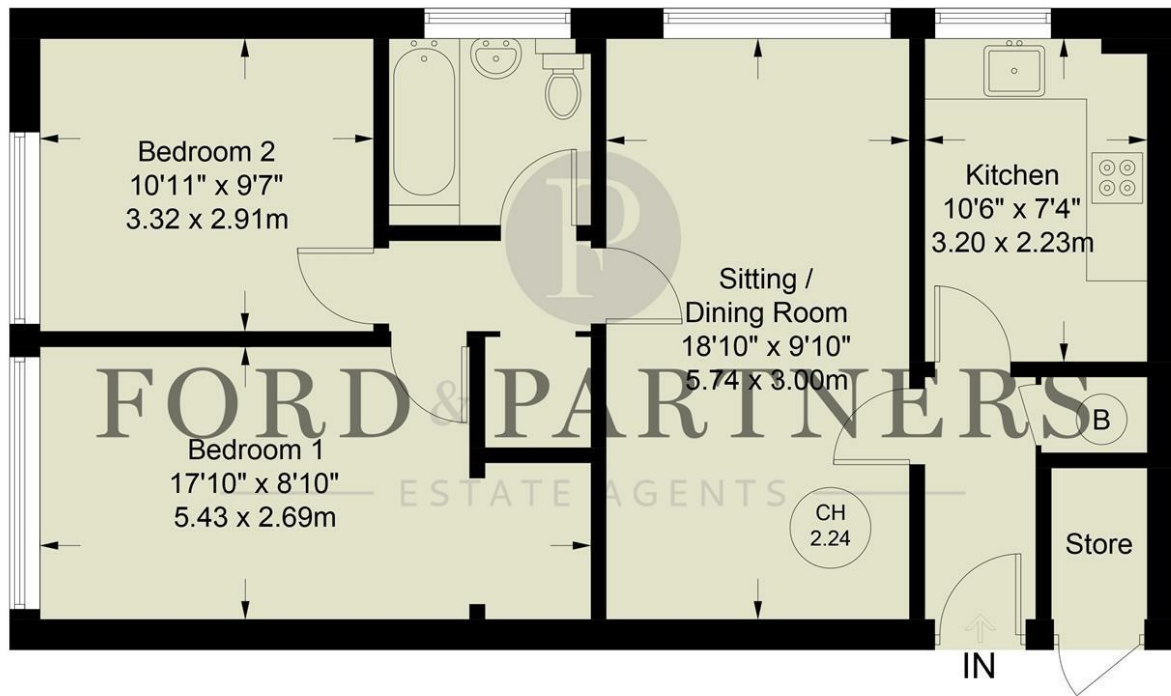

Floor Plan produced for Ford & Partners by Media Arcade ©.
Illustration for identification purposes only. Window and door openings are approximate. Whilst every attempt is made to assure accuracy in the preparation of this plan, please check all dimensions, shapes and compass bearings before making any decisions reliant upon them.

Energy Efficiency Rating		
	Current	Potential
Very energy efficient - lower running costs		
(92 plus) A		
(81-91) B		
(69-80) C		
(55-68) D		
(39-54) E		
(21-38) F		
(1-20) G		
Not energy efficient - higher running costs		
England & Wales	EU Directive 2002/91/EC	

Environmental Impact (CO ₂) Rating		
	Current	Potential
Very environmentally friendly - lower CO ₂ emissions		
(92 plus) A		
(81-91) B		
(69-80) C		
(55-68) D		
(39-54) E		
(21-38) F		
(1-20) G		
Not environmentally friendly - higher CO ₂ emissions		
England & Wales	EU Directive 2002/91/EC	

