



FORD & PARTNERS

ESTATE AGENTS



17 Pettifer Way, High Wycombe, HP12 3UH

50% OFF FIRST MONTHS RENT

A spacious two double bedroom apartment situated in a quiet location close to the Town Centre & M40.

The property features two spacious double bedrooms, a bright and welcoming reception room, a contemporary fitted kitchen with integrated appliances, a modern family bathroom, and convenient storage throughout.

Reserve your new home today! Please note: photographs shown are of the Show Apartment.

- **50% OFF FIRST MONTHS RENT!**
- **TWO DOUBLE BEDROOMS**
- **BRAND-NEW KITCHEN**
- **BRAND-NEW BATHROOM**
- **QUIET DEVELOPMENT**
- **RESIDENTS PARKING**
- **GROUND, FIRST & SECOND FLOOR APARTMENTS AVAILABLE**
- **RESERVE YOUR NEW HOME TODAY!**

£1,400 Per month

Pettifer Way, HP12 3UH

Approximate Gross Internal Area = 660 sq ft / 61.3 sq m
 Store = 17 sq ft / 1.6 sq m
 Total = 677 sq ft / 62.9 sq m



CH
2.24 = Ceiling Height

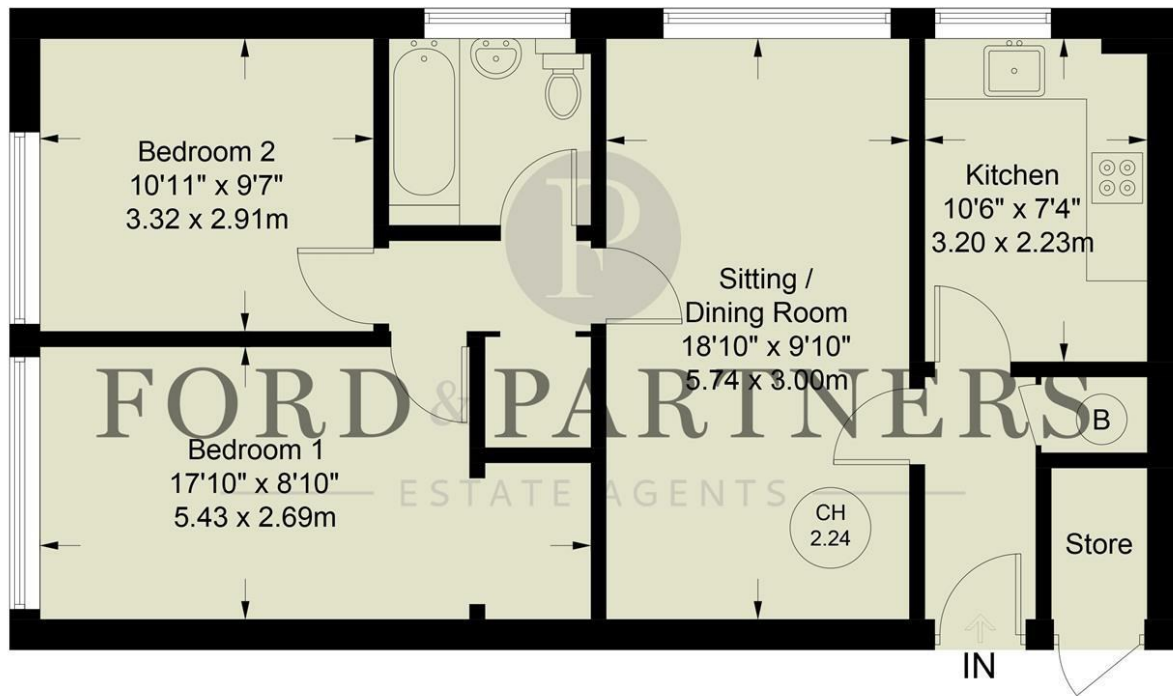

Floor Plan produced for Ford & Partners by Media Arcade ©.
 Illustration for identification purposes only. Window and door openings are approximate. Whilst every attempt is made to assure accuracy in the preparation of this plan, please check all dimensions, shapes and compass bearings before making any decisions reliant upon them.

