



FORD & PARTNERS

ESTATE AGENTS



16 Pettifer Way, High Wycombe, HP12 3UH

50% OFF FIRST MONTHS RENT

A recently renovated one double bedroom apartment situated in a small apartment building of just nine apartments.

The apartment comprises of a modern kitchen modern bathroom, large reception room and spacious double bedroom.

Further features include modern electric heating, brand-new UPVC double glazing and residents parking.

- **50% OFF FIRST MONTHS RENT**
- **BRAND-NEW KITCHEN**
- **BRAND-NEW BATHROOM**
- **APPLIANCES INCLUDED**
- **QUIET RESIDENTIAL AREA**
- **CLOSE PROXIMITY TO M40 & TOWN CENTRE**
- **AVAILABLE IMMEDIATELY**
- **RESERVE YOUR NEW HOME TODAY!**
- **Ground, First and Second Floor Apartments Available**

£1,200 Per month

Pettifer Way, HP12 3UH

Approximate Gross Internal Area = 498 sq ft / 46.3 sq m



CH 2.26 = Ceiling Height

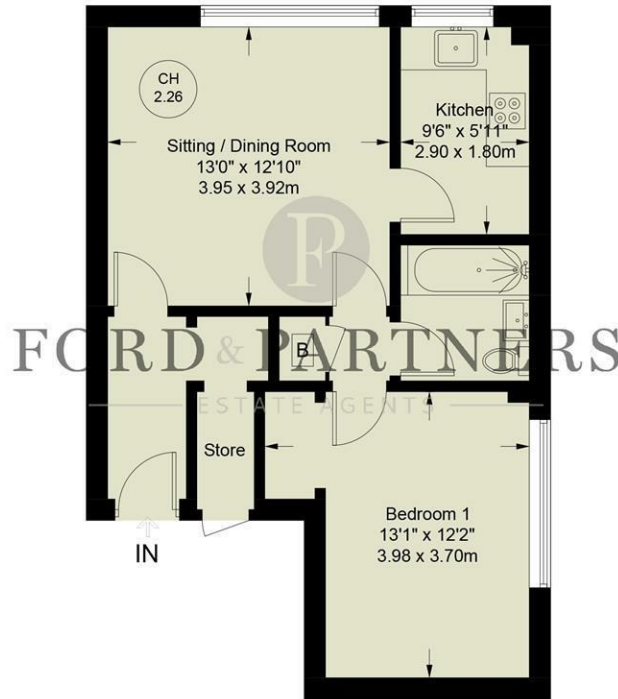

Floor Plan produced for Ford & Partners by Media Arcade ©.
Illustration for identification purposes only. Window and door openings are approximate. Whilst every attempt is made to assure accuracy in the preparation of this plan, please check all dimensions, shapes and compass bearings before making any decisions reliant upon them.

