



FORD & PARTNERS

— ESTATE AGENTS —

Mountain Ash Marlow SL7 3PB



Mountain Ash Marlow SL7 3PB

Asking price £730,000

A Delightful Three-Bedroom Detached Home in a Quiet Marlow Bottom Cul-de-Sac

Nestled in a peaceful and private cul-de-sac in Marlow Bottom, this charming three-bedroom detached property offers comfortable and flexible living, ideal for families or those seeking a tranquil retreat.

Description

Upon entering through the front door, you're welcomed into a generous central hallway, with the staircase straight ahead. To the left, a spacious sitting room boasts far-reaching views across the valley—perfect for relaxing or entertaining guests.

The ground floor also features a well-proportioned third bedroom, a modern family bathroom, a dining room, and a bright kitchen/breakfast room ideal for everyday living.

Upstairs, you'll find two generously sized double bedrooms, both with fitted wardrobes, as well as a convenient WC with washbasin.

Outside, the beautifully landscaped rear garden offers a private oasis with a paved patio ideal for outdoor dining, a lawn area, and mature flower beds. At the front, there's a neatly maintained lawn, driveway parking for three vehicles, and access to the garage—with potential to extend parking further if desired.

Additional features include gas central heating, UPVC double glazing, eaves storage, and gated side access to the rear garden.

Situation

Mountain Ash is located in Marlow Bottom, less than 0.2 miles to local shops and services in Marlow Bottom, including convenience stores, butchers, dentist, chemist, hairdressers and a restaurant. Burford Primary School is just a short walk away on the Marlow Bottom Road. Marlow town is approximately three miles away and offers vast local amenities, including independent and high street shops, supermarkets, post office, hairdressers, eateries and picturesque walks along the riverside. Marlow also benefits from great transport links to London Paddington via Maidenhead by way of train and easy access to the M4 and M40 a short drive away.

There are a range of local recreational facilities including golf at Harleyford & Temple golf clubs, rowing at Marlow Rowing Club, cricket clubs and Court Garden Leisure Complex with a gym and pool. The property is well served for local schools of all ages, including Sir William Borlase Grammar School, Church of England Infant School, Spinfield and Great Marlow Secondary. The property is also in catchment for John Hampden Grammar School and Wycombe High Grammar School.



Floor Plans

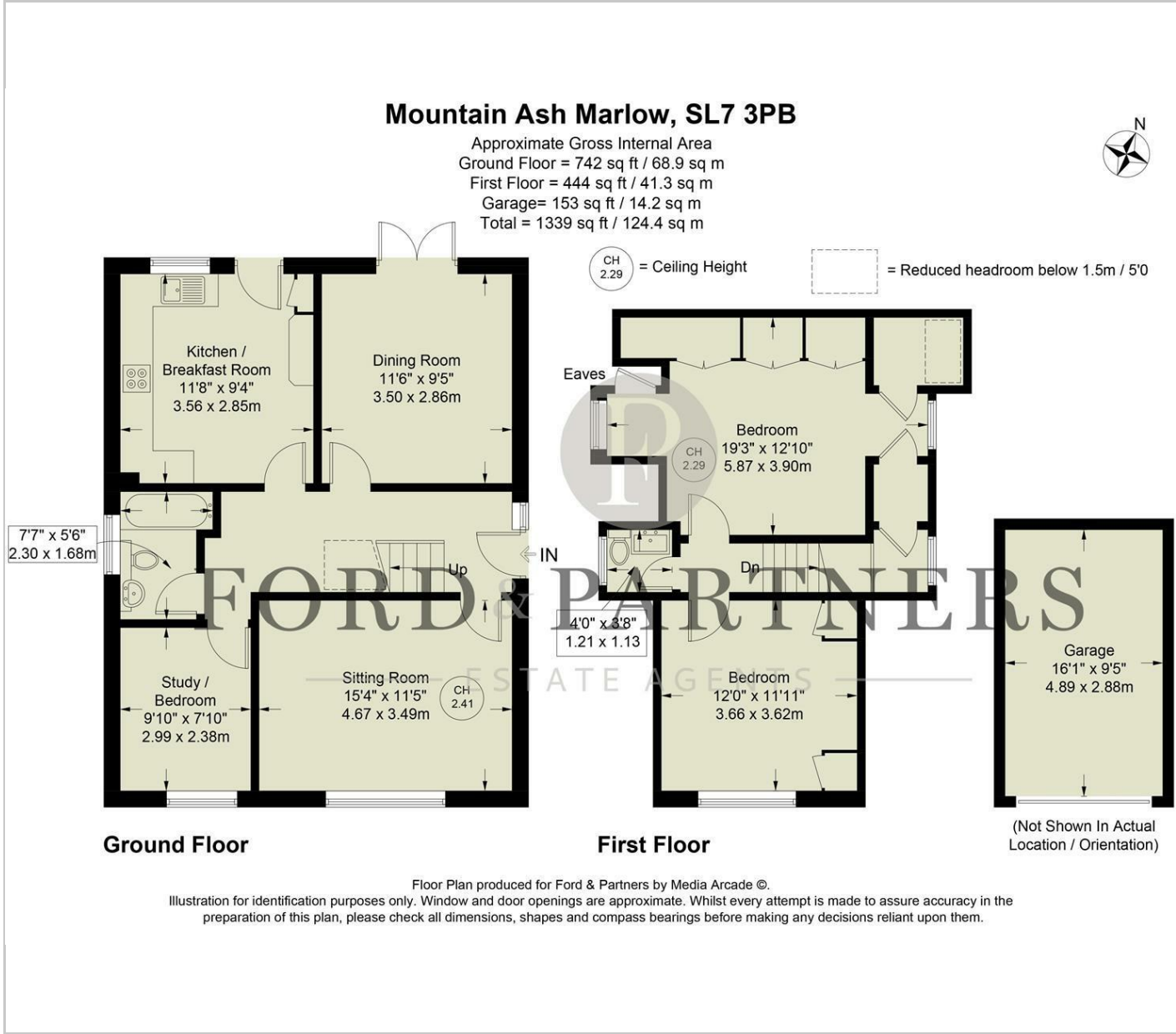

Area Map



Energy Performance Graph

