



FORD & PARTNERS

— ESTATE AGENTS —

Freer Crescent High Wycombe HP13 7QZ



Freer Crescent High Wycombe HP13 7QZ

Guide price £230,000

This beautifully presented two-bedroom apartment is located within a popular development on the desirable east side of High Wycombe's town centre.

Description

Upon entering, you are welcomed by a central hallway, with the contemporary family bathroom directly ahead. To the right, you'll find two spacious double bedrooms, including a principal bedroom that enjoys access to a private, south-facing balcony—perfect for relaxing in the sun.

A standout feature of the home is the bright and airy open-plan kitchen, dining, and living area. With its dual-aspect design, the space is bathed in natural light, creating a warm and inviting atmosphere ideal for both entertaining and everyday living.

Additional highlights include electric underfloor heating, secure underground parking, and beautifully maintained communal gardens.



Situation

Hayter Lodge offers convenient access to both local amenities and excellent transport links. Junction 3 of the M40 is just over a mile away, while High Wycombe train station—offering direct services to London Marylebone (27 minutes) and Oxford (40 minutes)—is only 2 miles from the property. Kingsmead Park is also just a short stroll away, providing open green space to enjoy year-round.



Floor Plans

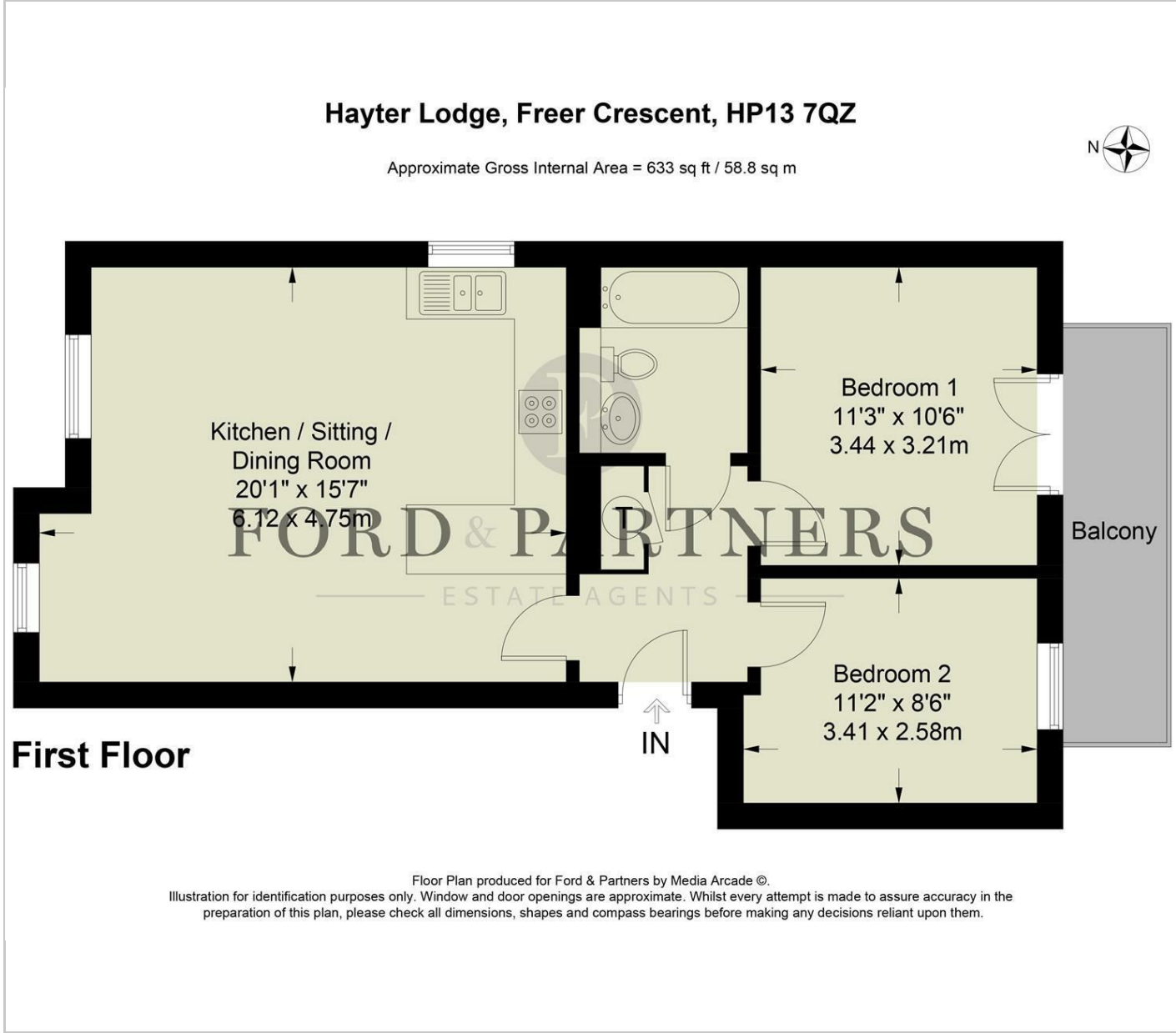

Area Map



Energy Performance Graph

