



FORD & PARTNERS

ESTATE AGENTS



245 Chairborough Road, High Wycombe, HP12 3UL

LAST REMAINING TOP FLOOR APARTMENT - INCENTIVES AVAILABLE!

Benefitting from stunning views, a recently renovated two double bedroom top floor apartment situated in a purpose-built apartment building on the north-west side of High Wycombe's Town Centre.

The accommodation consists of two double bedrooms, a bright and airy reception room, a stylish kitchen with appliances, modern family bathroom and ample storage.

RESERVE YOUR NEW HOME NOW TO MOVE IN FROM 12/05/2025! NB: The photos are of the Show Apartment.

- **Stunning Views - Top Floor Penthouse Apartment**
- **Two Double Bedrooms - Perfect for Shares or Families**
- **Modern Bathroom with Shower Risers**
- **Brand New Luxury Kitchen**
- **High Quality Appliances Included**
- **Built-In Storage**
- **Blinds Included**
- **Final Opportunity to Reserve Your New Apartment Today!**
- **Council Tax Band - B**
- **Residents Parking**

£1,400 Per month

Chairborough Road, HP12 3UL

Approximate Gross Internal Area = 651 sq ft / 60.5 sq m



CH
2.13 = Ceiling Height

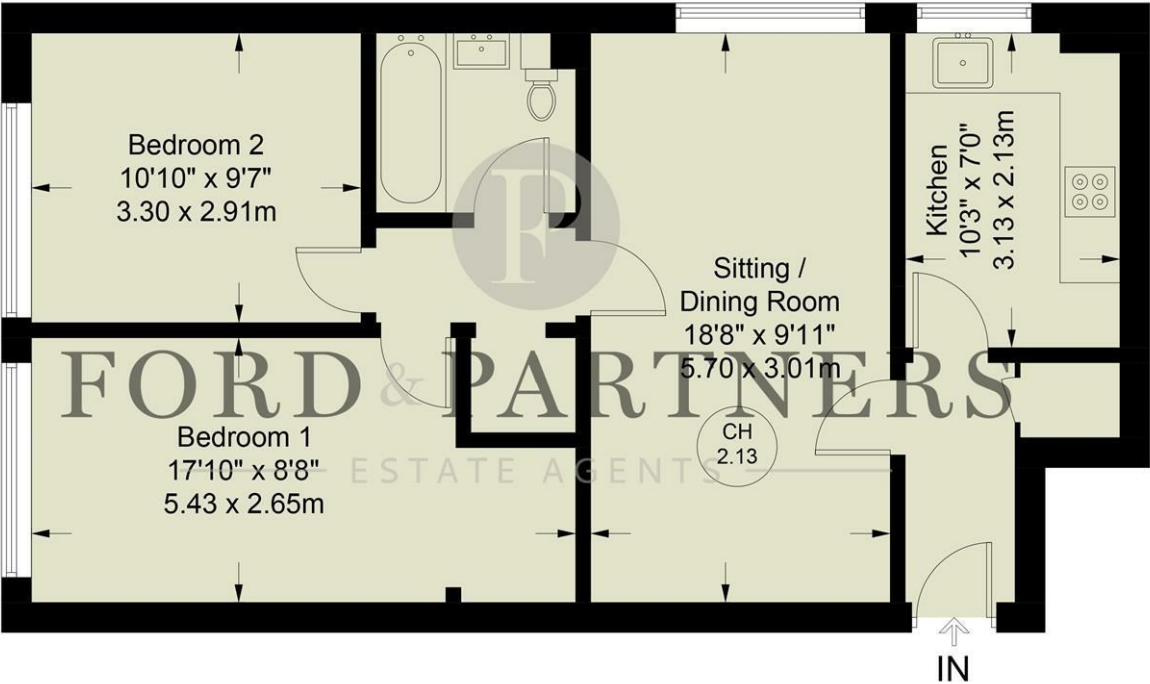

Floor Plan produced for Ford & Partners by Media Arcade ©.
Illustration for identification purposes only. Window and door openings are approximate. Whilst every attempt is made to assure accuracy in the preparation of this plan, please check all dimensions, shapes and compass bearings before making any decisions reliant upon them.

Energy Efficiency Rating		
	Current	Potential
Very energy efficient - lower running costs		
(92 plus) A		
(81-91) B		
(69-80) C		
(55-68) D		
(39-54) E		
(21-38) F		
(1-20) G		
Not energy efficient - higher running costs		
England & Wales	EU Directive 2002/91/EC	

Environmental Impact (CO ₂) Rating		
	Current	Potential
Very environmentally friendly - lower CO ₂ emissions		
(92 plus) A		
(81-91) B		
(69-80) C		
(55-68) D		
(39-54) E		
(21-38) F		
(1-20) G		
Not environmentally friendly - higher CO ₂ emissions		
England & Wales	EU Directive 2002/91/EC	

