



FORD & PARTNERS

— ESTATE AGENTS —



The Greenway High Wycombe HP13 6PZ



The Greenway High Wycombe HP13 6PZ

Guide price £200,000

A spacious two double bedroom top floor apartment situated off Amersham Hill. The Greenway is set in a convenient location with great access to the High Train Station & Town Centre.

Description

Sold with no onward chain, Greenway Court offers an ideal first time or investment purchase.

The property features a generously sized and bright living room, separate kitchen, two double bedrooms and a bathroom. The fitted kitchen has a built-in hob and oven and has space for a fridge freezer and washing machine.

Additional features include full double glazing, gas central heating and a single garage in the block ideal for storage.

Situation

Located on The Greenway, this property offers easy access to the Eden Shopping Centre, a wide selection of bars, pubs, and restaurants, as well as the mainline train station just a short walk away. The Chiltern Railway Service provides direct routes to London Marylebone in just 27 minutes and Oxford in 38 minutes. South Buckinghamshire is renowned for excellent state and independent schools, and High Wycombe has some of the best. All walkable from the property and in high demand, there's Wycombe Abbey, the Royal Grammar School, Wycombe High School, Godstowe and John Hampden.



Floor Plans

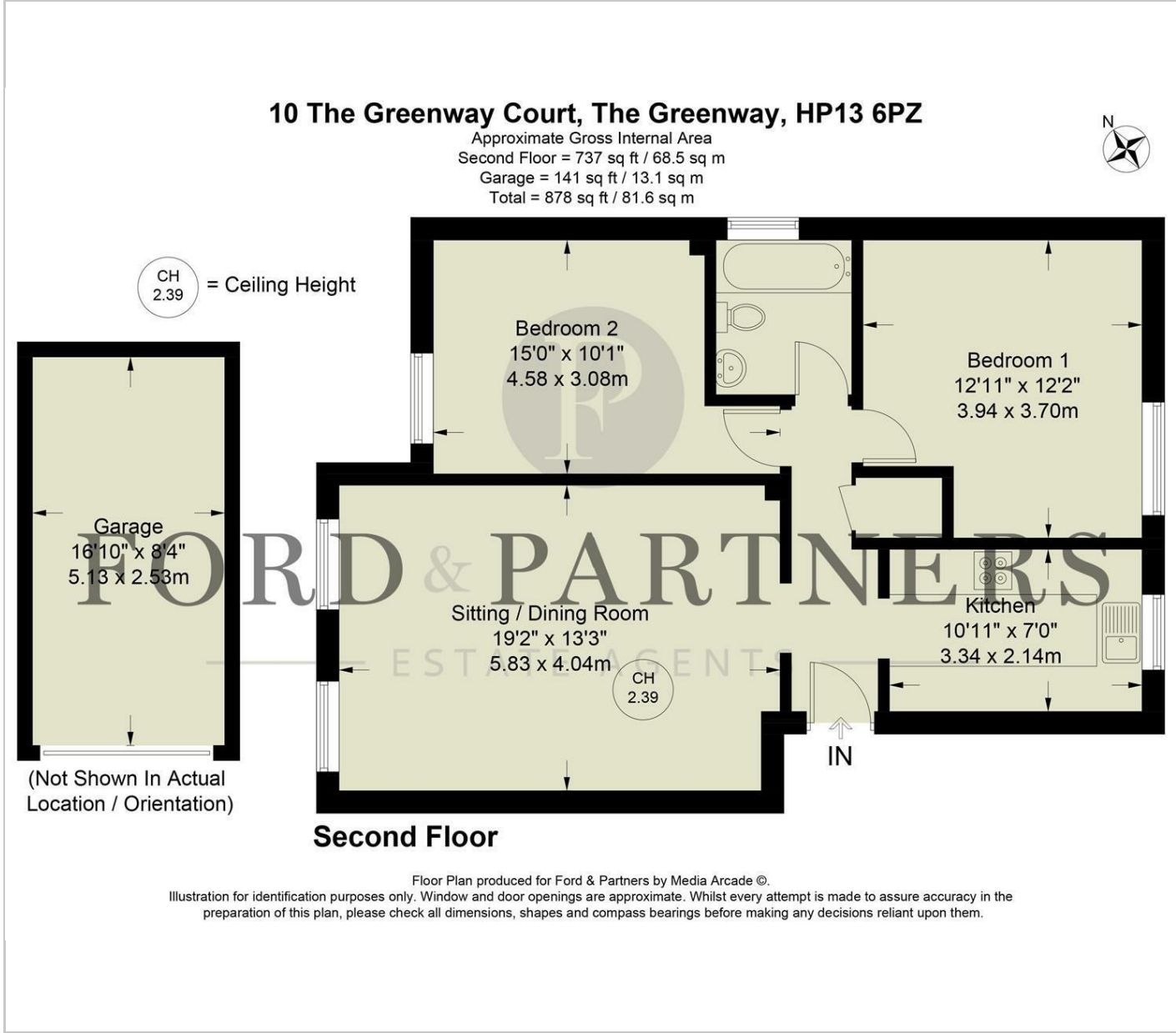

Area Map

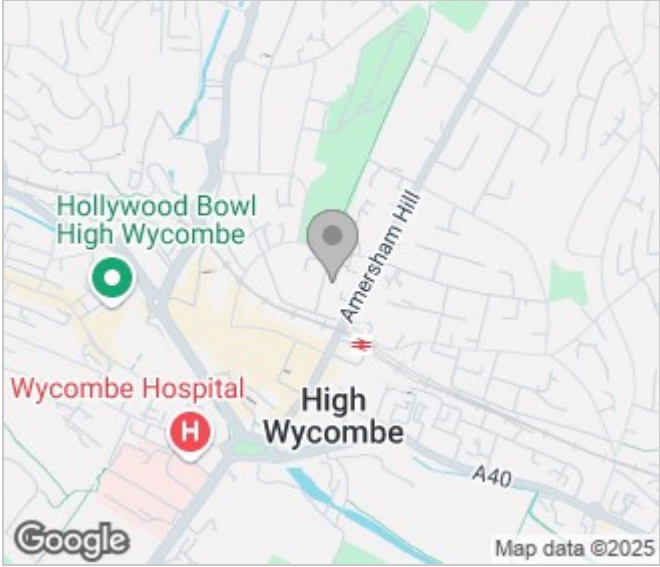

Energy Performance Graph

