



FORD & PARTNERS

ESTATE AGENTS

Leigh Street High Wycombe Buckinghamshire HP11 2WR



Leigh Street High Wycombe HP11 2WR

£260,000

A well presented top floor two double bedroom apartment situated in The Old Works development. This modern and bright apartment is offered with the added benefit of no onward chain.

Description

A superbly presented and bright top floor apartment situated to the West of High Wycombe's Town Centre. The Old Works complex was designed for modern living and converted in 2021 to offer modern city style apartments whilst capturing character charm. The high ceilings and tall windows allow for a bright and spacious feel throughout that is rare to find in modern developments.

The apartment consists of two double bedrooms, open plan kitchen/living area, spacious bathroom & en suite both finished to a high standard and a fully integrated kitchen area with modern appliances.

Additional features include a Wellness/ Gym area for residents, allocated undercroft gated parking, an elevator and a modern video intercom system.

Situation

Convenience is at your doorstep with the High Wycombe Bus Station a 10-minute walk away whilst the Train Station just a 15-minute walk away, offering regular services to Oxford (48 minutes) and London Marylebone (27 minutes). For Road users Junction 4 M40 is just under 2 miles away providing easy access to London & Oxford. Situated just off the Eden Shopping Centre, the property provides easy access to an array of amenities, including the Eden Shopping Centre, a cinema, bowling complex, and an abundance of retail shops and restaurants, all within walking distance.



Floor Plans

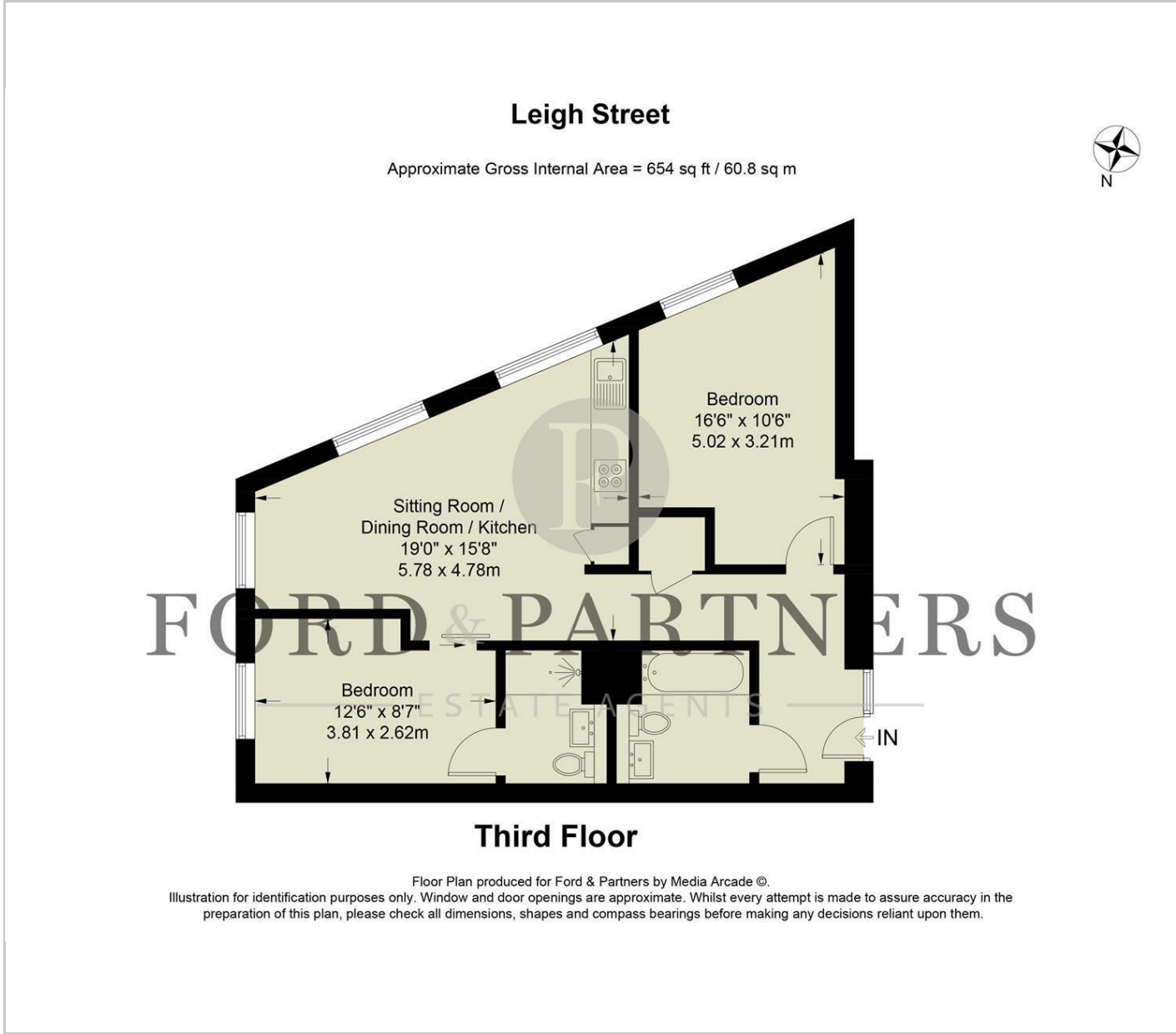

Area Map



Energy Performance Graph

