



FORD & PARTNERS

ESTATE AGENTS



Lily's Walk High Wycombe HP11 2FZ



Lily's Walk High Wycombe HP11 2FZ

Offers over £230,000

A spacious and modern one bedroom apartment situated in a popular newly constructed development in the town centre. This stylish apartment comes with the added benefit of no onward chain.

Description

The apartment itself consists of one double bedroom with fitted wardrobes, an open plan reception/kitchen with integrated appliances, a modern fitted bathroom and utility room.

This fine apartment also benefits from a balcony providing comfortable outside space and secure gated underground parking.

Further features include electric heating, double glazing, and a remainder of a LABC warranty (8 years).

Situation

Constructed in 2021, the development is conveniently located on Lily's Walk and has direct access to the town centre. The Eden Shopping Centre, High Wycombe Hospital, Bucks New University & the train station are all within easy reach of the apartment.



Floor Plans

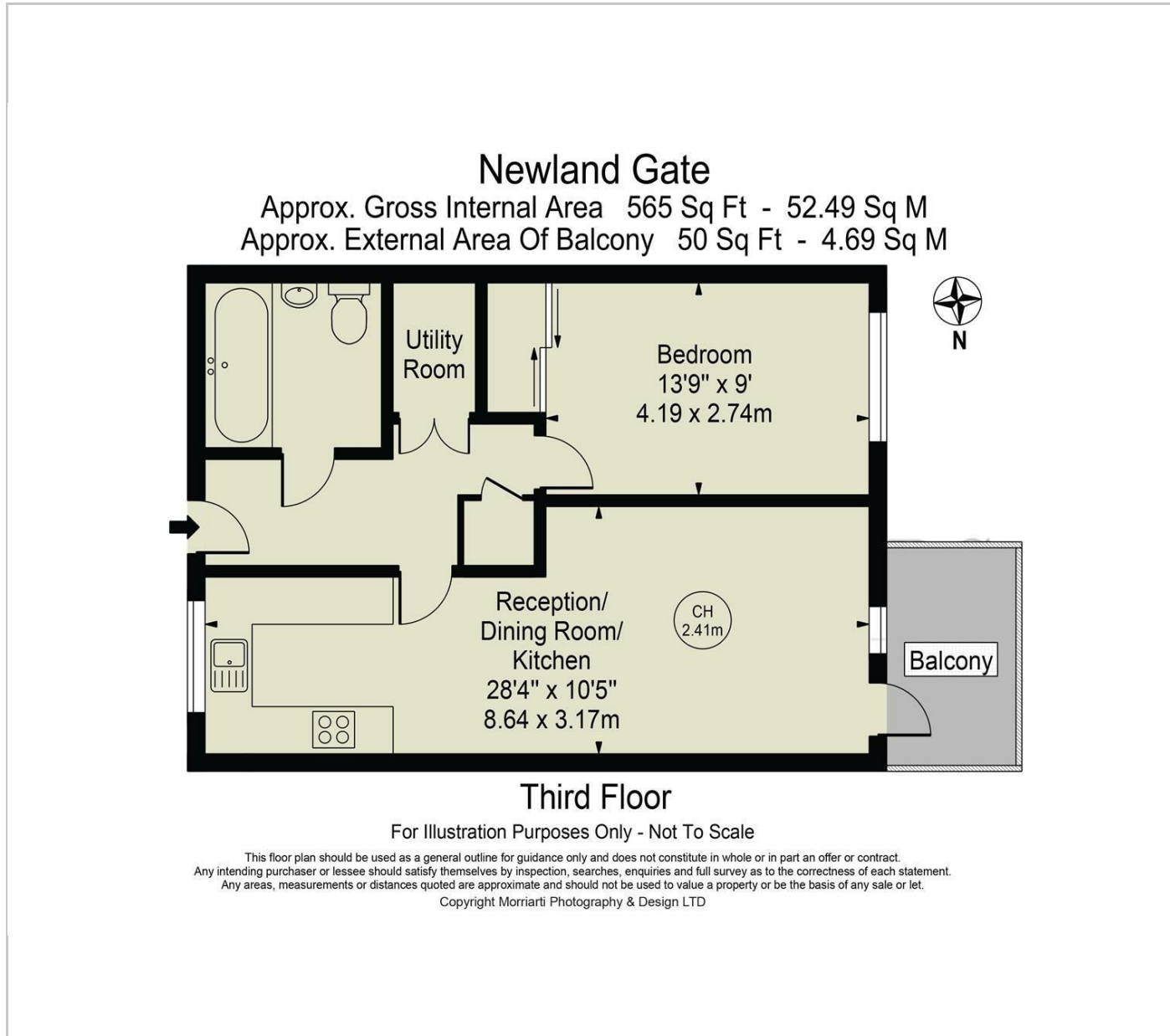

Area Map

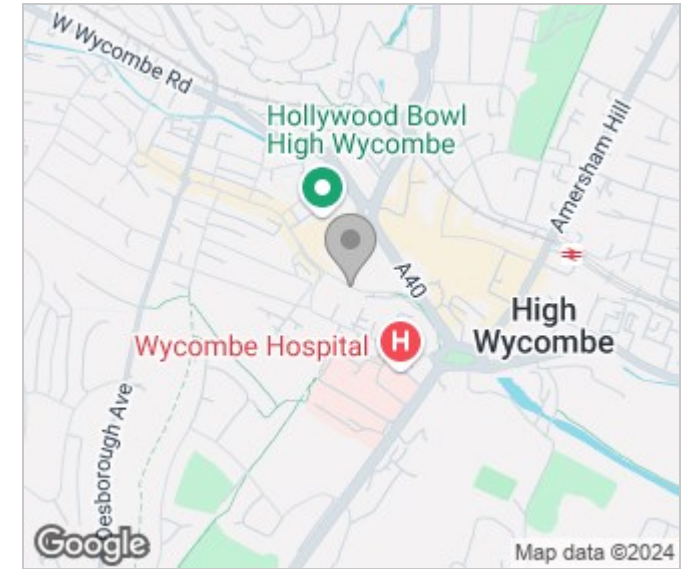

Energy Performance Graph

