



**FORD & PARTNERS**

ESTATE AGENTS



Lily's Walk High Wycombe HP11 2FZ



Lily's Walk High Wycombe HP11 2FZ

Asking price £235,000

A spacious and modern one bedroom apartment situated in a popular newly constructed development in the town centre. This stylish apartment comes with the added benefit of no onward chain.

## Description

The apartment itself consists of one double bedroom with fitted wardrobes, an open plan reception/kitchen with integrated appliances, a modern fitted bathroom and utility room.

This fine apartment also benefits from a balcony providing comfortable outside space and secure gated underground parking.

Further features include electric heating, double glazing, and a remainder of a LABC warranty (8 years).

## Situation

Constructed in 2021, the development is conveniently located on Lily's Walk and has direct access to the town centre. The Eden Shopping Centre, High Wycombe Hospital, Bucks New University & the train station are all within easy reach of the apartment.



Floor Plans

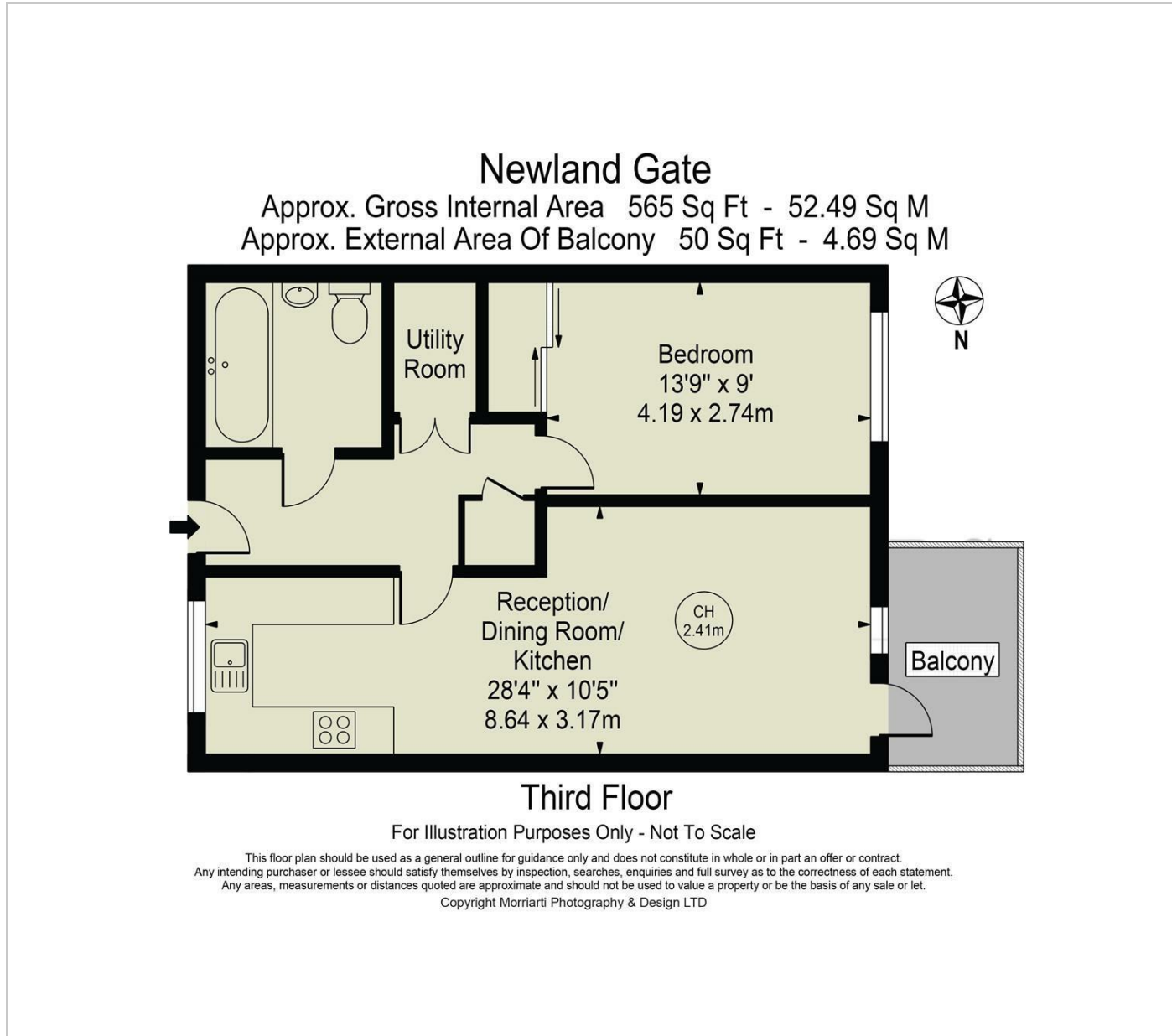

Area Map



Energy Performance Graph

