



FORD & PARTNERS

ESTATE AGENTS

35a Queens Road, High Wycombe, HP13 6AQ



35a Queens Road, High Wycombe, HP13 6AQ

Guide price £290,000

A recently redecorated two double bedroom, two-bathroom ground floor maisonette benefitting from a share of freehold and excellent commuting links.

Description

Situated within a short walking distance of the train station (0.5 miles) this two bedroom, two bathroom ground floor maisonette is an ideal first time purchase or investment.

This modern apartment features a separate kitchen, spacious living room and en suite off the principal bedroom. The bay windows allow for an open and bright feel throughout. The property further benefits from a generous lease with a share of the freehold, allocated parking, as well as a private patio area to the rear.

Situation

Queens Road is in a very popular and well-regarded location being only a stone's throw from the mainline train station (0.2 miles) making it ideal for commuting to London with direct trains to Marylebone taking just 27 minutes. Eden Shopping Centre (1 mile), The Rye Park (0.1 mile) and town centre (0.5 mile) are all within a short walking distance. The Rye Park covers an area of just over 53 acres and includes the Wycombe Rye Lido & Gym open all year round.



Floor Plans

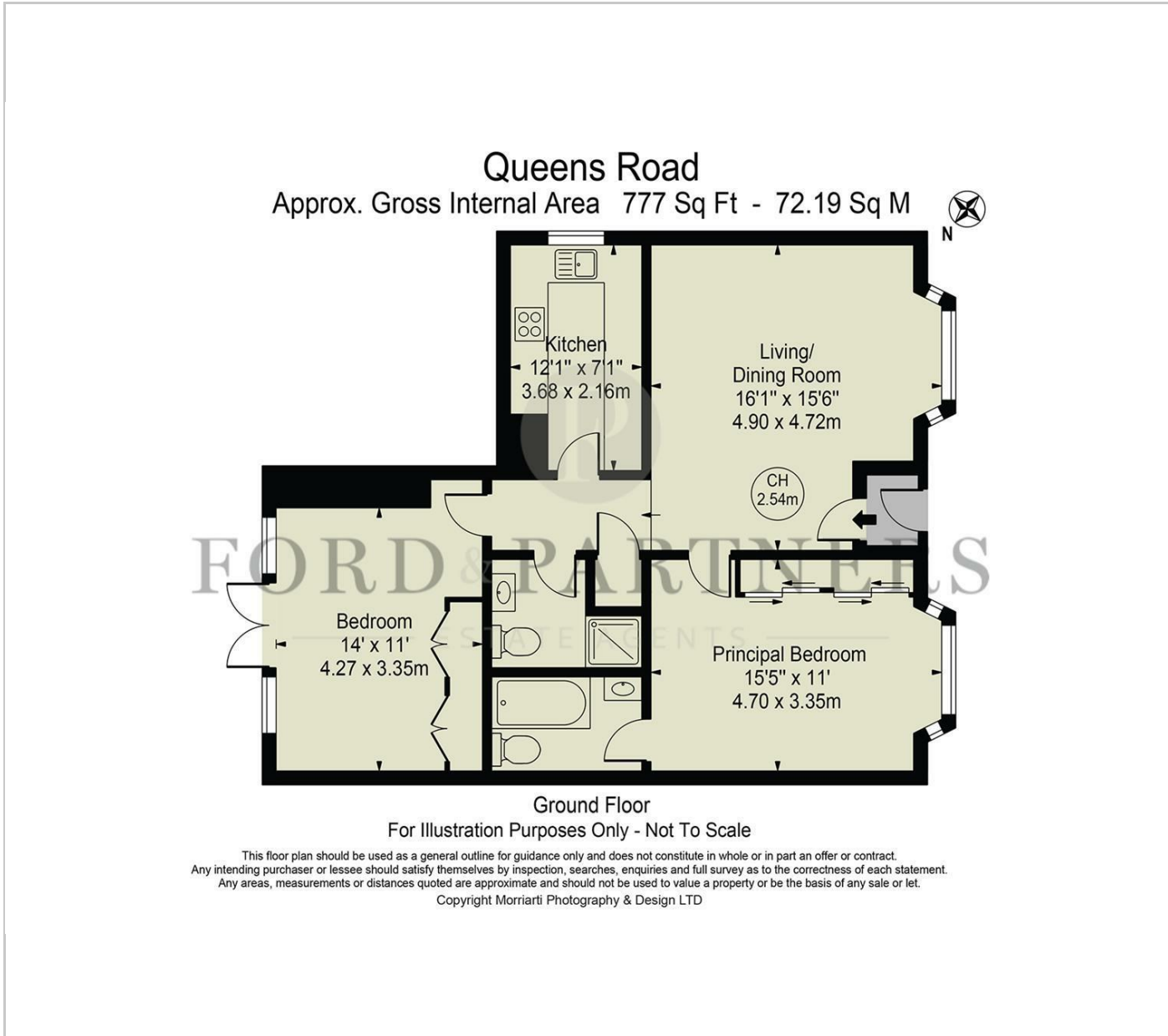

Area Map



Energy Performance Graph

