



FORD & PARTNERS

ESTATE AGENTS



3B Deané Avenue, Ruislip, HA4 6SP



3B Deane Avenue, Ruislip, HA4 6SP

Guide price £550,000

A spacious three bedroom mid-terrace home situated in the great location, just 0.2 miles from South Ruislip Train Station being offered to market with no onward chain.

Description



Situation



Floor Plans

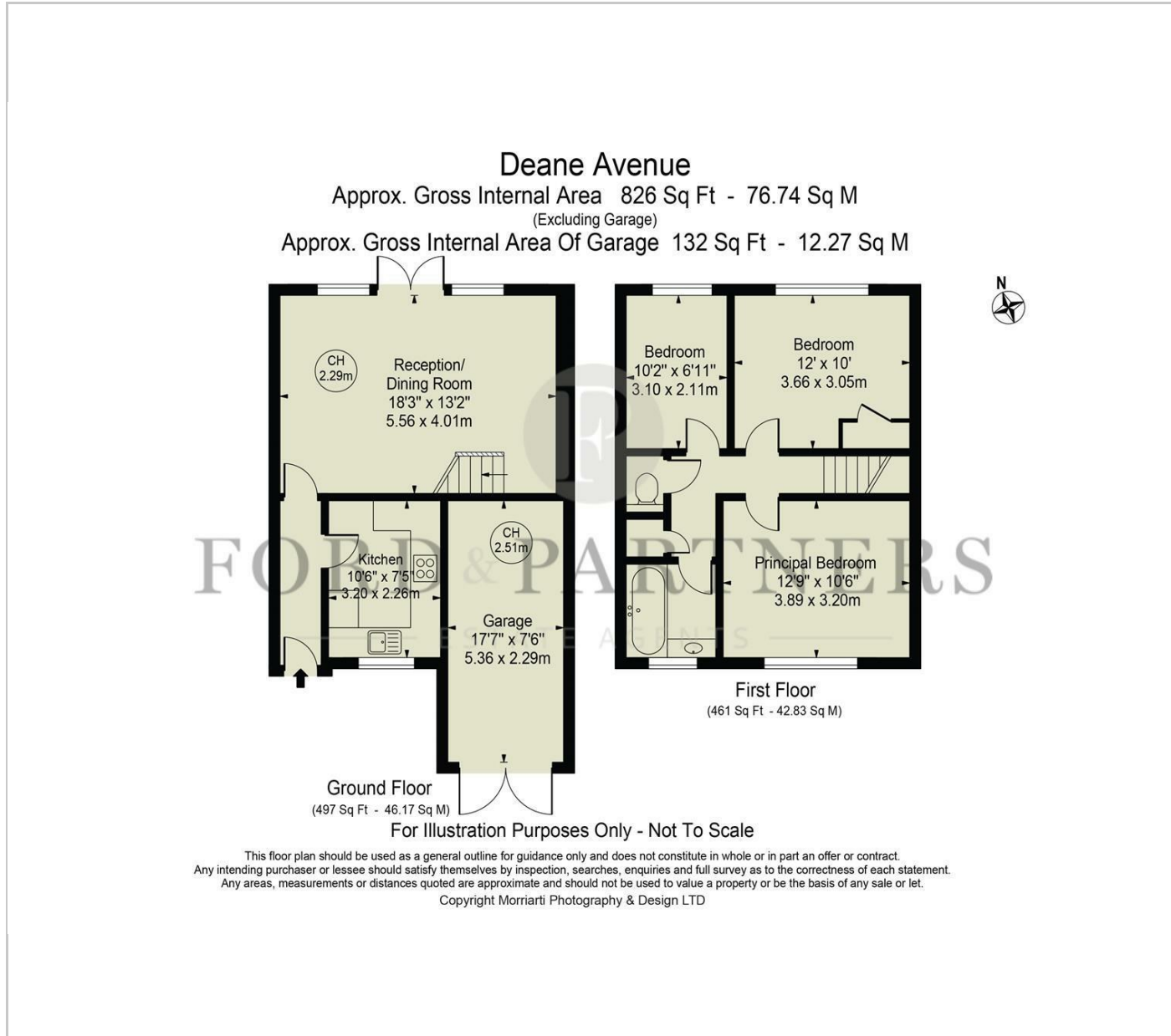

Area Map

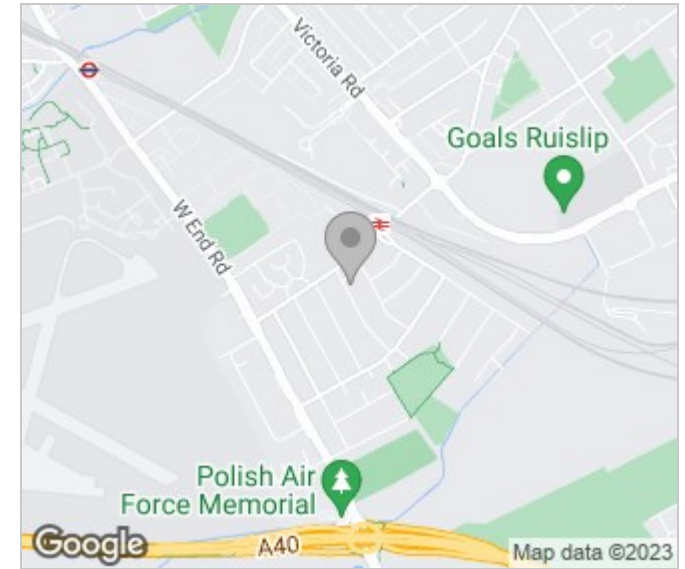

Energy Performance Graph

