



BLATCH  
FINE HOMES

Tel: +44 (0) 24 7624 9333

info@blatchfinehomes.co.uk



## Inversnaid The Windmill Hill

Allesley, Coventry, CV5 9FR

£870,000



4



2



3



D



# Inversnaid The Windmill Hill



## Description

OPEN DAY - Saturday 17th January. Please note, Open Day viewings will be by pre-booked time slots, allowing each guest a private viewing of the house, so please get in touch to secure your slot.

Set proudly along one of Coventry's most admired stretches, Inversnaid is the kind of home that makes people slow their cars, turn their heads, and smile. With its storybook façade, sweeping grounds, and interiors styled with impeccable taste, this four-bedroom residence is not just a property, it is a destination. A place of heart, heritage and rare charm, instantly recognisable and forever memorable.

- Sweeping gated driveway with extensive parking and landscaped frontage
- Spacious principal bedroom with elegant décor and abundant natural light
- Family bathroom with traditional claw-foot freestanding bathtub
- Sunlit terrace ideal for alfresco dining and entertaining
- EPC Rating: D
- Detached four-bedroom character home set on a generous plot backing onto open fields
- Large shaker-style kitchen with central island, integrated dining area and multiple garden viewpoints
- Expansive rear garden with lawn, mature planting and open countryside behind
- Highly regarded location with rural views yet convenient access to amenities
- Council tax band: E









## Floor Plan

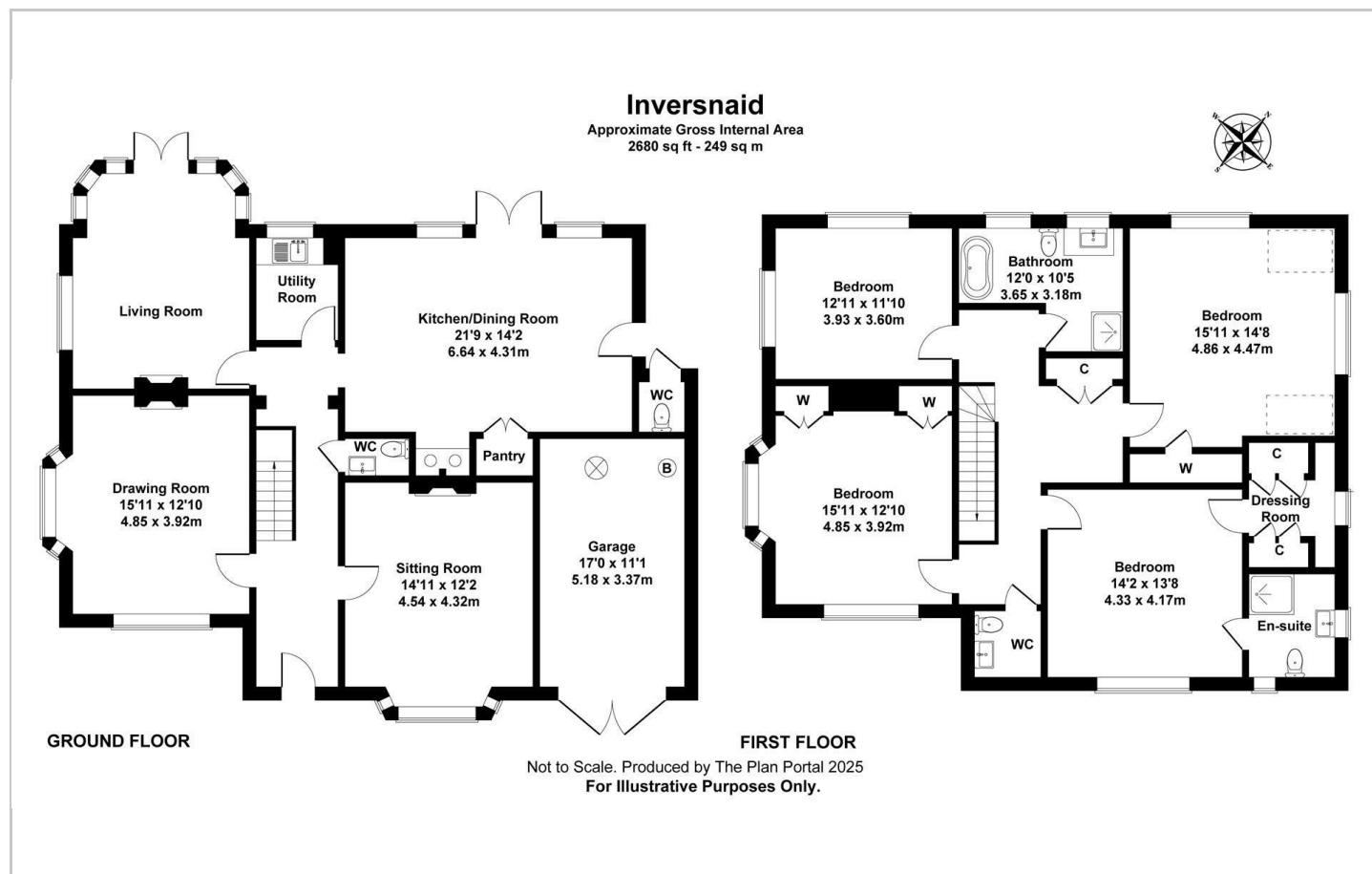

## Area Map

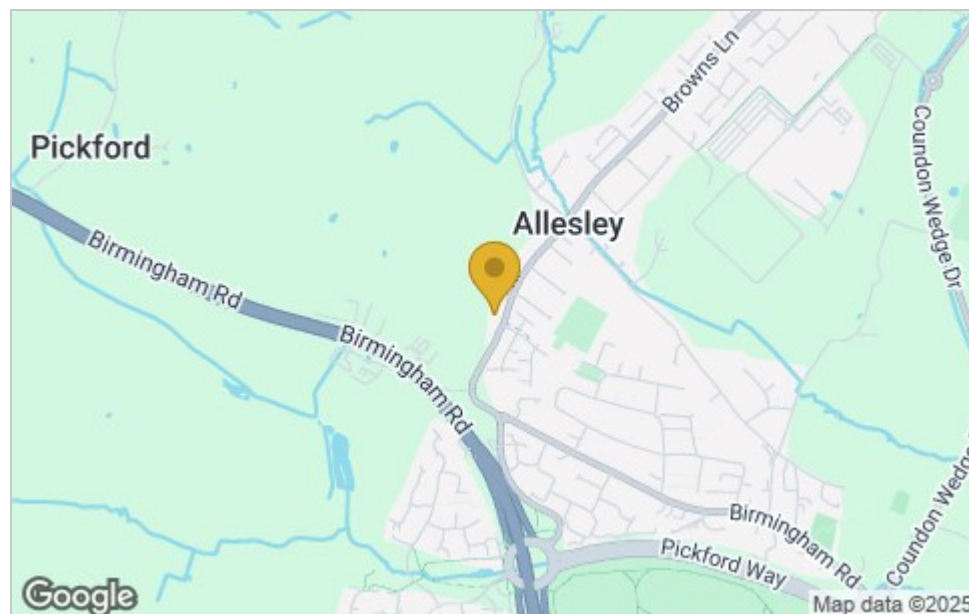

## Viewing

Please contact our Coventry Office  
on 02476249333 if you wish to arrange a viewing appointment for this property  
or require further information.

These particulars, whilst believed to be accurate are set out as a general outline only for guidance and do not constitute any part of an offer or contract. Intending purchasers should not rely on them as statements of representation of fact, but must satisfy themselves by inspection or otherwise as to their accuracy. No person in this firm's employment has the authority to make or give any representation or warranty in respect of the property.

## Energy Efficiency Graph

