



BLATCH

FINE HOMES

Tel: +44 (0) 24 7624 9333

info@blatchfinehomes.co.uk



6 Arkwright Avenue

Rugby, CV23 0FR

Offers over £550,000



4



2



1



B

6 Arkwright Avenue



Description

A tastefully decorated and deceptively spacious family home located on the exclusive Coton House Estate development in Churchover, Rugby.

Approached via a tree lined driveway and surrounded by a green outlook the home offers spacious accommodation and generous gardens.

- Exclusive Cala Homes Development
- Generous Garden
- Well Proportioned Bedrooms
- Garage
- EPC Rating B
- Four Bedroom Family Home
- Kitchen / Living/ Dining Area
- Spacious Lounge
- Council Tax Band F





Floor Plan

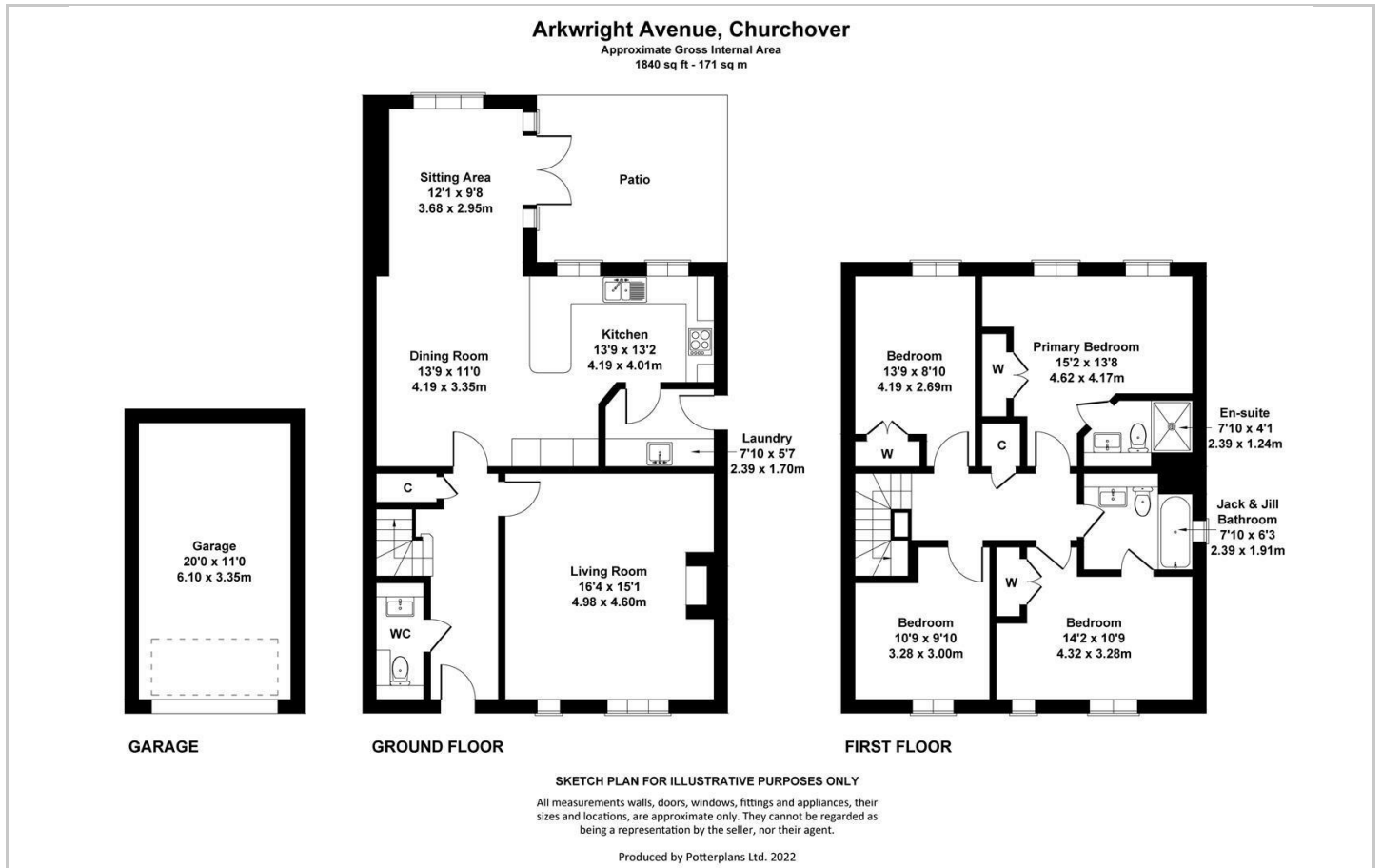

Area Map

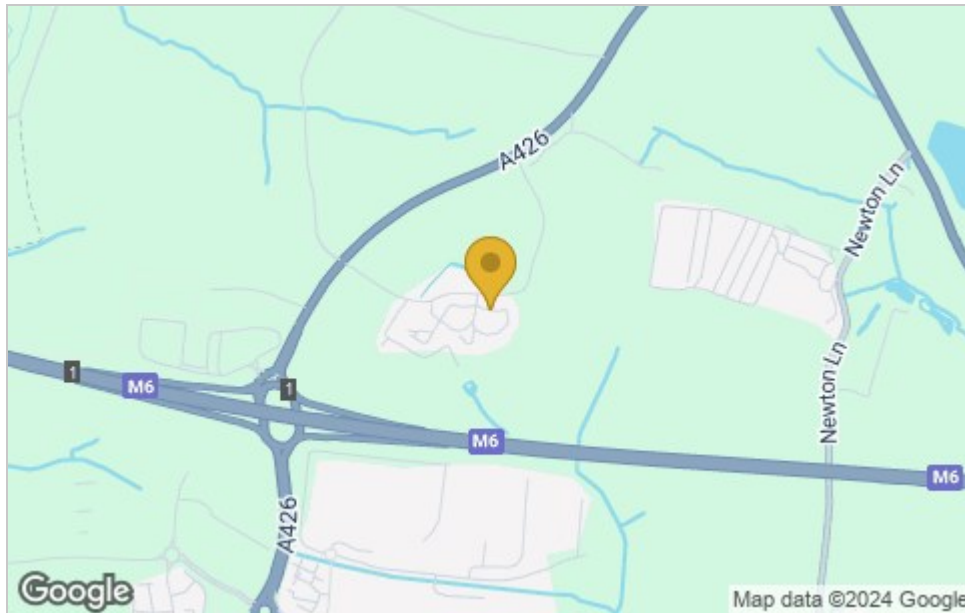

Viewing

Please contact our Coventry Office on 02476249333 if you wish to arrange a viewing appointment for this property or require further information.

These particulars, whilst believed to be accurate are set out as a general outline only for guidance and do not constitute any part of an offer or contract. Intending purchasers should not rely on them as statements of representation of fact, but must satisfy themselves by inspection or otherwise as to their accuracy. No person in this firm's employment has the authority to make or give any representation or warranty in respect of the property.

Energy Efficiency Graph

