



BLATCH

FINE HOMES

Tel: +44 (0) 24 7624 9333

info@blatchfinehomes.co.uk



Quarry House Nuneaton Road

Coleshill, Birmingham, B46 2NH

Offers over £875,000



Quarry House Nuneaton Road



Description

Quarry House is an imposing four bedroom country home situated in the village of Over Whitacre within the North Warwickshire countryside. The property is a Grade II Listed building dating back to c1840 and boasts character and charm throughout.

- Grade II Listed Country Home c 1840
- Character and Charm
- Sweeping gated Driveway
- Countryside Views
- Council Tax Band F
- Beautifully Renovated
- Approx 1 Acre Plot
- Approx 2800 sq ft
- Idyllic Setting





Floor Plan

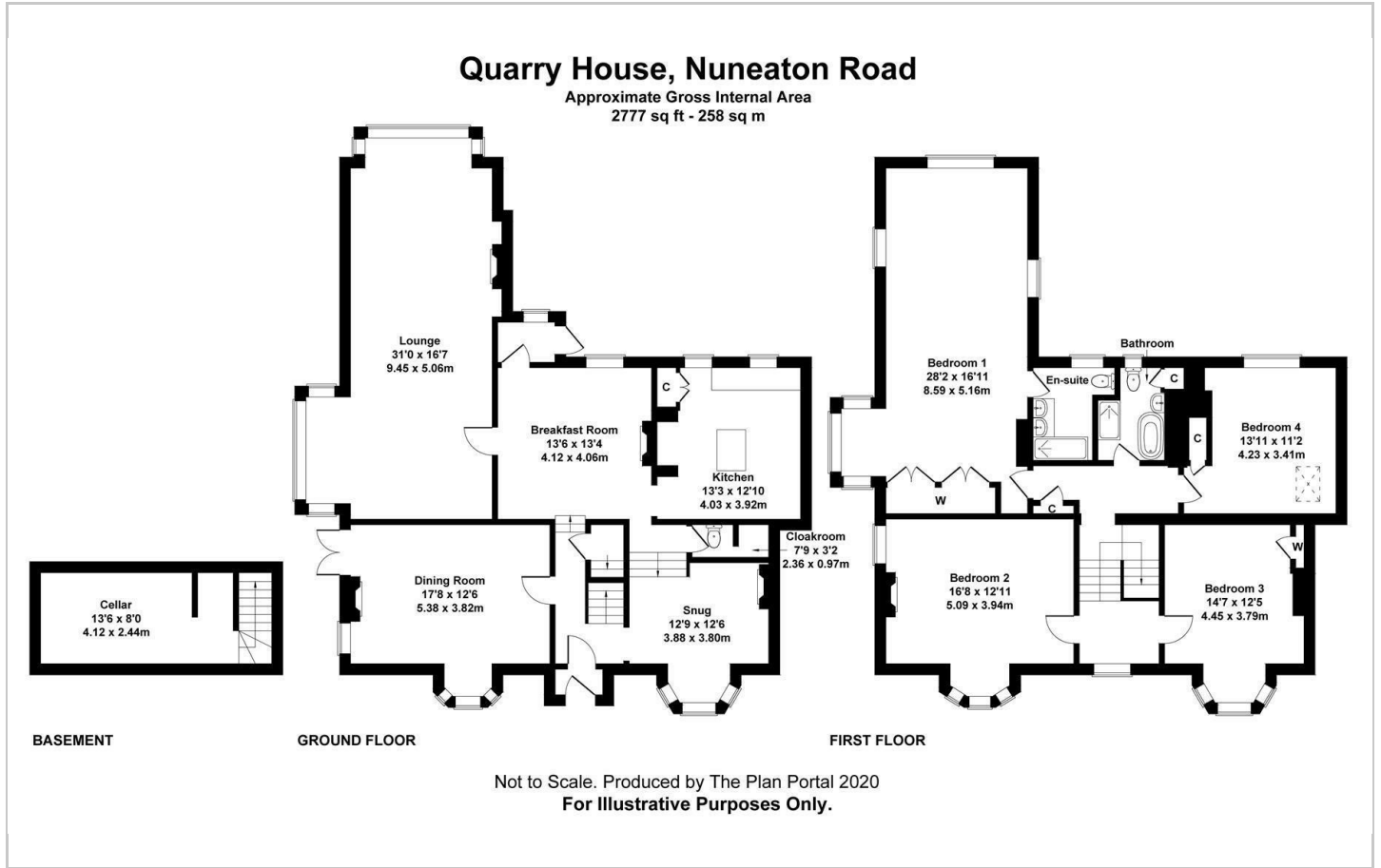

Area Map

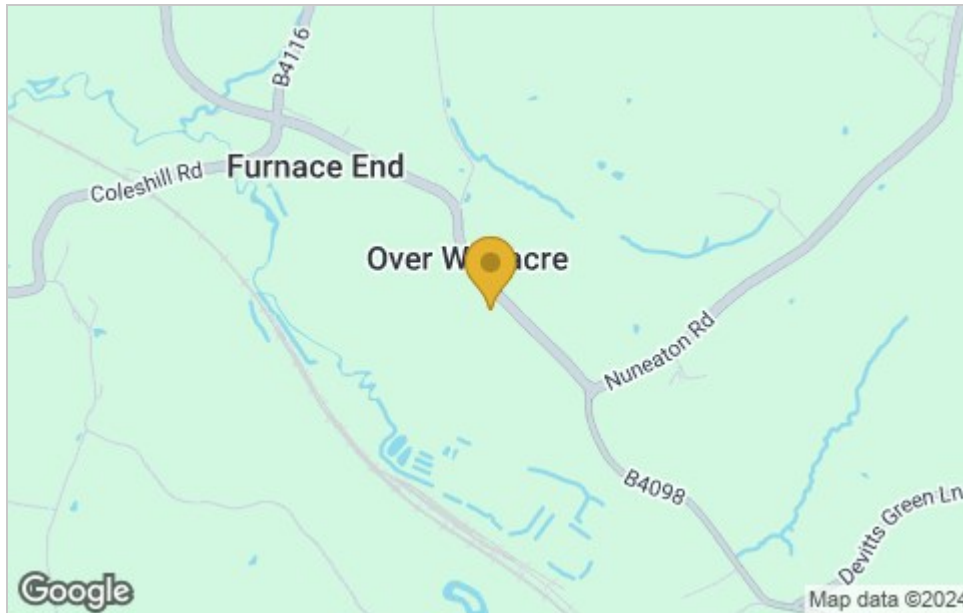

Viewing

Please contact our Coventry Office on 02476249333 if you wish to arrange a viewing appointment for this property or require further information.

These particulars, whilst believed to be accurate are set out as a general outline only for guidance and do not constitute any part of an offer or contract. Intending purchasers should not rely on them as statements of representation of fact, but must satisfy themselves by inspection or otherwise as to their accuracy. No person in this firm's employment has the authority to make or give any representation or warranty in respect of the property.

Energy Efficiency Graph

