



SOUL ESTATES

SALES & LETTINGS

TO LET - 3 Bedroom Flat

Dudley Port, Tipton, DY4

£900 PCM

Soul Estates are proud to present this well-presented 3-bedroom First Floor Flat To Let. This perfect family home is situated in a very popular area of Tipton. Situated near Dudley Port Train Station with good schools, local amenities and transport links and close to Great Bridge Asda and Burnt Tree Island Tesco.

The property offers an entrance hallway with rooms going off to the lounge, family kitchen, three bedrooms and a family bathroom. Kitchen with a range of wall and base units to match, splashback tiling, gas hob with an electric oven. The property also benefits from gas central heating and double glazing.

✓ **3 BEDROOM FIRST FLOOR FLAT**

✓ **LOUNGE**

✓ **SEPARATE KITCHEN**

✓ **NEAR DUDLEY PORT TRAIN STATION**



WWW.SOULESTATES.CO.UK | 0121 647 6779







SOUL ESTATES

SALES & LETTINGS

TO LET - 3 Bedroom Flat

Dudley Port, Tipton, DY4

First Floor

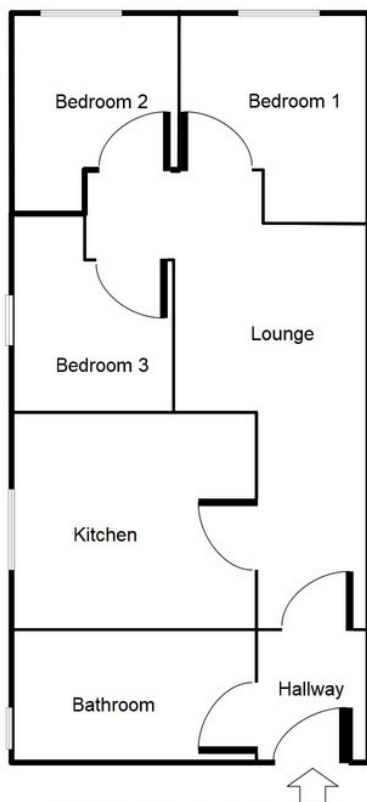

This floorplan is just an example, this is not to scale.
Please see description for exact room sizes.
(c) Soul Estates

Entrance Hall

5' 4" x 4' 2" (1.62m x 1.27m)

Lounge

12' 0" x 8' 4" (3.65m x 2.54m)

Kitchen

8' 9" x 7' 9" (2.66m x 2.36m)

Bedroom 1

14' 0" x 8' 3" (4.26m x 2.51m)

Bedroom 2

13' 11" x 7' 11" (4.24m x 2.41m)

Bedroom 3

12' 0" x 7' 11" (3.65m x 2.41m)

Family Bathroom

5' 4" x 7' 9" (1.62m x 2.36m)



SOUL ESTATES

SALES & LETTINGS

CONTACT US

Soul Estates
20 Great Bridge
Tipton
DY4 7HA

0121 647 6779

www.soulestates.co.uk

WWW.SOULESTATES.CO.UK | 0121 647 6779