



SOUL ESTATES

SALES & LETTINGS

TO LET - 3 Bedroom House

Broadmeadow Close, Willenhall, WV12

£1,100 PCM

Soul Estates are proud to present this well-presented 3-bedroom semi-detached house To Let. This perfect family home is situated in a very popular area of Willenhall. Situated close to all local amenities & public transport with good schools.

The property offers an entrance porchway leading into a spacious lounge, family kitchen and large conservatory to the side. Kitchen with a range of wall and base units to match, splashback tiling, gas hob with an electric oven.

Stairs leading to the first-floor landing, which leads off to three bedrooms and a family bathroom with a separate WC. The property also benefits from gas central heating and double glazing, a large rear garden with off-road parking to the front

✓ **3 BEDROOM SEMI-DETACHED HOUSE**

✓ **CONSERVATORY**

✓ **SPACIOUS LOUNGE**

✓ **LARGE REAR GARDEN**









SOUL ESTATES

SALES & LETTINGS

TO LET - 3 Bedroom House

Broadmeadow Close, Willenhall, WV12

Ground Floor

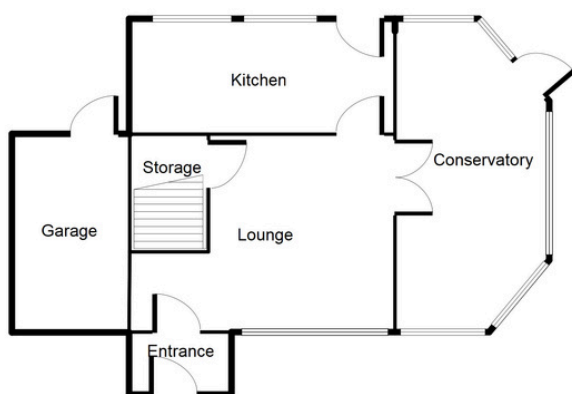

This floorplan is just an example, this is not to scale.
Please see description for exact room sizes.
(c) Soul Estates

First Floor

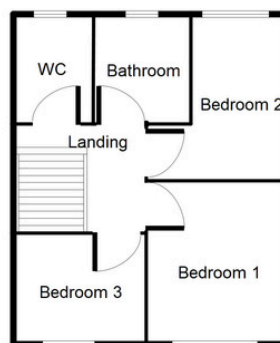

This floorplan is just an example, this is not to scale.
Please see description for exact room sizes.
(c) Soul Estates

Entrance Porch

3' 1" x 4' 10" (0.94m x 1.47m)

Lounge

16' 7" x 14' 4" (5.05m x 4.37m)

Kitchen

8' 1" x 14' 4" (2.46m x 4.37m)

Conservatory

22' 11" x 12' 7" (6.98m x 3.83m)

First Floor Landing

9' 3" x 5' 8" (2.82m x 1.73m)

Bedroom 1

12' 8" x 8' 5" (3.86m x 2.56m)

Bedroom 2

11' 1" x 6' 4" (3.38m x 1.93m)

Bedroom 3

9' 7" x 5' 8" (2.92m x 1.73m)

Bathroom

5' 6" x 4' 10" (1.68m x 1.47m)

WC

5' 6" x 2' 9" (1.68m x 0.84m)



SOUL ESTATES

SALES & LETTINGS

CONTACT US

Soul Estates
20 Great Bridge
Tipton
DY4 7HA

0121 647 6779

www.soulestates.co.uk

WWW.SOULESTATES.CO.UK | 0121 647 6779