



SOUL ESTATES

SALES & LETTINGS

TO LET - 3 Bedroom House

Wheelwright close, Wednesbury, WS10

£1,200 PCM

Soul Estates are proud to present this well-presented 3-bedroom semi-detached house To Let. This perfect family home is situated in a very popular area of Wednesbury. Situated near Darlaston ASDA with good schools, local amenities and transport links and close to Wolverhampton and Walsall.

The property offers an entrance hall with rooms going off to the downstairs W.C, a spacious lounge and a family kitchen with a separate dining room. Kitchen with a range of wall and base units to match, splashback tiling, gas hob with an electric oven.

Stairs leading to the first-floor landing, which leads off to three bedrooms, a family bathroom and a storage cupboard. The property also benefits from gas central heating and double glazing, low maintenance front and rear garden with off-road parking and a garage.

✓ **3 BEDROOM SEMI-DETACHED HOUSE**

✓ **NEW REFURBISHED FAMILY HOME**

✓ **KITCHEN & SEPARATE DINING ROOM**

✓ **DRIVEWAY & GARAGE**









SOUL ESTATES

SALES & LETTINGS

TO LET - 3 Bedroom House

Wheelwright Close, Wednesbury, WS10

Ground Floor

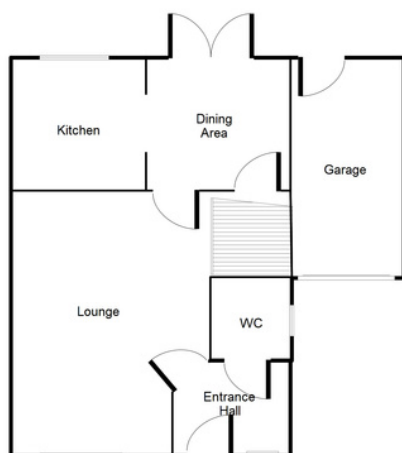

This floorplan is just an example this is not to scale.
Please see description for exact room sizes.
(c) Soul Estates

First Floor

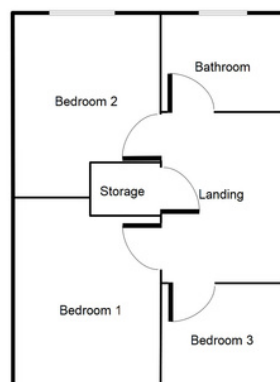

This floorplan is just an example this is not to scale.
Please see description for exact room sizes.
(c) Soul Estates

Entrance Hall

3' 10" x 6' 6" (1.17m x 1.98m)

W.C

4' 7" x 4' 0" (1.40m x 1.22m)

Lounge

16' 3" x 11' 10" (4.95m x 3.60m)

Dining Area

9' 0" x 7' 5" (2.74m x 2.26m)

Kitchen

9' 0" x 6' 11" (2.74m x 2.11m)

Landing

9' 0" x 6' 4" (2.74m x 1.93m)

Bedroom 1

14' 0" x 8' 0" (4.26m x 2.44m)

Bedroom 2

11' 3" x 8' 0" (3.43m x 2.44m)

Bedroom 3

9' 0" x 6' 4" (2.74m x 1.93m)

Family Bathroom

6' 2" x 6' 4" (1.88m x 1.93m)



SOUL ESTATES

SALES & LETTINGS

CONTACT US

Soul Estates
20 Great Bridge
Tipton
DY4 7HA

0121 647 6779

www.soulestates.co.uk

WWW.SOULESTATES.CO.UK | 0121 647 6779