



SOUL ESTATES

SALES & LETTINGS

TO LET - 3 BEDROOM HOUSE

Roway Lane, Oldbury, B69 3EQ

£1,200 PCM

Soul Estates are proud to present this well-presented 3-bedroom semi-detached house To Let. This perfect family home is situated in a very popular area of Oldbury. Situated 1/4 mile of Oldbury Town Centre which offers excellent shopping facilities with good schools, also good motorway links into Birmingham, Wolverhampton and Dudley also close to Sandwell & Dudley Train Station.

The property offers an entrance porchway leading into the spacious 25ft family lounge, family kitchen with island and dining area. Kitchen with a range of wall and base units to match, splashback tiling, range gas cooker and Oven.

Stairs leading to the first-floor landing which leads off to, three bedrooms and a family shower room. The property also benefits gas central heating and double glazing, low maintenance front and rear garden with off-road parking.

✓ **3 BEDROOM SEMI-DETACHED HOUSE**

✓ **SPACIOUS LOUNGE**

✓ **LARGE FAMILY KITCHEN DINING AREA**

✓ **CLOSE TO OLDBURY TOWN CENTRE**









SOUL ESTATES

SALES & LETTINGS

TO LET - 3 BEDROOM HOUSE

Roway Lane, Oldbury, B69 3EQ

£1,200 PCM

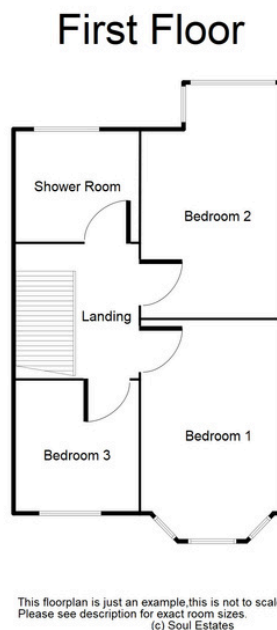
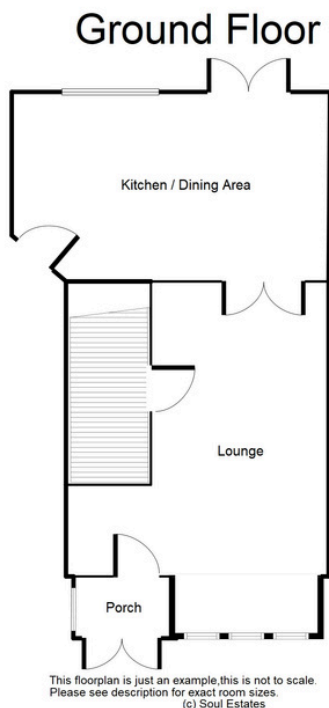

Lounge:

25' 7" x 13' 3" (7.79m x 4.04m)

Kitchen / Diner:

13' 7" x 16' 5" (4.14m x 5.00m)

First Floor Landing:

5' 8" x 5' 8" (1.73m x 1.73m)

Bedroom 1:

13' 7" x 9' 1" (4.14m x 2.77m)

Bedroom 2:

12' 0" x 10' 1" (3.65m x 3.07m)

Bedroom 3:

8' 0" x 6' 10" (2.44m x 2.08m)

Shower Room:

6' 7" x 5' 7" (2.01m x 1.70m)



SOUL ESTATES

SALES & LETTINGS

CONTACT US

Soul Estates
20 Great Bridge
Tipton
DY4 7HA

0121 647 6779

www.soulestates.co.uk

WWW.SOULESTATES.CO.UK | 0121 647 6779