



# SOUL ESTATES

## SALES & LETTINGS

### TO LET - 2 BEDROOM APARTMENT

**Thunderbolt Way, Tipton, DY4 9SG**

**£850 PCM**

Soul Estates are proud to present this well-presented 2-bedroom First-Floor apartment To Let. This apartment is situated in a very popular area of Tipton. Situated near Mad O'Rourke's Pie Factory with good schools, local amenities, and transport links between Wolverhampton and Birmingham

The property offers an entrance hallway with rooms going off to two bedrooms, a spacious lounge, a fitted kitchen, and a family shower room. Kitchen with a range of wall and base units to match, splashback tiling with a gas hob and electric oven. The property also benefits from double glazing, gas central heating and allocated off-road parking.

✓ **2 BEDROOM FIRST FLOOR APARTMENT**

✓ **SPACIOUS LOUNGE**

✓ **FAMILY SHOWER ROOM**

✓ **ALLOCATED PARKING**









# SOUL ESTATES

## SALES & LETTINGS

### TO LET - 2 BEDROOM FLAT

Thunderbolt Way, Tipton, DY4 9SG

£850 PCM

#### First Floor

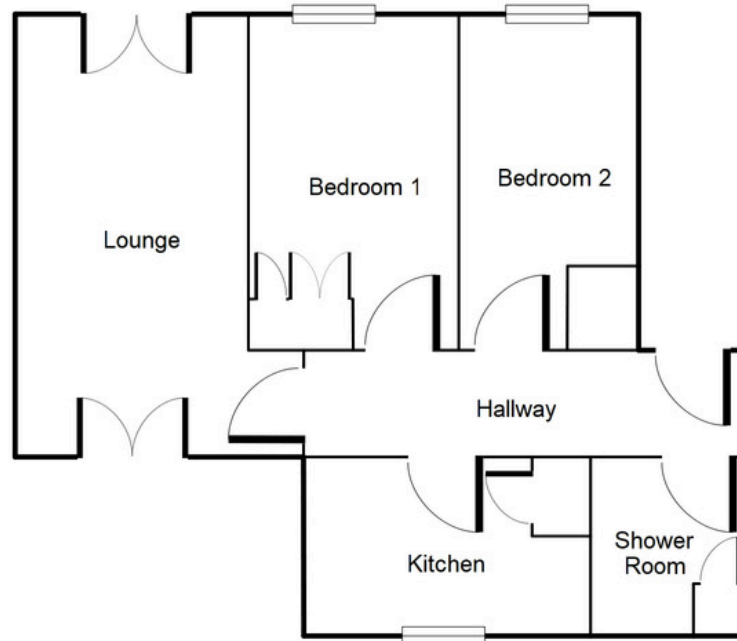

This floorplan is just an example, this is not to scale.  
Please see description for exact room sizes.  
(c) Soul Estates

#### Entrance Hall

17' 11" x 3' 6" (5.46m x 1.07m)

#### Lounge

10' 5" x 17' 10" (3.17m x 5.43m)

#### Kitchen

10' 10" x 7' 6" (3.30m x 2.28m)

#### Bedroom 1

8' 10" x 12' 8" (2.69m x 3.86m)

#### Bedroom 2

6' 7" x 12' 8" (2.01m x 3.86m)

#### Shower Room

5' 8" x 7' 6" (1.73m x 2.28m)



SOUL ESTATES  
SALES & LETTINGS

## CONTACT US

Soul Estates  
20 Great Bridge  
Tipton  
DY4 7HA

0121 647 6779

[www.soulestates.co.uk](http://www.soulestates.co.uk)

WWW.SOULESTATES.CO.UK | 0121 647 6779