



SOUL ESTATES

SALES & LETTINGS

TO LET - 2 BEDROOM HOUSE

Hill Road, Oldbury, B69 2LN

£950 PCM

Soul Estates are proud to present this lovely modern two-bedroom terraced house TO LET situated in the popular area of Tividale / Oldbury. The property is conveniently located a short distance away from local shops and amenities. The large Tesco superstore is only 0.6miles away and the main Castlegate complex only 1mile away. The property has good and outstanding schools nearby and also has good travel links.

The property offers an entrance hallway leading into a large lounge and a beautiful modern breakfast kitchen. Kitchen with a range of wall and base units to match, splashback tiling.

On the first floor two double bedrooms, and a family bathroom, the property also benefits from landscaped low maintenance rear garden with a decking area, and off-road parking.

✓ **MODERN TWO-BEDROOM**

✓ **MODERN FAMILY BREAKFAST KITCHEN**

✓ **RECEPTION/LOUNGE**

✓ **LANDSCAPED FRONT & REAR GARDENS**









SOUL ESTATES

SALES & LETTINGS

TO LET - 2 BEDROOM HOUSE

Hill Road, Oldbury, B69 2LN

£950 PCM

Ground Floor

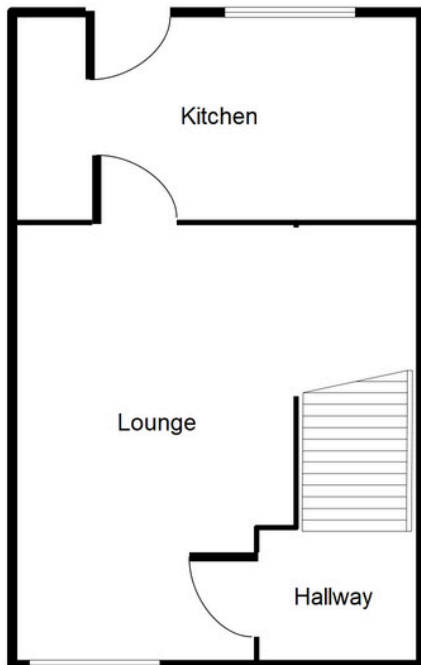

This floorplan is just an example, is not to scale.
Please see description for exact room sizes.
(c) Soul Estates

First floor

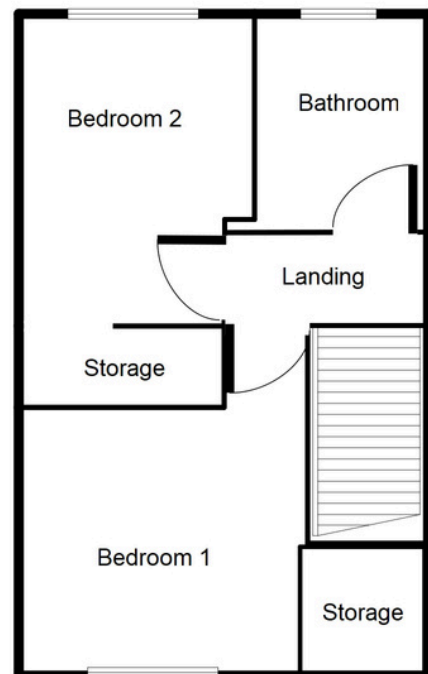

This floorplan is just an example, is not to scale.
Please see description for exact room sizes.
(c) Soul Estates

Lounge:

16' 8" x 11' 10" (5.076m x 3.617m)

Breakfast Kitchen:

11' 10" x 7' 11" (3.614m x 2.407m)

Bedroom 1:

11' 7" x 8' 10" (3.522m x 2.682m)

Bedroom 2:

10' 10" x 6' 9" (3.293m x 2.046m)

Bathroom:

7' 11" x 4' 10" (2.41m x 1.47m)