

CARDIFF'S HOME FOR
STYLISH SALES
& LETTINGS

JeffreyRoss



NEWPORT ROAD
ROATH

Newport Road

ROATH, CF24 1AH - £1,200 PCM

2 bedroom(s) 2 bathroom(s) sq ft

Located on the ground-floor of this impressive selection of converted apartments and within a short stroll of our fine City Centre and perfectly located for all university campuses is this very spacious and very nicely presented two bedroom, ground-floor apartment that offers TWO BATHROOMS and offers its own private entrance and courtyard! With an impressive open-plan kitchen / lounge and from being nicely furnished form top-to-bottom, the property is a great option for a couple of two friends. Benefiting from gas central heating, great quality furniture and an excellent standard throughout, the property comes equipped with two bedrooms and TWO BATHROOMS - perfect for those who like their own space. A really good property, we must say.

EPC RATING of C

A holding fee of one weeks' rent will be payable to secure the dwelling. This will be deducted from the final balance payable upon moving into the dwelling, subject to a successful application. Jeffrey Ross Limited reserves the right to retain this payment should the applicant have provided false or misleading information at the time of applying for the dwelling or failed to take reasonable steps to enter into the Standard Occupation Contract.



Newport Road, Roath

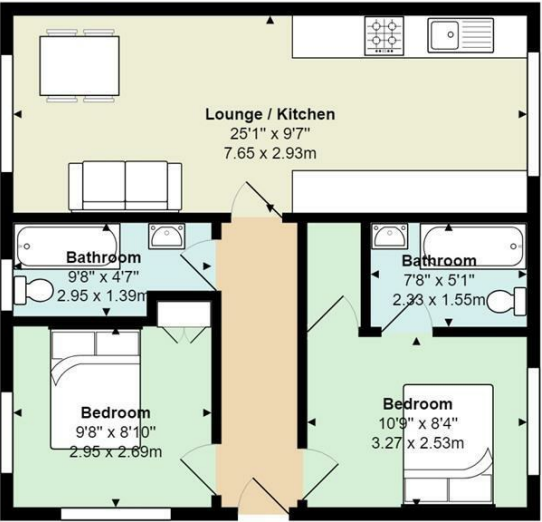

Total Area: 602 ft² ... 55.9 m²
All measurements are approximate and for display purposes only

PROPERTY SPECIALIST

Miss Lauren King

lauren.king@jeffreycross.co.uk
02920499680

Lettings Negotiator



Energy Efficiency Rating		
	Current	Potential
Very energy efficient - lower running costs		
(92 plus) A		
(81-91) B		
(69-80) C	72	77
(55-68) D		
(39-54) E		
(21-38) F		
(1-20) G		
Not energy efficient - higher running costs		
England & Wales	EU Directive 2002/91/EC	