

CARDIFF'S HOME FOR  
STYLISH SALES  
& LETTINGS

JeffreyRoss



NEWPORT ROAD  
ROATH

# Newport Road

ROATH, CF24 1AH - £860 PCM PCM

1 bedroom(s) 1 bathroom(s) sq ft

TAKE A LOOK AT THE VIDEO VIEWING! Within a 15 minute walk of our fine Welsh Capital City Centre is this neat and generously sized one bedroom apartment that is very-nicely presented throughout. Offering open-plan lounge/kitchen with large, modern kitchen complete with gas hob, generous worktop space and good quality appliances, excellent living space (space for two sofas,) large double bedroom and modern bathroom suite with bathtub and shower over. Perfect for a couple, the property is a great option and great value for money!

GAS CENTRAL HEATING. FURNISHED.

EPC RATING of C

A holding fee of one weeks' rent will be payable to secure the property. This will be deducted from the final balance payable upon moving into the property, subject to a successful application. JeffreyRoss Limited reserves the right to retain this payment should the applicant have provided false or misleading information at the time of applying for the Tenancy or failed to take reasonable steps to enter into the tenancy agreement.



## Newport Road, Roath

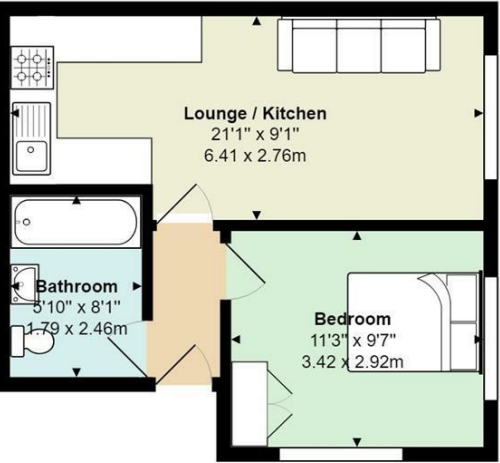

Total Area: 372 ft² ... 34.5 m²

All measurements are approximate and for display purposes only

### PROPERTY SPECIALIST

Miss Lauren King

lauren.king@jeffreycross.co.uk  
02920499680

Lettings Negotiator

