



Key Features

- ◆ MINIMUM AGE OF 60
- ◆ One-Bedroom, Third-Floor retirement apartment
- ◆ 24 hour Emergency Call system
- ◆ Security of a long-term rental contract
- ◆ Communal Gardens and Laundry
- ◆ EPC rating C



The Avenue, Eastbourne

£995 PCM



MINIMUM AGE OF 60

Northwood are delighted to welcome to market this lovely one-bedroom, third-floor, retirement apartment just off Eastbourne town centre.

Accommodation comprises: living room, kitchen with space for fridge-freezer and washing machine, double bedroom with built-in wardrobes, and shower room.





Further benefits include brand new carpets throughout the flat, lift access, daytime house manager, emergency assistance pull cords, secure door entry system for peace of mind, well maintained communal lounge, communal gardens, free-to-use communal laundry and guest suite for visiting family.

Located just off Eastbourne town centre, a short walk from the shops and train station and just a little further from the seafront and theatres, this fantastic apartment is in the sought after Homegate House development, a lively community offering a variety of social events including coffee mornings, bingo and fish & chip suppers.

Please view our immersive virtual tour to fully appreciate this fantastic property:
<https://tour.giraffe360.com/51249dc2dd79408ab29e3fbb1b7d063a>

Mobile Phone Coverage and Broadband speeds can be checked on the Ofcom website:
<https://checker.ofcom.org.uk/>

Council Tax Band A: £1688

Holding Deposit: £230.00 (equivalent to one week's rent)

Full Deposit: £1145.00 (holding deposit + equivalent of four weeks' rent)

1st month's rent + Full Deposit: £2140.00

Security of a long-term let





**OVER
60s
Retirement
Apartment**



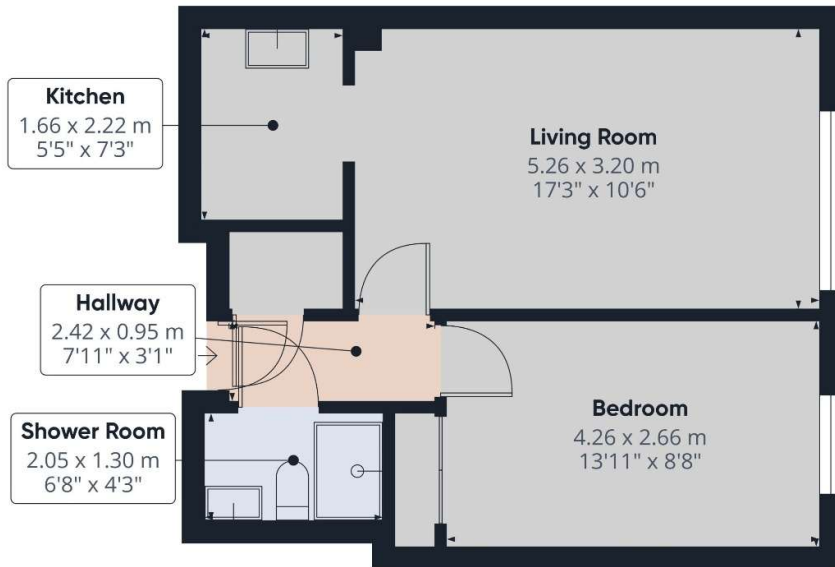

Approximate total area⁽¹⁾
39.2 m²
423 ft²

(1) Excluding balconies and terraces

Calculations reference the RICS IPMS 3C standard. Measurements are approximate and not to scale. This floor plan is intended for illustration only.

GIRAFFE360

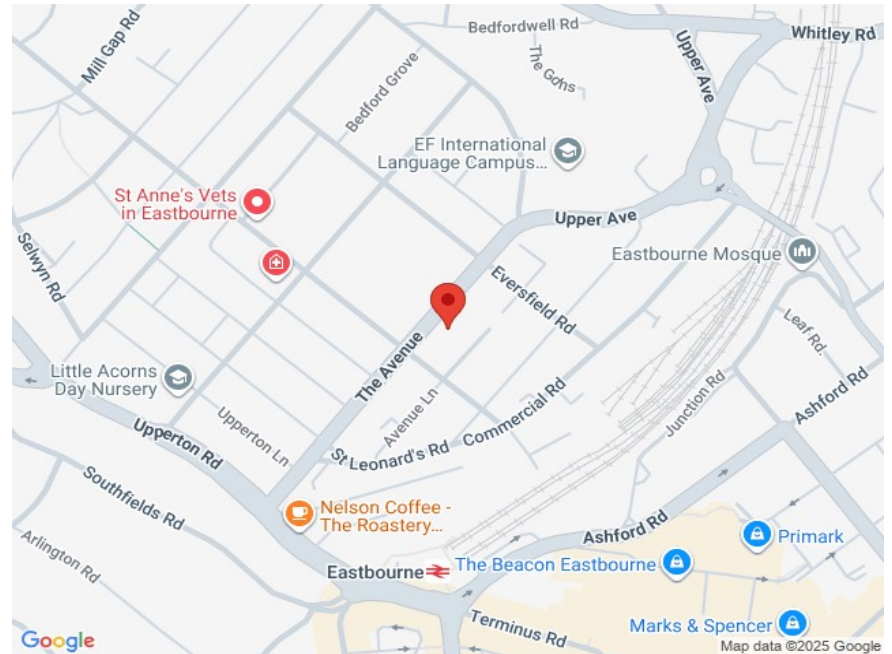

Northwood

81-83 South Street

Eastbourne

BN21 4LR

01323 744544

eastbourne@northwooduk.com