



Upperton Gardens, Eastbourne

£475 PCM

Key Features

- ◆ Room with private kitchen
- ◆ Town centre location
- ◆ Shared use of two shower rooms
- ◆ Communal courtyard garden
- ◆ EPC rating C

1  0  2 

northwood
Local knowledge, national reach



Northwood are delighted to welcome to the market this SINGLE OCCUPANCY ROOM located just off Eastbourne town centre.

Accommodation comprises: room with private kitchen including electric mini-oven and under- counter fridge/freezer, shared use of two toilets and two shower rooms.

Further benefits include electric heating, pay-as-you-go electricity meter and access to communal courtyard garden.

Rent includes council tax, water and sewerage charges.

Located just off Eastbourne town centre, a short walk from the mainline train station, shops, cafes, restaurants and bars, this room is ideal for single occupants who wish to make the most of life on the South Coast.





Holding Deposit: £105.00 (one week's rent)
Full Deposit: £475.00
1st month's rent + Full Deposit: £950.00
Minimum Tenancy: 6 months

Please view our immersive virtual tour to fully appreciate this fantastic property:
<https://tour.giraffe360.com/abe8a04181d74e92bd24ec9dce25bf97/>

Mobile Phone Coverage and Broadband speeds can be checked on the Ofcom website:
<https://checker.ofcom.org.uk/>

Total household income must exceed £14,250.00 to be considered for this property.

This property is managed by Northwood, should a maintenance issue arise, it can be reported 24 hours a day via our website.





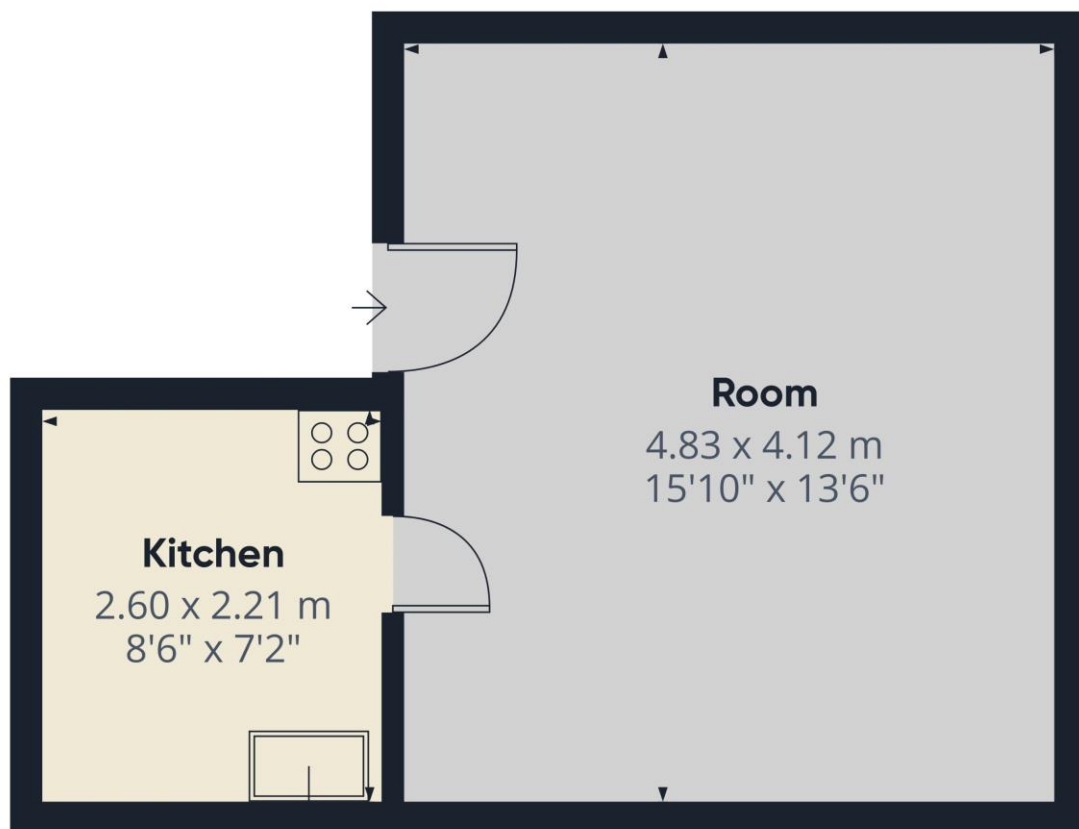

Approximate total area⁽¹⁾

25.6 m²
275 ft²

Reduced headroom

0.1 m²
1 ft²

(1) Excluding balconies and terraces

Reduced headroom

Below 1.5 m/5 ft

Calculations reference the RICS IPMS 3C standard. Measurements are approximate and not to scale. This floor plan is intended for illustration only.

GIRAFFE360



SEE MORE ONLINE

Northwood

81-83 South Street
Eastbourne
BN21 4LR
01323 744544
eastbourne@northwooduk.com