



Key Features

- ◆ Three-bedroom, terraced house
- ◆ Walking distance from town centre
- ◆ Close to local schools and shops
- ◆ Private rear garden
- ◆ Garage en bloc
- ◆ EPC rating C



Southerden Close, Hailsham

£1,300 PCM



Northwood are delighted to welcome to market this lovely three bedroom terraced house in Southerden Close, Hailsham.

Accommodation comprises: open-plan lounge-diner, fitted kitchen, two double bedrooms, one single bedroom and bathroom with shower over bath.

Further benefits include double glazing, gas central heating, front and rear gardens and garage en bloc.

Located in a quiet cul-de-sac walking distance from Hailsham town centre, local shops, schools and bus routes, this pleasant terraced house makes a perfect family home.





Please view our immersive virtual tour to fully appreciate this fantastic property:
<https://tour.giraffe360.com/38b2b80f355341c8a673cea35514af13/>

Mobile Phone Coverage and Broadband speeds can be checked on the Ofcom website:
<https://checker.ofcom.org.uk/>

Council Tax Band C: £2208

Holding Deposit: £300.00 (one week's rent)

Full Deposit: £1500.00

1st month's rent + Full Deposit: £2800.00

Minimum Tenancy: 6 months

Total household income must exceed £39,000.00 to be considered for this property.





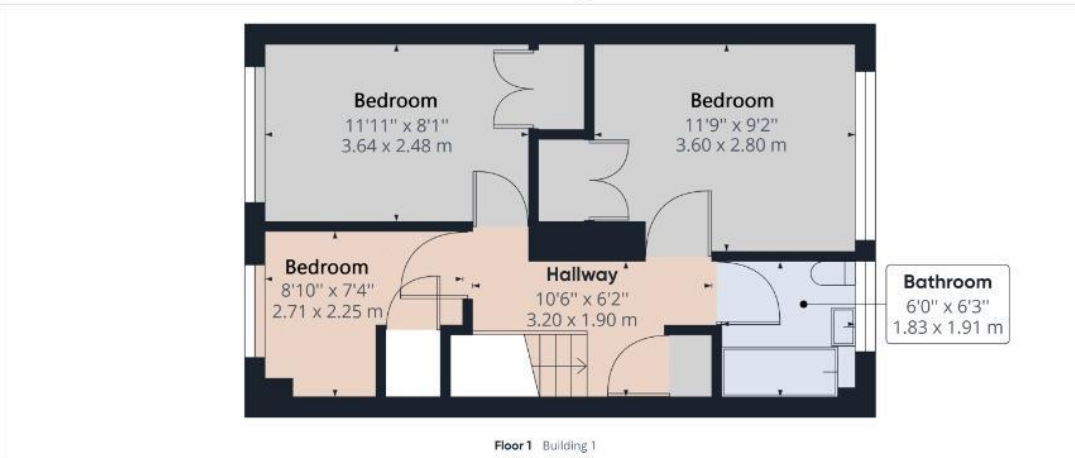

Approximate total area⁽¹⁾

790.45 ft²

73.44 m²

(1) Excluding balconies and terraces

While every attempt has been made to ensure accuracy, all measurements are approximate, not to scale. This floor plan is for illustrative purposes only.

GIRAFFE360



Northwood

81-83 South Street

Eastbourne

BN21 4LR

01323 744544

eastbourne@northwooduk.com

