



Grove Road, Eastbourne

Key Features

- ◆ One bedroom, second floor flat
- ◆ Sought after Little Chelsea location
- ◆ Recently redecorated
- ◆ Local shops, cafes and amenities on the doorstep
- ◆ Short walk from train station and seafront
- ◆ EPC rating D



£650 PCM



Northwood are delighted to welcome to market this one bedroom, second floor flat in the popular Little Chelsea area of Eastbourne.

Accommodation comprises: living room, separate fitted kitchen with freestanding cooker, bedroom big enough for a small double bed, and en suite shower room.

Further benefits include: double glazing, electric heating and secure entry phone.





Located above the shops on Grove Road, this fantastic one bedroom property has cafes, shops and local amenities directly outside and is just a short walk from the train station, town centre shops, theatres and Eastbourne's fabulous Victorian seafront.

Please view our immersive virtual tour to fully appreciate this fantastic property:

<https://tour.giraffe360.com/fad469ab64594047aa5580fb925f52a0/>

Council Tax Band A: £1611

Holding Deposit: £150.00 (one week's rent)

Full Deposit: £750.00

1st month's rent + Full Deposit: £1400.00

Minimum Tenancy: 6 months

Total household income must exceed £19,500.00 to be considered for this property.





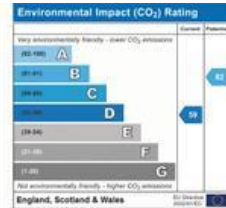
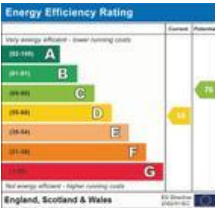
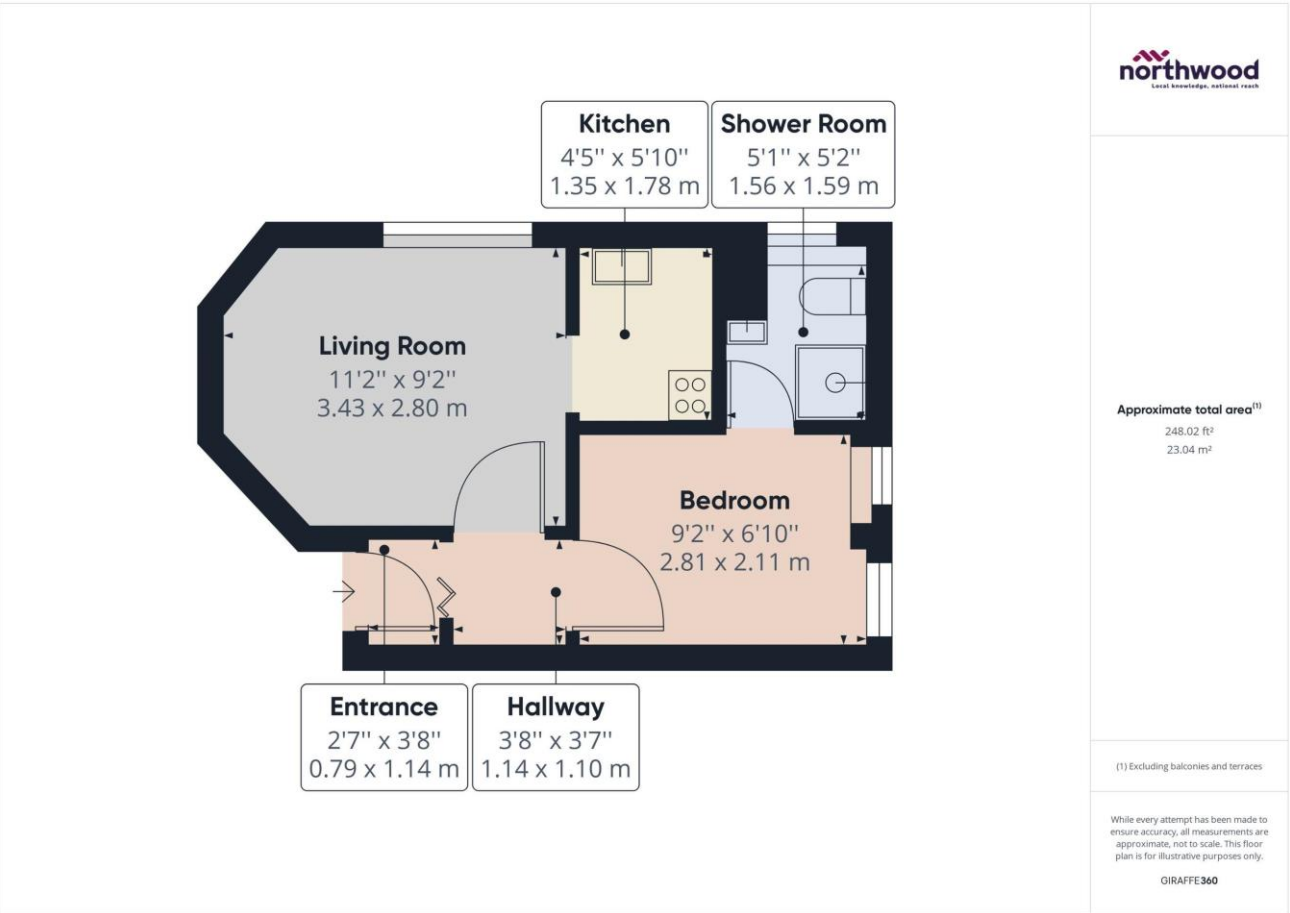

Northwood
81-83 South Street
Eastbourne
BN21 4LR
01323 744544
eastbourne@northwooduk.com

