



ASPIRE

— TO MOVE —



Portland Place, Frome

Video and physical viewings available. Recently refurbished two bedroom ground floor flat located in Portland Place, Frome. Offered unfurnished and available as soon as possible.

Portland Place is located to the east side of Frome town centre and this can be accessed via a short walk. There is communal parking and communal gardens available with the property.

- Two bedrooms
- Ground floor
- Parking
- Communal gardens
- 12-month periodic contract
- Available January 2026
- Holding deposit - one weeks worth of rent - £207.00
- Council tax band - A - Mendip Council - 1,702.47

£900 PCM

Floor Plans

GROUND FLOOR
429 sq.ft. (39.8 sq.m.) approx.

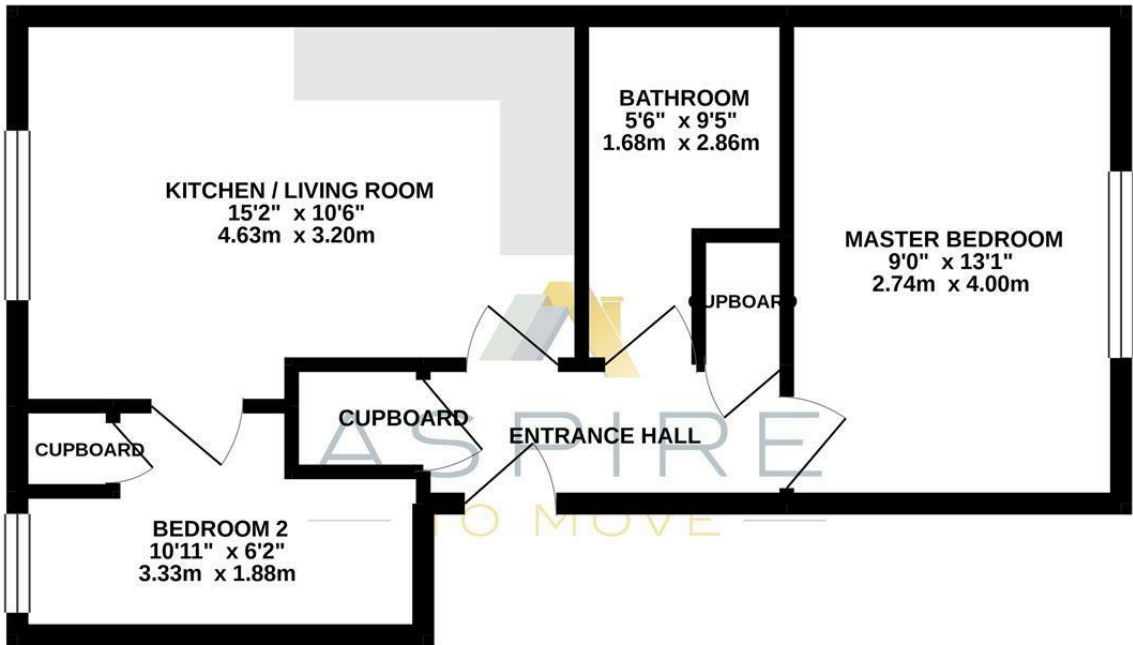

PORTLAND PLACE, FROME, BA11

TOTAL FLOOR AREA : 429 sq.ft. (39.8 sq.m.) approx.

Whilst every attempt has been made to ensure the accuracy of the floorplan contained here, measurements of doors, windows, rooms and any other items are approximate and no responsibility is taken for any error, omission or mis-statement. This plan is for illustrative purposes only and should be used as such by any prospective purchaser. The services, systems and appliances shown have not been tested and no guarantee as to their operability or efficiency can be given.
Made with Metropix ©2021.

Energy Performance Graph

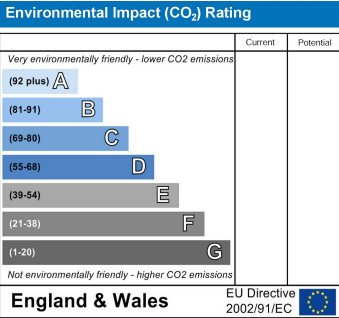
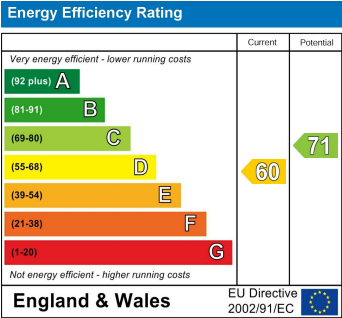

These particulars, whilst believed to be accurate are set out as a general outline only for guidance and do not constitute any part of an offer or contract. Intending purchasers should not rely on them as statements of representation of fact, but must satisfy themselves by inspection or otherwise as to their accuracy. No person in this firms employment has the authority to make or give any representation or warranty in respect of the property.