



# ASPIRE

— TO MOVE —



## Bladud Buildings, Bath, BA1

Video and physical viewings available. First floor one bedroom flat located in central Bath, available from the 1st August. The flat can be offered furnished.

Bladud buildings is located to the north of Bath city centre and provides excellent access to local amenities on George Street, 0.1 miles away. There is a bus stop 0.2 miles away on Milsom Street.

- First floor flat
- One double bedroom
- Available 1st August
- Video viewing available
- City central location
- Holding deposit: £276
- Offered furnished

**£1,200 PCM**

Floor Plans

FIRST FLOOR  
513 sq.ft. (47.7 sq.m.) approx.

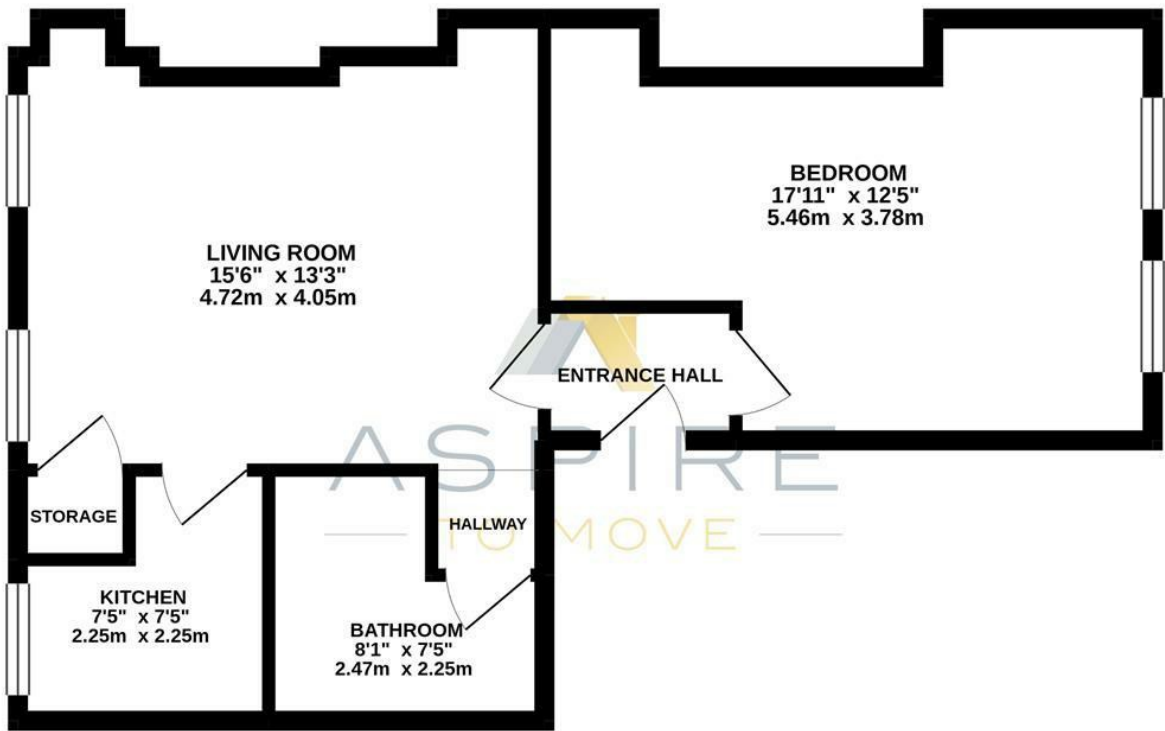

BLADUD BUILDINGS, BATH, BA1

TOTAL FLOOR AREA: 513 sq.ft. (47.7 sq.m.) approx.

Whilst every attempt has been made to ensure the accuracy of the floorplan contained here, measurements of doors, windows, rooms and any other items are approximate and no responsibility is taken for any error, omission or mis-statement. This plan is for illustrative purposes only and should be used as such by any prospective purchaser. The services, systems and appliances shown have not been tested and no guarantee as to their operability or efficiency can be given.

Made with Metropix ©2021

Energy Performance Graph

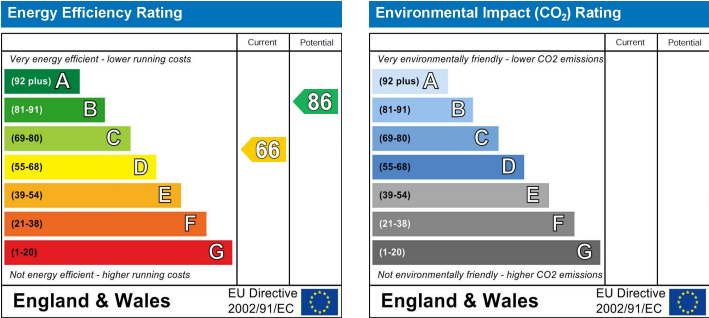

These particulars, whilst believed to be accurate are set out as a general outline only for guidance and do not constitute any part of an offer or contract. Intending purchasers should not rely on them as statements of representation of fact, but must satisfy themselves by inspection or otherwise as to their accuracy. No person in this firms employment has the authority to make or give any representation or warranty in respect of the property.