



ASPIRE

— TO MOVE —



Milsom Street, Bath, BA1

One bedroom, top floor apartment located in a new development on Milsom Street. The flat is offered part-furnished and is available from July.

Milsom Apartments is a unique residential development of 14 apartments within a Grade II listed building and combines a traditional Georgian exterior with contemporary internal elegance. Local amenities are aplenty and there are shops, cafe's, restaurants and a bus stop on Milsom Street.

£1,350 PCM

Milsom Street, Bath, BA1

- One bedroom apartment
- Part furnished
- Council tax band B
- Top floor
- Available from July
- City central location
- Gated entry system
- Holding deposit: £311

One bedroom, top floor apartment located in a new development on Milsom Street. The flat is offered part-furnished and is available from July.

Milsom Apartments is a unique residential development of 14 apartments within a Grade II listed building and combines a traditional Georgian exterior with contemporary internal elegance. Local amenities are aplenty and there are shops, cafe's, restaurants and a bus stop on Milsom Street.

The apartment has an entrance hallway with good sized living room and bedroom. The bedroom comes with double bed, mattress, built in wardrobe and two bedside table. There is a separate kitchen with attractive glazed vaulted ceiling. There are base and wall units, cooker, induction hob, fridge/freezer, slimline dishwasher and microwave. There is a shower room with walk in shower, WC and sink.

The flat is offered part furnished and is available from July. The flat would best suit a single professional or couple. Mature students considered.

Council tax band B: £1722.41

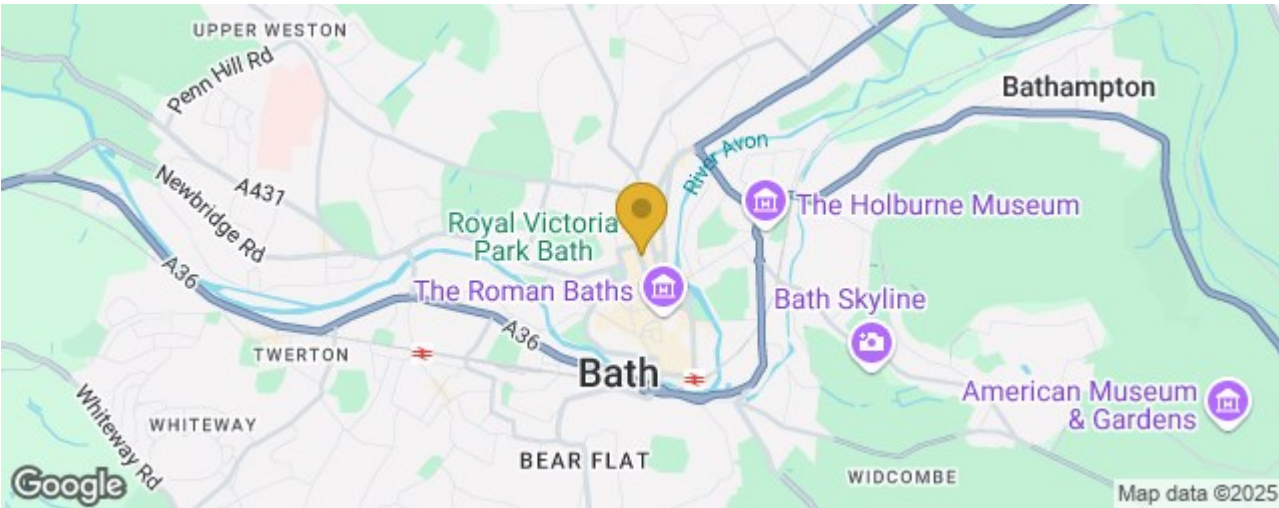



Floor Plan

TOP FLOOR
471 sq.ft. (43.7 sq.m.) approx.

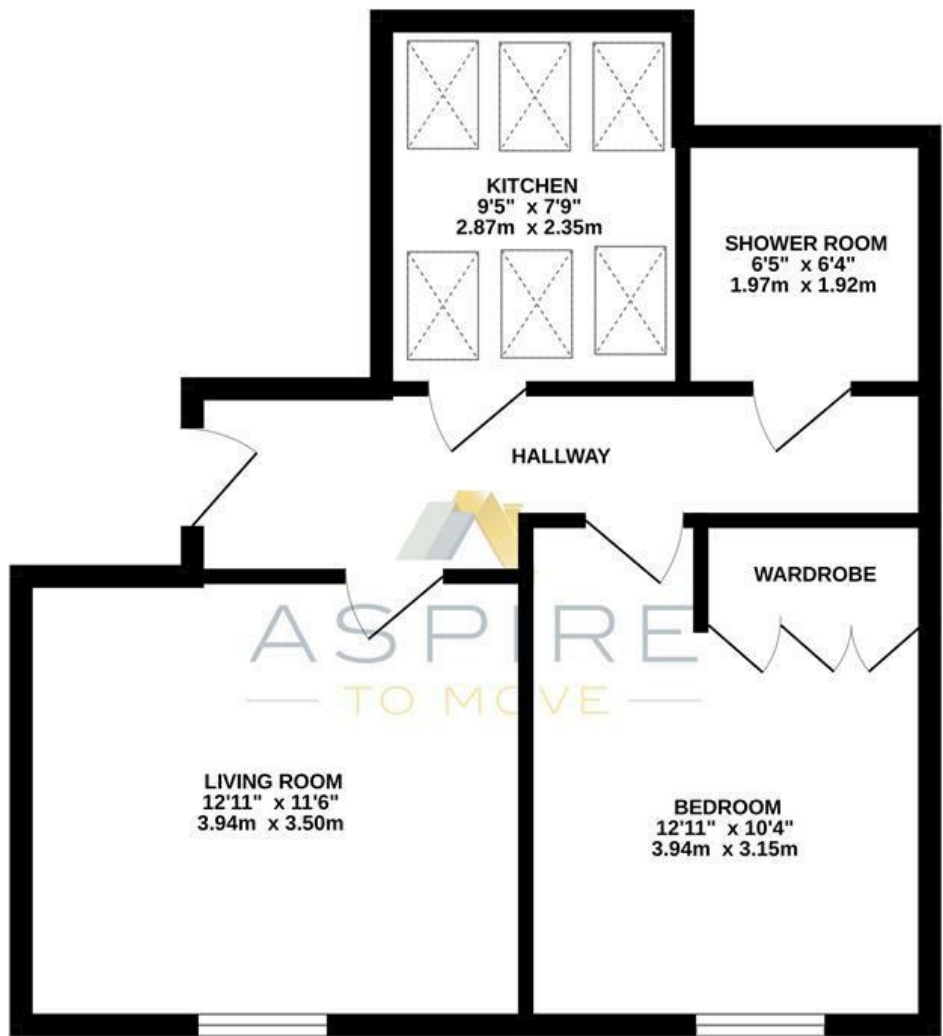

MILSOM APARTMENTS, BATH, BA1

TOTAL FLOOR AREA : 471 sq.ft. (43.7 sq.m.) approx.
Whilst every attempt has been made to ensure the accuracy of the floorplan contained here, measurements of doors, windows, rooms and any other items are approximate and no responsibility is taken for any error, omission or mis-statement. This plan is for illustrative purposes only and should be used as such by any prospective purchaser. The services, systems and appliances shown have not been tested and no guarantee as to their operability or efficiency can be given.
Made with Metropix ©2025

These particulars, whilst believed to be accurate are set out as a general outline only for guidance and do not constitute any part of an offer or contract. Intending purchasers should not rely on them as statements of representation of fact, but must satisfy themselves by inspection or otherwise as to their accuracy. No person in this firms employment has the authority to make or give any representation or warranty in respect of the property.

