



ASPIRE

— TO MOVE —



Grosvenor Place, Bath, BA1

Video and physical viewings available. Furnished one bedroom flat located on Grosvenor Place, available 3rd June, 12 month contract.

Grosvenor place is located to the North East of Bath city centre near to the area of Larkhall. The area of Larkhall is located 1.2 miles to the east of Bath city centre. An abundance of local shops can be found on St Saviours Road including a Deli, Butchers, Farm shop, Dentist, Café, and a Hardware store. There are also three pubs located close by; The Rose and Crown, The Larkhall Inn and the Bladud's Head. Other amenities include Bath Artist Printmakers artist co-operative and The Rondo Theatre. Larkhall Square is at the centre of the shopping area. The local church is St Saviour's Church. Local schools include St Saviour's junior/primary school and St Mark's secondary school. Bus stops can be found along St Saviour's Road and also London Road.

£1,150 PCM

Grosvenor Place, Bath, BA1

- Video viewing available
- South facing views
- Available 3rd June
- Furnished
- Masters/Post graduate student considered
- Holding deposit: £265
- One bedroom flat
- Council tax band A: £1476.36

Video and physical viewings available. Furnished one bedroom flat located on Grosvenor Place, available 3rd June, 12 month contract.

Grosvenor place is located to the North East of Bath city centre near to the area of Larkhall. The area of Larkhall is located 1.2 miles to the east of Bath city centre. An abundance of local shops can be found on St Saviours Road including a Deli, Butchers, Farm shop, Dentist, Café, and a Hardware store. There are also three pubs located close by; The Rose and Crown, The Larkhall Inn and the Bladud's Head. Other amenities include Bath Artist Printmakers artist co-operative and The Rondo Theatre. Larkhall Square is at the centre of the shopping area. The local church is St Saviour's Church. Local schools include St Saviour's junior/primary school and St Mark's secondary school. Bus stops can be found along St Saviour's Road and also London Road.

The flat is located on the top floor and is offered furnished. The accomodation comprises of kitchen/living/dining room, bedroom and shower room. The kitchen area has base and wall units with integrated appliances including a cooker, hob, extractor, fridge/freezer, washer/dryer and dishwasher. A sofa, armchair, table, side table and two chairs are including in the living space. The bedroom comes with double bed, mattress and wardrobe. The shower room has shower, shelving for storage, WC and sink. The flat enjoys splendid south facing views over Kensington Meadows and up towards to the Kennett and Avon canal.

The property is available 3rd June on an initial 12 month contract. The flat would best suit a single professional or couple or a single master/post graduate student.

Council tax band A: £1476.36





Floor Plan

TOP FLOOR
337 sq.ft. (31.3 sq.m.) approx.

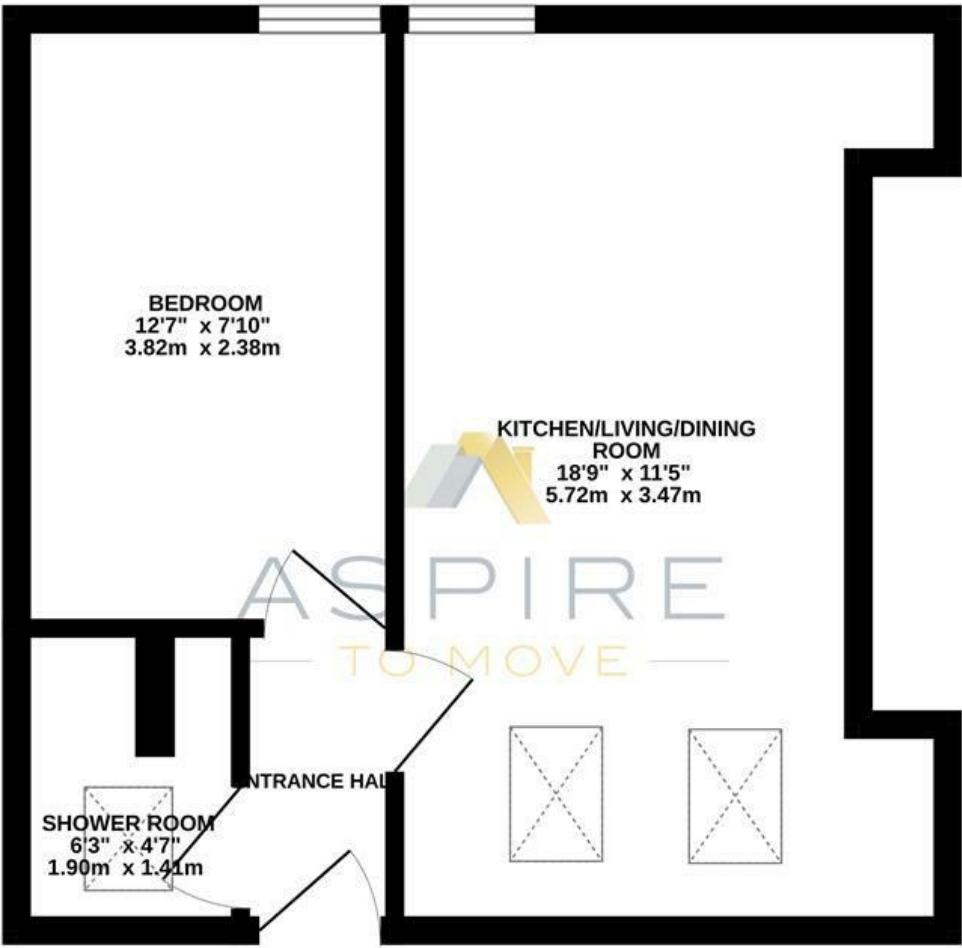

GROSVENOR PLACE, BATH, BA1

TOTAL FLOOR AREA: 337 sq.ft. (31.3 sq.m.) approx.

Whilst every attempt has been made to ensure the accuracy of the floorplan contained here, measurements of doors, windows, rooms and any other items are approximate and no responsibility is taken for any error, omission or mis-statement. This plan is for illustrative purposes only and should be used as such by any prospective purchaser. The services, systems and appliances shown have not been tested and no guarantee as to their operability or efficiency can be given.
Made with Metropix ©2023

These particulars, whilst believed to be accurate are set out as a general outline only for guidance and do not constitute any part of an offer or contract. Intending purchasers should not rely on them as statements of representation of fact, but must satisfy themselves by inspection or otherwise as to their accuracy. No person in this firms employment has the authority to make or give any representation or warranty in respect of the property.

