



ASPIRE

— TO MOVE —



Vineyards, Bath, BA1

Please note this property is not suitable for students. Video and physical viewings available. Four/five bedroom property which can be offered furnished or unfurnished located in central Bath and available now.

The property is located on the Vineyards, located just on from Milsom Street in Bath city centre. The property provides excellent access to local amenities including bars, restaurants, and shops. Hedgemoor Park is also located 0.1 miles away.

£2,750 PCM

Vineyards, Bath, BA1

- Not suitable for students or sharers
- Holding deposit: £807
- Council tax band: F
- Furnished or unfurnished
- Central location
- Available now
- 12 month initial contract
- Rear garden
- Close to local amenities

Please note this property is not suitable for students. Video and physical viewings available. Four/five bedroom property which can be offered furnished or unfurnished located in central Bath and available now.

The property is located on the Vineyards, located just on from Milsom Street in Bath city centre. The property provides excellent access to local amenities including bars, restaurants, and shops. Hedgemoor Park is also located 0.1 miles away.

On the ground floor the property features a kitchen/dining room with base and wall units, cooker, hob, fridge and dishwasher. The living room is located to the rear of the property and has sofa's, coffee table and TV unit. There is a downstairs shower room with WC, sink and shower cubicle. There is also a second reception room or 5th bedroom, this room could be used as a child's playroom or study.

On the first floor there is a fantastic master bedroom with en-suite. The room is a large double and offers lots of storage. The en-suite has free standing bath, two sinks, toilet and large walk in shower. Also on this floor is a second double bedroom and a shower room. On the top floor there are two further double bedrooms and a shower room.

All furniture can stay or can alternatively be removed.

There is a garden located to the rear with a patio and area laid to lawn.

The property is available now and can be offered furnished or unfurnished.

Council tax band F: £3043.52

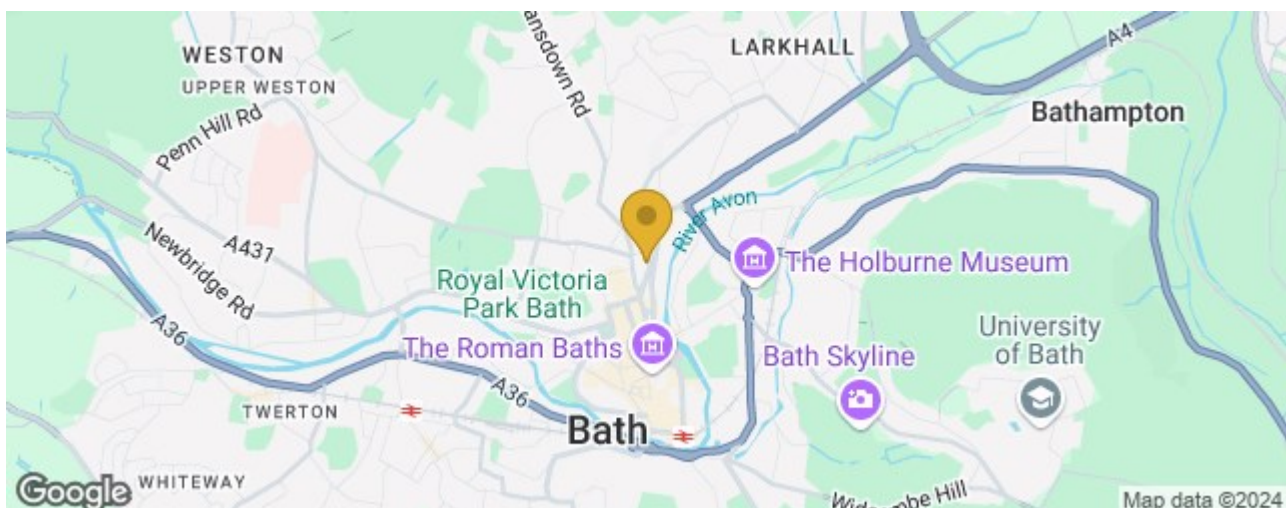



Floor Plan

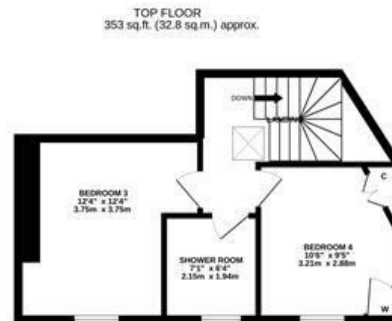

VINEYARDS, BATH, BA1

TOTAL FLOOR AREA : 1416 sq.ft. (131.5 sq.m.) approx.

Whilst every attempt has been made to ensure the accuracy of the floorplan contained here, measurements of doors, windows, rooms and any other items are approximate and no responsibility is taken for any error, omission or mis-statement. This plan is for illustrative purposes only and should be used as such by any prospective purchaser. The services, systems and appliances shown have not been tested and no guarantee as to their operability or efficiency can be given.
Made with Metropix ©2022

These particulars, whilst believed to be accurate are set out as a general outline only for guidance and do not constitute any part of an offer or contract. Intending purchasers should not rely on them as statements of representation of fact, but must satisfy themselves by inspection or otherwise as to their accuracy. No person in this firm's employment has the authority to make or give any representation or warranty in respect of the property.

