



ASPIRE

— TO MOVE —



School Court, Spring Lane, Bath, BA1

Video and physical viewings available. Two bedroom first floor flat located in Larkhall, Bath. Available now and offered unfurnished. On street parking

School Court is located on Spring Lane in Larkhall. The property has good access to local amenities including a bus stop, 0.2 miles away and local shops located on St Saviours Road, 0.4 miles away.

£1,350 PCM

School Court, Spring Lane, Bath, BA1

- Two bedroom flat
- Available now
- Unfurnished
- Video viewing available
- On street parking
- 12 month initial contract
- Ensuite and family bathroom
- Lockable storage cupboard outside
- Council tax band B
- Holding deposit: £311

Video and physical viewings available. Two bedroom first floor flat located in Larkhall, Bath. Available now and offered unfurnished. On street parking

School Court is located on Spring Lane in Larkhall. The property has good access to local amenities including a bus stop, 0.2 miles away and local shops located on St Saviours Road, 0.4 miles away.

The kitchen living room is open plan and the kitchen has base and wall units, cooker, hob, integral fridge, freezer and dishwasher. The living room has solid flooring and a large window allowing in natural light. There is space for sofa, coffee table and dining table/chairs. Bedroom one benefits from a balcony, en-suite shower room, WC, sink and a dressing room. Bedroom two is a smaller double and could be used as a guest/children's bedroom or study. There is also a separate family bathroom with shower over bath, WC and sink. The flat also benefits from a large storage cupboard. There is plumbing for a washing machine in a separate cupboard.

Available now and would best suit a professional couple or small family. There is access to a shared lockable storage cupboard and parking is available on the street.

Council tax band B: £1638.83





FIRST FLOOR
638 sq.ft. (59.3 sq.m.) approx.

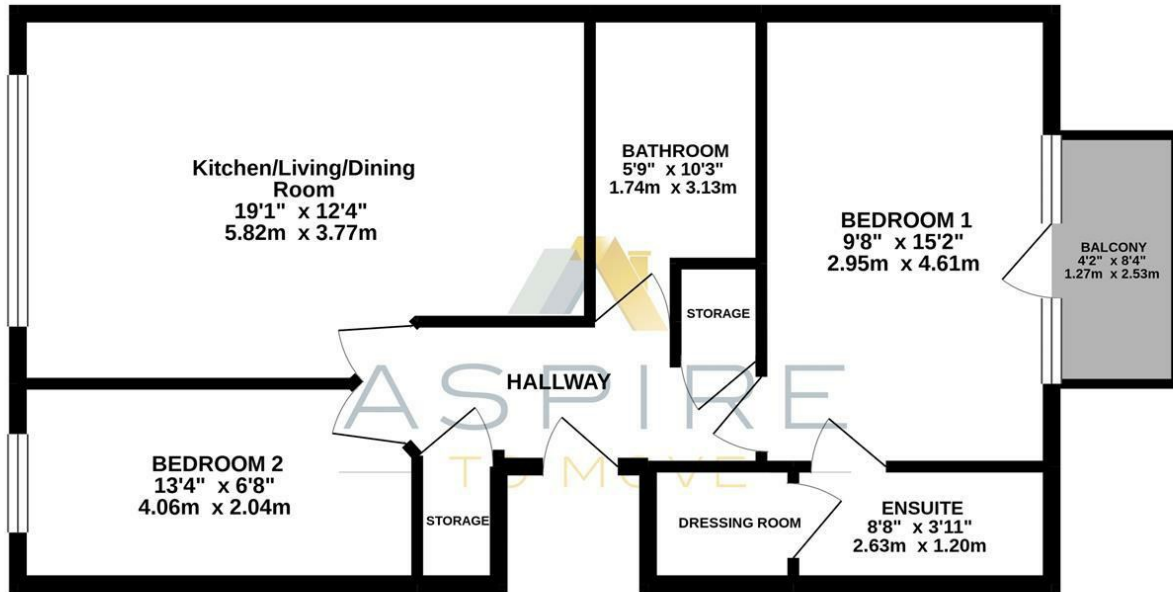

SCHOOL COURT, BATH, BA1

TOTAL FLOOR AREA : 638 sq.ft. (59.3 sq.m.) approx.

Whilst every attempt has been made to ensure the accuracy of the floorplan contained here, measurements of doors, windows, rooms and any other items are approximate and no responsibility is taken for any error, omission or mis-statement. This plan is for illustrative purposes only and should be used as such by any prospective purchaser. The services, systems and appliances shown have not been tested and no guarantee as to their operability or efficiency can be given.
Made with Metropix ©2022.

These particulars, whilst believed to be accurate are set out as a general outline only for guidance and do not constitute any part of an offer or contract. Intending purchasers should not rely on them as statements of representation of fact, but must satisfy themselves by inspection or otherwise as to their accuracy. No person in this firms employment has the authority to make or give any representation or warranty in respect of the property.

