



ASPIRE

— TO MOVE —



Dorset Street, Bath, BA2

Video and physical viewings available. Two bedroom terraced house, 0.1 miles from Oldfield Park Station. Available now to a professional couple, family or two professional sharers. Unfurnished.

The property is located on Dorset Street and provides excellent access to Oldfield Park Station and there on to Bath Spa or Bristol Temple Meads. Local amenities can be found on Moorland Road 0.2 miles away.

- Video viewing available
- Two bedroom house
- Recently repainted and new flooring throughout
- Available now
- 12 month initial contract
- Garden to rear
- Council tax band C
- Holding deposit: £323

£1,400 PCM

Floor Plans

GROUND FLOOR
514 sq.ft. (47.8 sq.m.) approx.

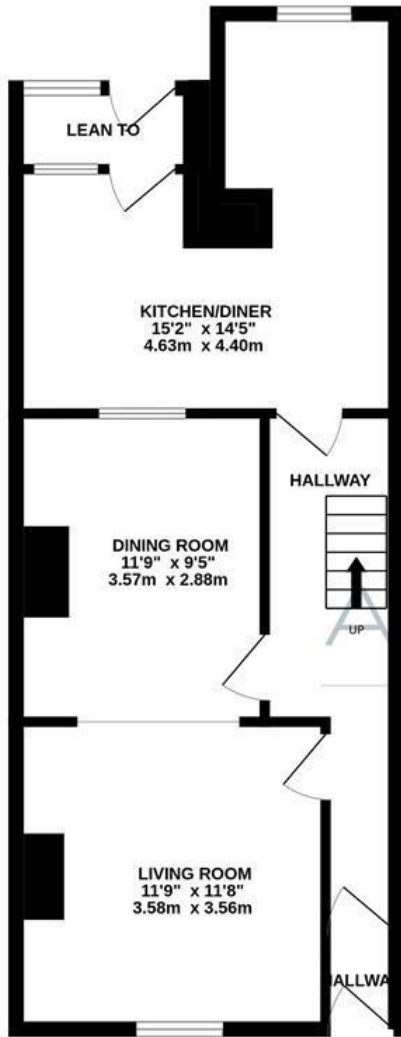

1ST FLOOR
394 sq.ft. (36.6 sq.m.) approx.



DORSET STREET, BATH, BA2

TOTAL FLOOR AREA: 908 sq.ft. (84.4 sq.m.) approx.

Whilst every attempt has been made to ensure the accuracy of the floorplan contained here, measurements of doors, windows, rooms and any other items are approximate and no responsibility is taken for any error, omission or mis-statement. This plan is for illustrative purposes only and should be used as such by any prospective purchaser. The services, systems and appliances shown have not been tested and no guarantee as to their operability or efficiency can be given.
Made with Metropix ©2024

Energy Performance Graph

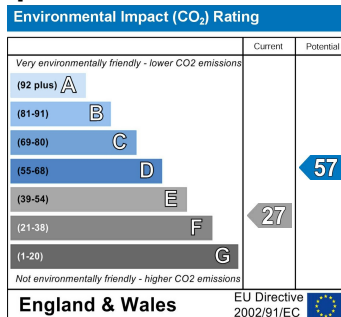
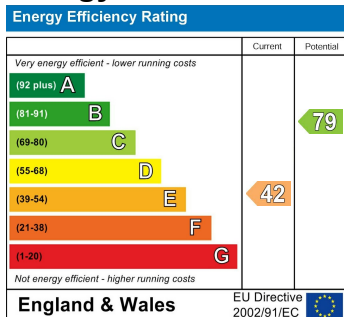

These particulars, whilst believed to be accurate are set out as a general outline only for guidance and do not constitute any part of an offer or contract. Intending purchasers should not rely on them as statements of representation of fact, but must satisfy themselves by inspection or otherwise as to their accuracy. No person in this firm's employment has the authority to make or give any representation or warranty in respect of the property.