



# ASPIRE

— TO MOVE —



## Bevan Road, Bitton, BS30

FULLY BOOKED FOR VIEWINGS. Video and physical viewings available. Modern two bedroom coach house located in Bitton. The property is available unfurnished from the 12th August and would best suit a professional couple.

Bevan Road is situated in the heart of the new Bitton Mill development. The development is in an ideal location for commuters as it's 7 miles from the cities of Bristol & Bath.

**£1,250 PCM**

# Bevan Road, Bitton, BS30

- Video viewing available
- Two double bedrooms
- Coach House
- Garage
- Available 12th August
- Unfurnished
- Council tax band B
- Holding deposit £288

FULLY BOOKED FOR VIEWINGS. Video and physical viewings available. Modern two bedroom coach house located in Bitton. The property is available unfurnished from the 12th August and would best suit a professional couple.

Bevan Road is situated in the heart of the new Bitton Mill development. The development is in an ideal location for commuters as it's 7 miles from the cities of Bristol & Bath.

On the ground floor level there is a garage with space to park one car, there is also a storage cupboard inside the garage with space for a tumble dryer and bicycle storage. Entrance hall with stairs leading up to the living accommodation. There is an open plan kitchen/living/dining room, with base and wall units and integrated oven/hob. There is space for a washing machine or dishwasher and fridge/freezer. A handy storage cupboard houses the boiler and offers plenty of room for storage and somewhere for a washing machine.

There are two double bedrooms, one of which has an en-suite shower room. There is also a main bathroom with shower over bath, WC and sink.

Available unfurnished from the 12th August this property would best suit a professional couple. No students, sharers or pets. Initial 12 month contract

Council tax band B: £1,743.54





# Floor Plan

GROUND FLOOR  
200 sq.ft. (18.5 sq.m.) approx.

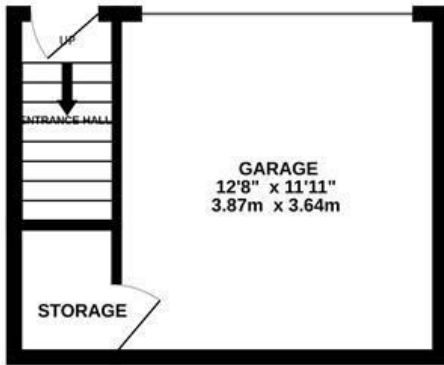

1ST FLOOR  
682 sq.ft. (63.4 sq.m.) approx.

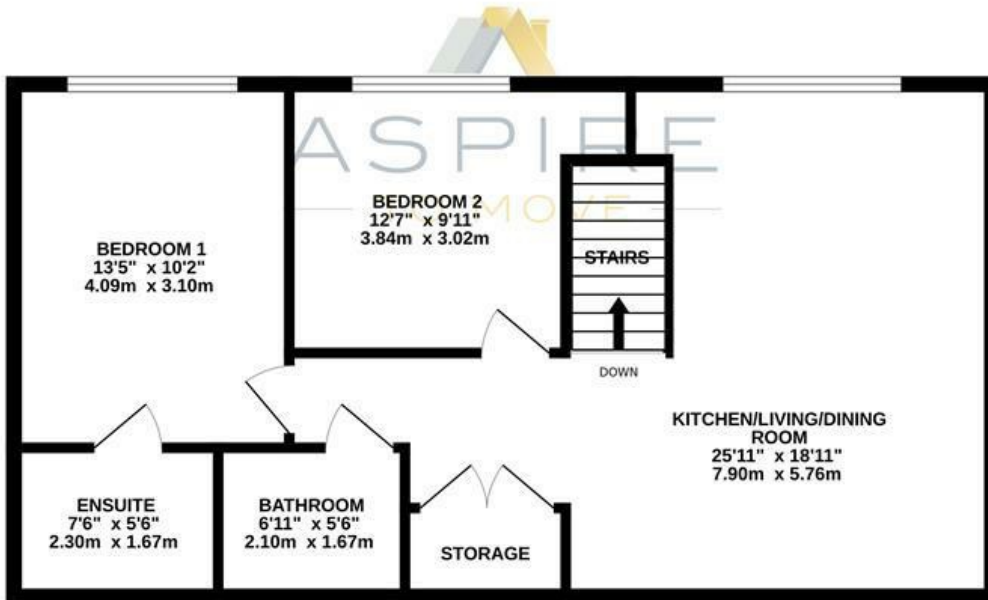

BEVAN ROAD, BITTON, BS30

TOTAL FLOOR AREA : 882 sq.ft. (81.9 sq.m.) approx.

Whilst every attempt has been made to ensure the accuracy of the floorplan contained here, measurements of doors, windows, rooms and any other items are approximate and no responsibility is taken for any error, omission or mis-statement. This plan is for illustrative purposes only and should be used as such by any prospective purchaser. The services, systems and appliances shown have not been tested and no guarantee as to their operability or efficiency can be given.  
Made with Metropix ©2023

These particulars, whilst believed to be accurate are set out as a general outline only for guidance and do not constitute any part of an offer or contract. Intending purchasers should not rely on them as statements of representation of fact, but must satisfy themselves by inspection or otherwise as to their accuracy. No person in this firm's employment has the authority to make or give any representation or warranty in respect of the property.

