



ASPIRE

— TO MOVE —



Bedford Court, Bath, BA1

Video and physical viewings available. Stunning two bedroom furnished maisonette with parking and views across the river Avon. Offered furnished and available from 15th June.

Bedford Court is located just off London Road and provides excellent access into Bath city centre. There is a bus stop 0.1 miles away and local shops on London Road including a Morrisons supermarket 0.2 miles away.

£1,650 PCM

Bedford Court, Bath, BA1

- Two double bedrooms
- Students considered
- Riverside views
- Furnished
- Communal gardens
- Council tax band A
- Available 15th June 2024
- Allocated parking space
- Holding deposit: £380

Video and physical viewings available. Stunning two bedroom furnished maisonette with parking and views across the river Avon. Offered furnished and available from 15th June.

Bedford Court is located just off London Road and provides excellent access into Bath city centre. There is a bus stop 0.1 miles away and local shops on London Road including a Morrisons supermarket 0.2 miles away.

The property has an entrance hall which leads to the open plan kitchen / living / dining area. The kitchen area has integrated fridge with freezer box, washing machine, oven and hob as well as a microwave. Furniture is provided - there is a table with four chairs, sofa, armchair, coffee table and a wall mounted TV. This room overlooks the communal garden and gives views over the River Avon. Adjacent to the hallway is a shower room, fitted with walk in shower, WC and basin.

Upstairs there are two double bedrooms. Bedroom one is a double room and comes with a double bed as well as two bedside tables and a wardrobe. Bedroom two has a mezzanine floor to fit a double mattress as well as two cupboards for wardrobe space. Both bedrooms benefit from having skylights allowing natural light into the room however they do have some restricted head access due the property being converted.

The property has one allocated parking space and benefits from use of the delightful communal gardens which over look the River Avon and give views all the way up to Bathwick bridge. The property has electric heating and has individually programmable heaters in each room.

To suit a professional couple/professional sharers or two mature students. Available 15th June.

Council tax band A: £1404.70

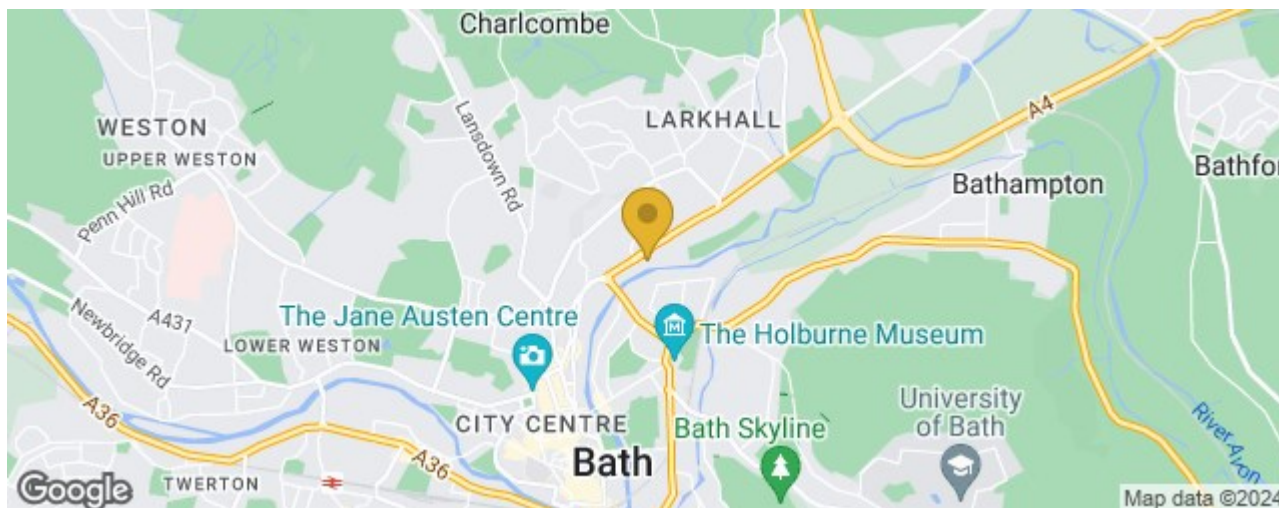



Floor Plan

GROUND FLOOR
359 sq.ft. (33.3 sq.m.) approx.

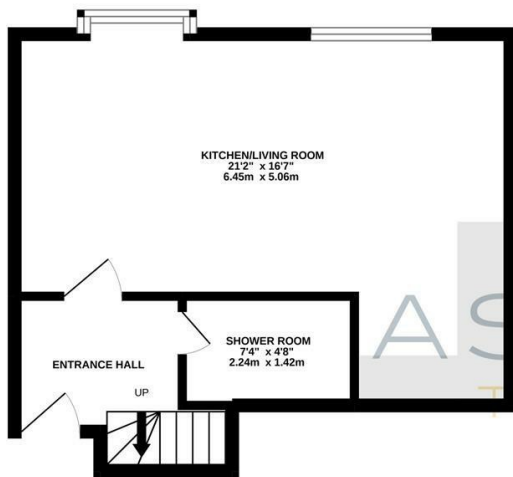

1ST FLOOR
353 sq.ft. (32.8 sq.m.) approx.

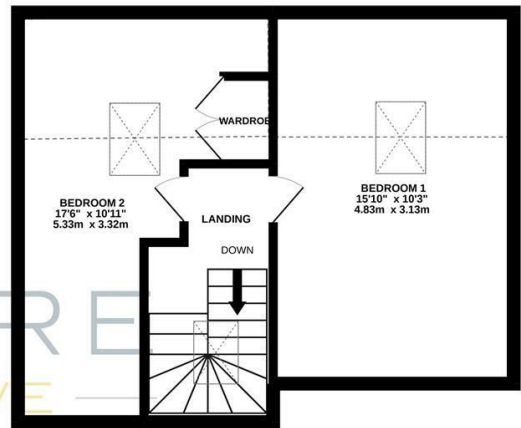

BEDFORD COURT, BATH, BA1

TOTAL FLOOR AREA : 712 sq.ft. (66.1 sq.m.) approx.

Whilst every attempt has been made to ensure the accuracy of the floorplan contained here, measurements of doors, windows, rooms and any other items are approximate and no responsibility is taken for any error, omission or mis-statement. This plan is for illustrative purposes only and should be used as such by any prospective purchaser. The services, systems and appliances shown have not been tested and no guarantee as to their operability or efficiency can be given.
Made with Metropix ©2022

These particulars, whilst believed to be accurate are set out as a general outline only for guidance and do not constitute any part of an offer or contract. Intending purchasers should not rely on them as statements of representation of fact, but must satisfy themselves by inspection or otherwise as to their accuracy. No person in this firm's employment has the authority to make or give any representation or warranty in respect of the property.

