



ASPIRE

— TO MOVE —



Portland Place, Bath, BA1

Three bedroom, second floor flat, located at Portland Place. Suitable for students and sharers and available 24th August 2024.

The flat is located on Portland Place, just 0.5 miles from central locations like Queens Square. Julian Rd convenience stores are just 0.1 miles away.

- Suitable for students or sharers
- Three double bedrooms
- Second floor flat
- Holding deposit £501
- Unfurnished
- Central location
- Council tax band D
- Available 24th August 2024
- 12 month initial contract

£2,175 PCM

Floor Plans

SECOND FLOOR 777 sq.ft. (72.1 sq.m.) approx.

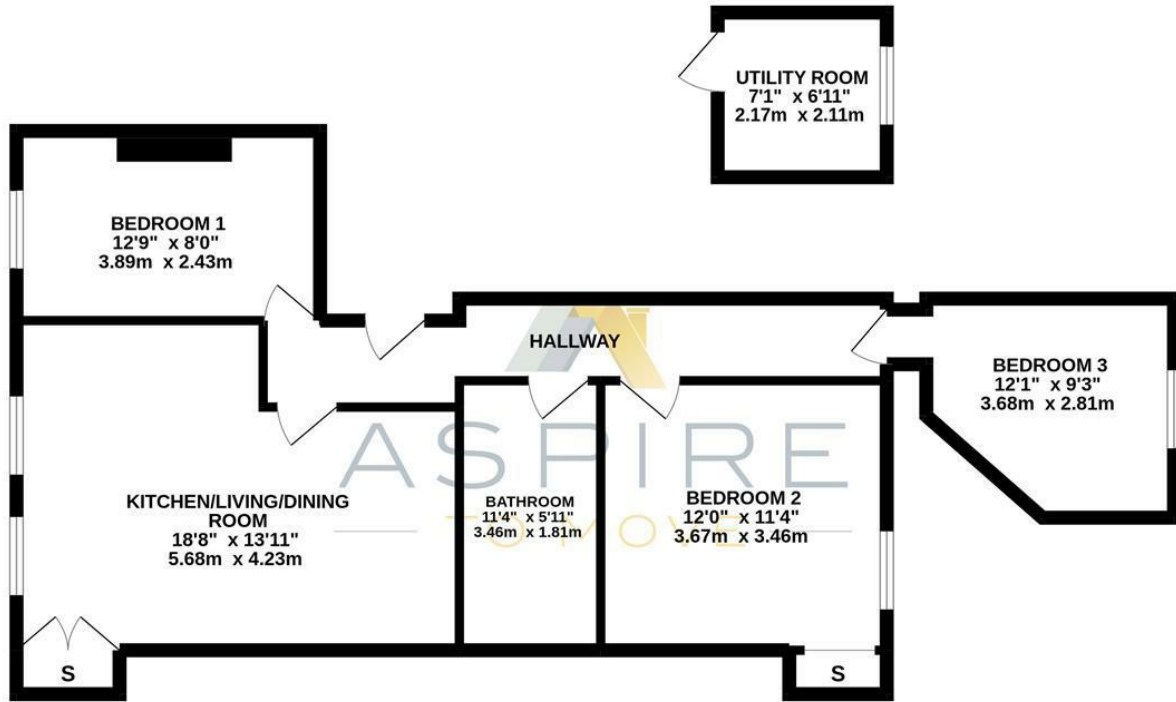

PORTLAND PLACE, BATH, BA1

TOTAL FLOOR AREA: 777 sq.ft. (72.1 sq.m.) approx.

Whilst every attempt has been made to ensure the accuracy of the floorplan contained here, measurements of doors, windows, rooms and any other items are approximate and no responsibility is taken for any error, omission or mis-statement. This plan is for illustrative purposes only and should be used as such by any prospective purchaser. The services, systems and appliances shown have not been tested and no guarantee as to their operability or efficiency can be given.
Made with Metropix ©2022

Energy Performance Graph

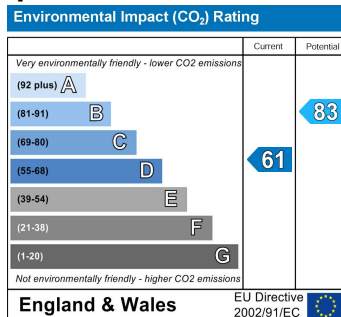
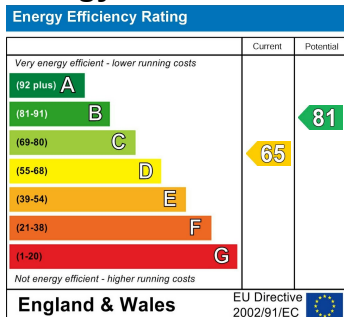

These particulars, whilst believed to be accurate are set out as a general outline only for guidance and do not constitute any part of an offer or contract. Intending purchasers should not rely on them as statements of representation of fact, but must satisfy themselves by inspection or otherwise as to their accuracy. No person in this firm's employment has the authority to make or give any representation or warranty in respect of the property.