



**70 Chester Close, Pontypool, NP4 0LU**

**Asking price £210,000**



1



2



D

# 70 Chester Close Pontypool, NP4 0LU



One2Zone is delighted to present this semi-detached property located in the desirable area of New Inn. The ground floor features an entrance hallway that leads into a spacious lounge, perfect for various seating arrangements, with stairs ascending to the first floor. The second reception room is a generously sized dining room.....

- SEMI DETACHED PROPERTY
- LOUNGE
- KITCHEN/DINER
- CONSERVATORY
- THREE BEDROOMS
- FAMILY BATHROOM
- FRONT AND REAR GARDENS
- OFF ROAD PARKING





GROUND FLOOR  
436 sq.ft. (40.5 sq.m.) approx.

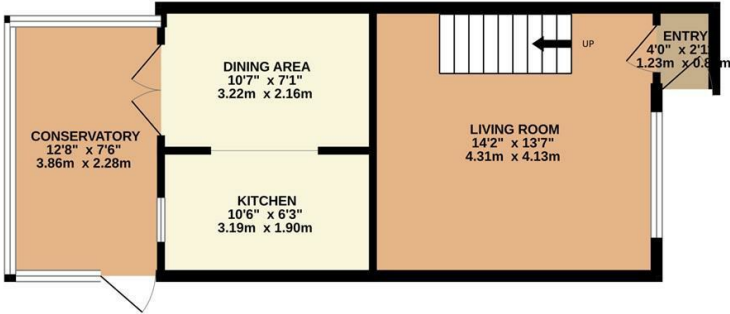

1ST FLOOR  
306 sq.ft. (28.5 sq.m.) approx.

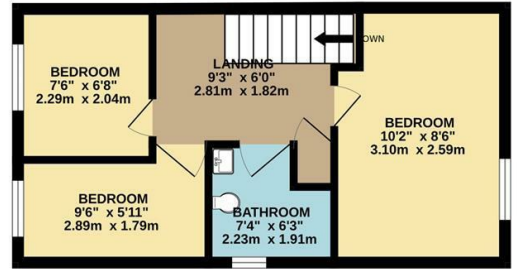

TOTAL FLOOR AREA : 742 sq.ft. (68.9 sq.m.) approx.

Whilst every attempt has been made to ensure the accuracy of the floorplan contained here, measurements of doors, windows, rooms and any other items are approximate and no responsibility is taken for any error, omission or mis-statement. This plan is for illustrative purposes only and should be used as such by any prospective purchaser. The services, systems and appliances shown have not been tested and no guarantee as to their operability or efficiency can be given.  
Made with Metropix ©2024

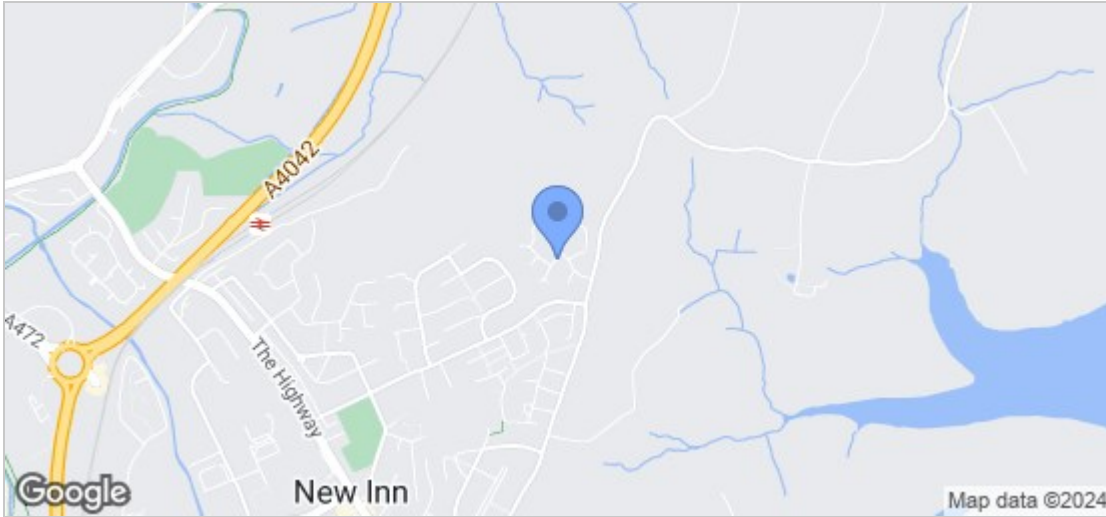

## Viewing

Please contact our One2One Estate Agents Torfaen Office on 01495219699 if you wish to arrange a viewing appointment for this property or require further information.

These particulars, whilst believed to be accurate are set out as a general outline only for guidance and do not constitute any part of an offer or contract. Intending purchasers should not rely on them as statements of representation of fact, but must satisfy themselves by inspection or otherwise as to their accuracy. No person in this firm's employment has the authority to make or give any representation or warranty in respect of the property.

Energy Efficiency Rating		
	Current	Potential
Very energy efficient - lower running costs		
(92 plus) <b>A</b>		<b>85</b>
(81-91) <b>B</b>		
(69-80) <b>C</b>	<b>68</b>	
(55-68) <b>D</b>		
(39-54) <b>E</b>		
(21-38) <b>F</b>		
(1-20) <b>G</b>		
Not energy efficient - higher running costs		
<b>England &amp; Wales</b> EU Directive 2002/91/EC		
Environmental Impact (CO <sub>2</sub> ) Rating		
	Current	Potential
Very environmentally friendly - lower CO <sub>2</sub> emissions		
(92 plus) <b>A</b>		
(81-91) <b>B</b>		
(69-80) <b>C</b>		
(55-68) <b>D</b>		
(39-54) <b>E</b>		
(21-38) <b>F</b>		
(1-20) <b>G</b>		
Not environmentally friendly - higher CO <sub>2</sub> emissions		
<b>England &amp; Wales</b> EU Directive 2002/91/EC		