



**5 Gantref Way, Ebbw Vale, NP23 5LP**  
**Guide price £300,000**



\*\*\*GUIDE PRICE £300,000 - £310,000\*\*\*

One2one are delighted to present this Detached Bungalow set in a Prime Location. The property offers modern comfort and style, nestled in a serene neighborhood, this beautiful property presents an extraordinary opportunity for discerning buyers seeking quality living space.



## MAIN DESCRIPTION

\*\*\*GUIDE PRICE £300,000 -  
£310,000\*\*\*

One2one are delighted to present this Detached Bungalow set in a Prime Location. The property offers modern comfort and style, nestled in a serene neighborhood, this beautiful property presents an extraordinary opportunity for discerning buyers seeking quality living space. Upon arrival, you'll be captivated by the immaculate presentation of this home. Step inside to discover a spacious hallway and a lounge bathed in natural light. The modern fitted kitchen is equipped with matching floor and wall cupboard units with ample work space. As well as a useful utility room. The second reception room is a good sized dining room which provides ample space for a family sized dining table and chairs.

This bungalow boasts four generously sized bedrooms. The family bathroom and additional shower room ensure convenience and comfort for all occupants.

Outside, parking facilities to the front provide convenience for residents and visitors, while a garage to the rear offers secure storage for vehicles and other belongings.

Council Tax Band 'D'

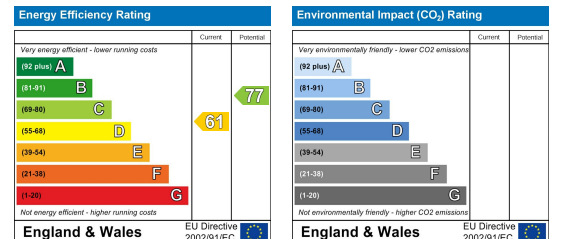
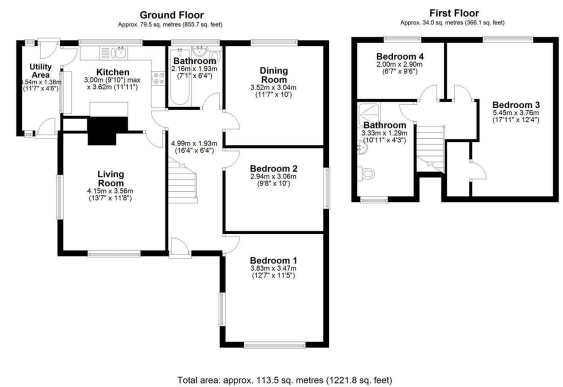
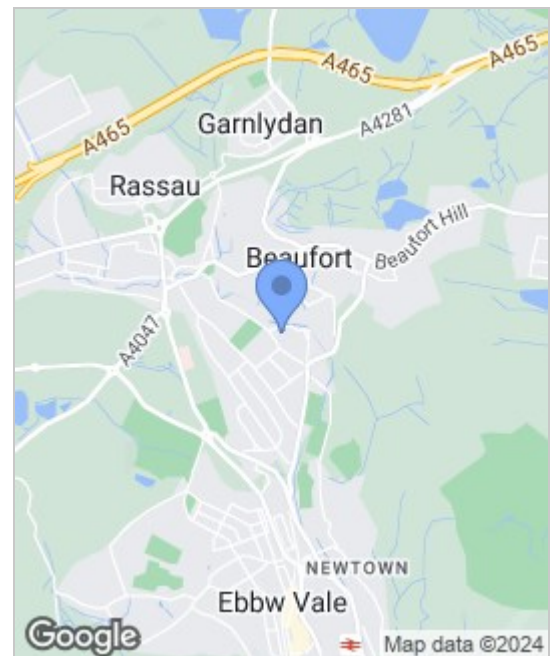

These particulars, whilst believed to be accurate are set out as a general outline only for guidance and do not constitute any part of an offer or contract. Intending purchasers should not rely on them as statements of representation of fact, but must satisfy themselves by inspection or otherwise as to their accuracy. No person in this firm's employment has the authority to make or give any representation or warranty in respect of the property.