



57 Lancaster Walk | Gateford | S81 7NG

Guide Price £200,000 to £210,000

Bell & Co Estates are excited to bring to market this three-bedroom semi-detached home with garage, driveway, and gardens in a sought-after residential spot of Gateford. Step inside and you'll find a spacious lounge, dining area, perfect for family living and entertaining, plus a modern fitted kitchen with plenty of worktop and cupboard space, integrated appliances and rear door access. To the rear an added conservatory, perfect for relaxing. Upstairs are three well-sized bedrooms, and a family bathroom – ideal for young families, first-time buyers, or anyone looking for a home they can put their own stamp on. Outside, the property benefits from a driveway and garage for secure parking, a front garden, and a private rear garden – perfect for summer evenings, gardening, or creating your own relaxing outdoor retreat. With excellent local schools, shops, parks, and transport links nearby – including easy access to Worksop, Sheffield, Rotherham – this home ticks all the boxes for location, lifestyle, and convenience. Whether you're a first-time buyer, a growing family, or an investor looking for a solid rental opportunity, this property is ready to make your own. Contact Bell & Co Estates today to arrange a viewing – homes like this don't stay on the market for long!



GROUND FLOOR
470 sq.ft. (43.7 sq.m.) approx.

1ST FLOOR
383 sq.ft. (35.6 sq.m.) approx.

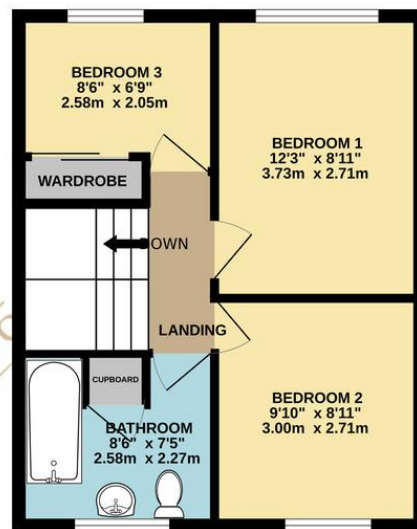
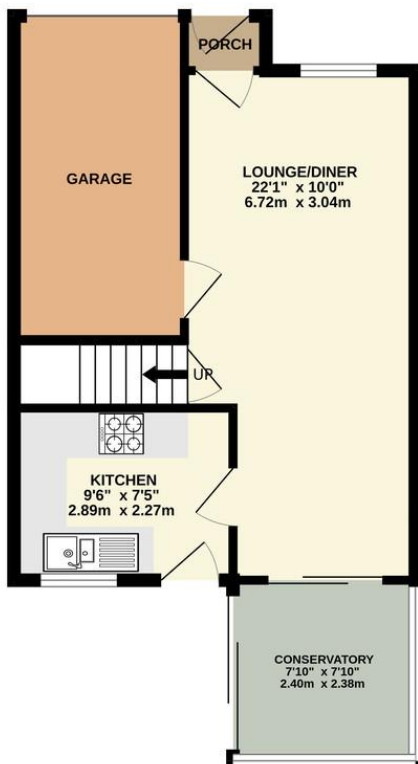

Contact Details

79 Wales Road
Kiveton Park
Sheffield
South Yorkshire
S26 6RA

www.bellcoestates.com
info@bellcoestates.com
03333 580590

57 Lancaster Walk
WORKSOP
S81 7NG

Energy rating

D

Valid until
3 October 2035

Certificate number
2311-3973-8291-4211-2114

Property type Semi-detached house

Total floor area 69 square metres

Agents Note: Whilst every care has been taken to prepare these sales particulars, they are for guidance purposes only. All measurements are approximate are for general guidance purposes only and whilst every care has been taken to ensure their accuracy, they should not be relied upon and potential buyers are advised to recheck the measurements