



106 School Road | Wales | Sheffield | S26 5QJ

Guide Price £120,000 to £130,000

Bell & Co Estates are delighted to present this well presented two-bedroom mid-terrace property, recently redecorated with new flooring throughout, offering stylish accommodation ideal for first-time buyers, downsizers, or investors. Step into a cosy lounge, positioned at the front of the home, leading into a spacious, kitchen/diner positioned at the rear of the home overlooking the rear garden, featuring ample cupboard space, room for appliances, and a dining area with access door to the rear. A useful understairs cupboard offers handy storage and completes this floor. Upstairs comprises two well-proportioned bedrooms. The main bedroom is a generous double with a built-in cupboard, while the second bedroom offers excellent flexibility as a guest room, nursery, or home office. Completing the accommodation is a fresh, contemporary bathroom fitted with a white suite including bath with shower over, wash basin, and WC. Externally, the property benefits from a rear enclosed garden with artificial grass that could be landscaped to suit your own style, there is also on-street parking available. This move-in ready property offers an excellent opportunity to purchase a well-presented home in a sought-after village location, close to local amenities and transport links this home is in a prime location.



GROUND FLOOR
279 sq.ft. (25.9 sq.m.) approx.

1ST FLOOR
279 sq.ft. (26.0 sq.m.) approx.

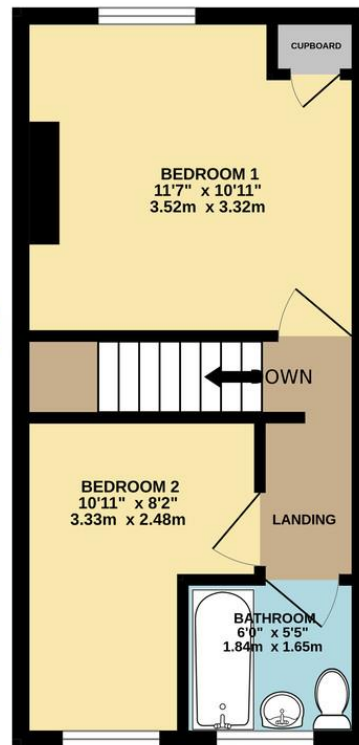
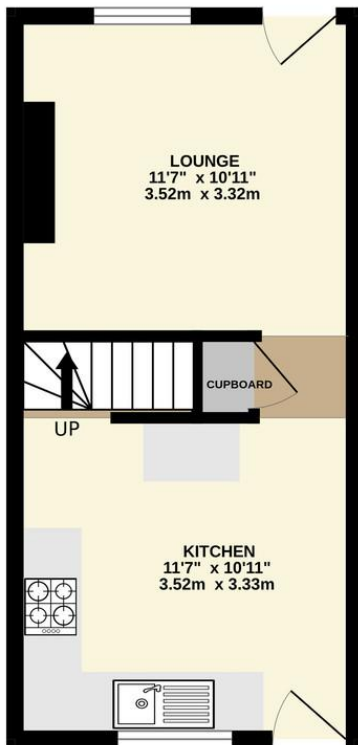

Contact Details

79 Wales Road
Kiveton Park
Sheffield
South Yorkshire
S26 6RA

www.bellcoestates.com
info@bellcoestates.com
03333 580590

106, School Road
Wales
SHEFFIELD
S26 5QJ

Energy rating

D

Valid until
10 July 2027

Certificate number
8603-7823-5950-6259-4992

Property type Mid-terrace house

Total floor area 54 square metres

Agents Note: Whilst every care has been taken to prepare these sales particulars, they are for guidance purposes only. All measurements are approximate are for general guidance purposes only and whilst every care has been taken to ensure their accuracy, they should not be relied upon and potential buyers are advised to recheck the measurements