



21 Langdale Way | Dinnington | Sheffield | S25 2TS

Guide Price £150,000 to £160,000

Bell & Co Estates are delighted to present this two-bedroom semi-detached home, nestled in a quiet cul-de-sac in the heart of Dinnington. Offering a warm and inviting atmosphere, this home is ideal for first-time buyers looking for a peaceful yet well-connected location. Upon entering, you are welcomed into the fitted kitchen, complete with ample storage and workspace, as well as room for a dining table-perfect for entertaining or casual meals. The rear-facing conservatory provides an excellent additional living area, offering garden views with a door opening onto the rear garden. A front-facing lounge offers a cosy retreat, with stairs leading to the first floor. To the first floor the master bedroom is a spacious double room, the second bedroom is another well-proportioned room and a family bathroom, fitted with a shower over bath, WC, and sink unit. Externally the paved driveway provides ample off-road parking, leading to a gated carport and to the rear is an enclosed rear garden, featuring a lawned area, brick-built storage room, and shed-ideal for additional storage or a workshop. Situated in a peaceful cul-de-sac, this home offers easy access to local amenities & shops as well as excellent transport links to Sheffield, Rotherham & Worksop. This home is an excellent opportunity for first-time buyers or small families. Viewing is highly recommended-contact us today to arrange yours!



GROUND FLOOR
331 sq.ft. (30.8 sq.m.) approx.



1ST FLOOR
251 sq.ft. (23.3 sq.m.) approx.

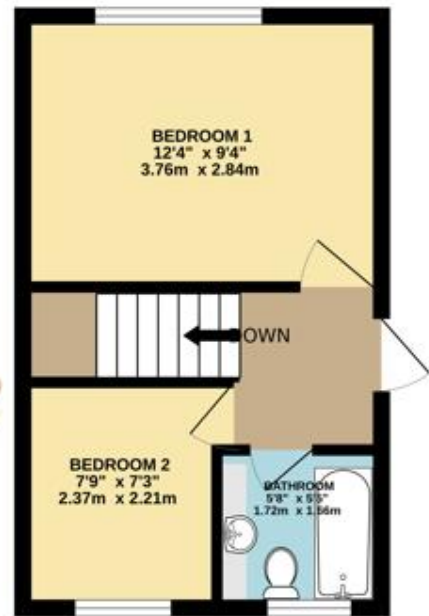

BELL & CO
ESTATES

Contact Details

79 Wales Road
Kiveton Park
Sheffield
South Yorkshire
S26 6RA

www.bellcoestates.com
info@bellcoestates.com
03333 580590

21, Langdale Way
Dinnington
SHEFFIELD
S25 2TS

Energy rating

D

Valid until

19 October 2027

Certificate number

9655-2840-7408-9423-3511

Property type

Semi-detached house

Total floor area

49 square metres

Agents Note: Whilst every care has been taken to prepare these sales particulars, they are for guidance purposes only. All measurements are approximate are for general guidance purposes only and whilst every care has been taken to ensure their accuracy, they should not be relied upon and potential buyers are advised to recheck the measurements