



88 Wales Road | Kiveton | S26 6RD

£110,000

Bell & Co Estates are delighted to present this Three Bedroom Mid Terraced Property in Kiveton, situated close to local amenities and selling with no vendor chain. Perfect for a first time buyer or investment opportunity. In brief the property comprises of Lounge with feature fireplace, through into the Dining Room with further feature fireplace, flowing into the Kitchen with fitted units and access to the rear. To the upstairs are two double Bedrooms and one good sized single bedroom. Family Bathroom with sink unit, WC and shower over bath. Close to schools, transport links and local amenities this home is in a great location. Viewing is highly recommended to fully appreciate what this home has to offer.

- No Chain!
- Three Bedroom Mid Terraced
- Lounge
- Dining Room
- Kitchen
- Three Bedrooms
- Family Bathroom



GROUND FLOOR 49.44 sq. m.
(532.13 sq. ft.)

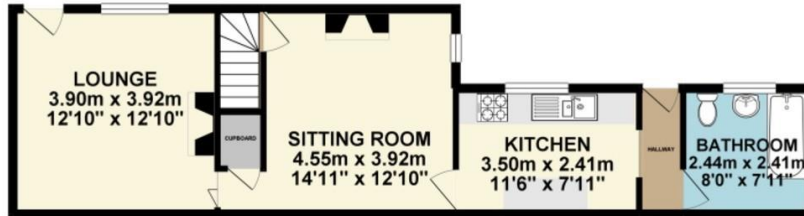

1ST FLOOR 41.56 sq. m.
(447.32 sq. ft.)

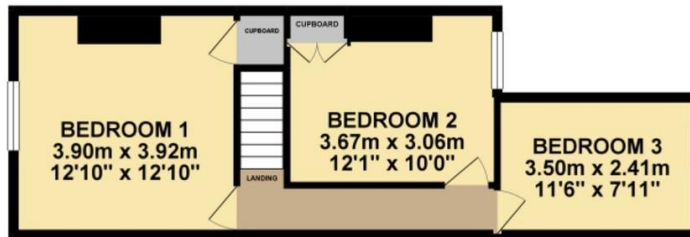

TOTAL FLOOR AREA: 90.99 sq. m. (979.46 sq. ft.) approx.

Whilst every attempt has been made to ensure the accuracy of the floorplan contained here, measurements of doors, windows, rooms and any other items are approximate and no responsibility is taken for any error or omission in this statement. This plan is for guidance purposes only and should be used as such by any prospective purchaser. The services, systems and appliances shown have not been tested and no guarantee is given in their operability or efficiency can be given.
Made with Metreplan ©2024

Contact Details

79 Wales Road
Kiveton Park
Sheffield
South Yorkshire
S26 6RA

www.bellcoestates.com
info@bellcoestates.com
03333 580590

88 Wales Road
Kiveton Park
SHEFFIELD
S26 6RD

Energy rating

D

Valid until
16 September 2034

Certificate number
2409-2287-1021-7919-1511

Property type Mid-terrace house

Total floor area 90 square metres

Agents Note: Whilst every care has been taken to prepare these sales particulars, they are for guidance purposes only. All measurements are approximate are for general guidance purposes only and whilst every care has been taken to ensure their accuracy, they should not be relied upon and potential buyers are advised to recheck the measurements