



92 Station Road | Kiveton Park | Sheffield | S26 6QQ

£130,000

Bell & Co Estates are delighted to present this modern, Two Bedroom Mid Terraced Home in Kiveton Park. Having been updated by its current owners over the last couple of years this is a home you can move straight into with absolutely nothing to do! In brief the property comprises of cosy, front facing Lounge leading into a separate Dining Room and modern fitted Kitchen with door providing access to the rear. There is a real open plan feel making this a great space for entertaining or spending time with family. To the upstairs are two lovely double Bedrooms, a Laundry Room which is a fabulous addition and a modern Bathroom with Shower over Bath, Sink and WC. To the front a gate provides access to the front of the property make it nice and enclosed. To the rear steps down allow access into an enclosed garden with patio area, borders and under house storage, and double gates open up on to the path to the rear where off road parking is available. Close to local amenities, schools and transport links this home is in a prime location.

- Two Bedroom Terraced
- Lounge
- Separate Dining Room
- Rear Kitchen
- TWO DOUBLE BEDROOMS
- Family Bathroom
- Modern Throughout
- Perfect Home!
- A Must See

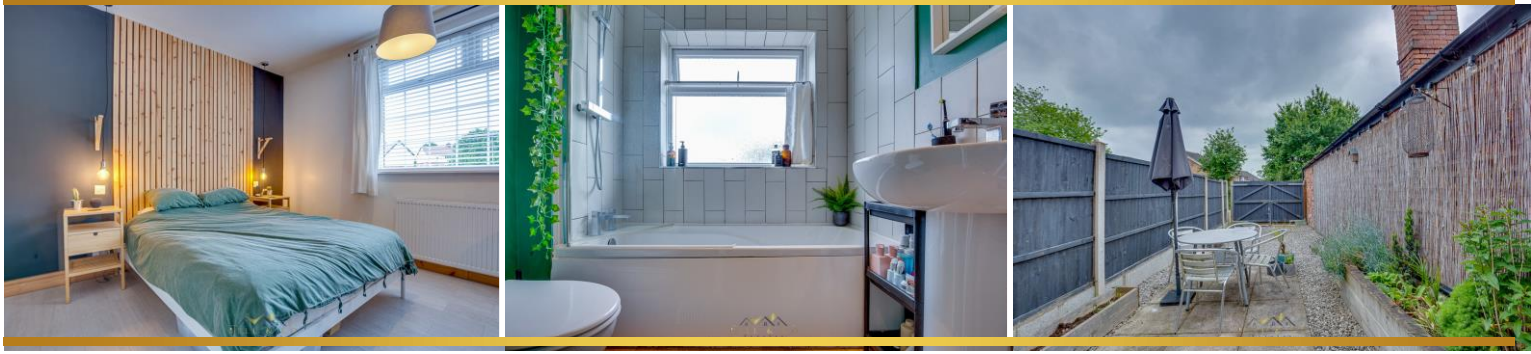

GROUND FLOOR
387 sq.ft. (35.9 sq.m.) approx.

1ST FLOOR
394 sq.ft. (36.6 sq.m.) approx.

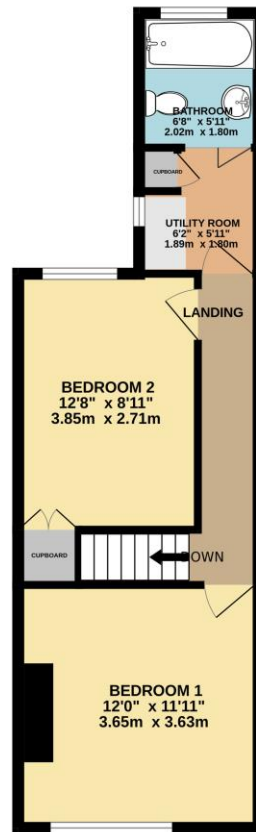
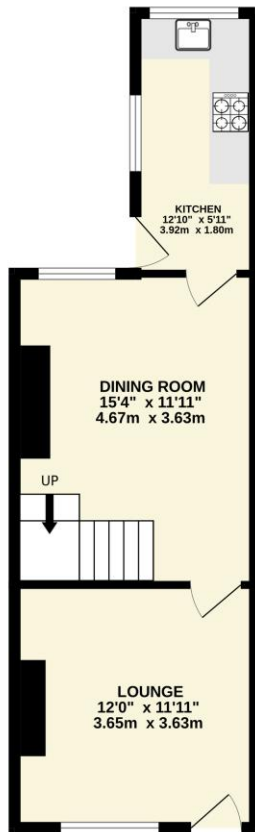

Contact Details

79 Wales Road
Kiveton Park
Sheffield
South Yorkshire
S26 6RA

www.bellcoestates.com

03333 580590

92 Station Road
Kiveton Park
SHEFFIELD
S26 6QQ

Energy rating

C

Valid until
21 May 2034

Certificate number
2790-3038-8205-8864-2200

Property type Mid-terrace house

Total floor area 74 square metres

Agents Note: Whilst every care has been taken to prepare these sales particulars, they are for guidance purposes only. All measurements are approximate and for general guidance purposes only and whilst every care has been taken to ensure their accuracy, they should not be relied upon and potential buyers are advised to recheck the measurements