



15 Borrowdale Crescent | North Anston | S25 4JW

£215,000

Bell & Co Estates are honoured to present this EXTENDED, THREE BEDROOM SEMI-DETACHED home in North Anston offered with NO VENDOR CHAIN. In brief the property comprises of Entrance Hallway, front facing spacious Lounge with open plan Dining Area and patio doors opening onto the rear garden. NEWLY FITTED KITCHEN with integrated appliances, breakfast bar and Utility area with downstairs WC. Further rear door for access into the garden and integral door leading into the Garage which houses the boiler. Upstairs are TWO LARGE DOUBLE BEDROOMS and one further good sized single Bedroom, NEWLY FITTED BATHROOM with shower over bath, wash basin and WC. To the front of the property is a grassed area with newly laid blocked paved drive providing off road parking. To the rear of the property is a beautiful pergola, greenhouse, shed and patio area. Close to all local amenities, transport links and schools, this property is in a prime location. Viewing is highly recommended to fully appreciate what this beautiful home has to offer.

- NO CHAIN!
- Three Bedroom Semi Detached
- Modern Throughout
- Spacious Lounge
- Extension to Rear
- Open Plan Kitchen / Diner
- Recently Renovated
- Private Enclosed Garden



GROUND FLOOR
583 sq.ft. (54.1 sq.m.) approx.



1ST FLOOR
366 sq.ft. (34.0 sq.m.) approx.

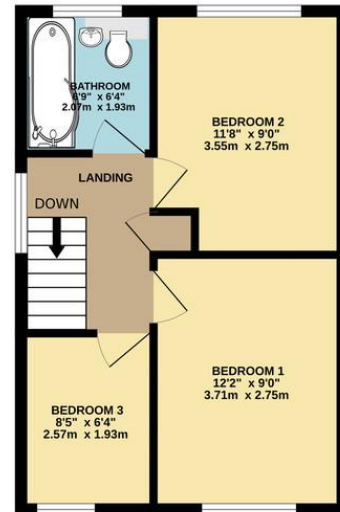

TOTAL FLOOR AREA: 949 sq.ft. (88.1 sq.m.) approx.

Whilst every attempt has been made to ensure the accuracy of the floorplan contained here, measurements of doors, windows, rooms and any other items are approximate and no responsibility is taken for any error, omission or mis-statement. This plan is for illustrative purposes only and should be used as such by any prospective purchaser. The services, systems and appliances shown have not been tested and no guarantee as to their operability or efficiency can be given.
Made with Metropix ©2024

Contact Details

79 Wales Road
Kiveton Park
Sheffield
South Yorkshire
S26 6RA

www.bellcoestates.com

03333 580590

15 Borrowdale Crescent
North Anston
SHEFFIELD
S25 4JW

Energy rating

C

Valid until
26 March 2034

Certificate number
2095-3036-8207-7444-4200

Property type Semi-detached house

Total floor area 74 square metres

Agents Note: Whilst every care has been taken to prepare these sales particulars, they are for guidance purposes only. All measurements are approximate and for general guidance purposes only and whilst every care has been taken to ensure their accuracy, they should not be relied upon and potential buyers are advised to recheck the measurements