



43 Brampton Meadows | Thurcroft | S66 9ND

£200,000

Bell & Co Estates are delighted to present this perfect, THREE Bedroom DETACHED home in THURCROFT. This home is simply beautiful and modern throughout, making this the perfect family home. Comprising of Entrance Hallway leading to the Lounge with under stairs cupboard, Modern Kitchen with breakfast bar and many integrated appliances, Upstairs are TWO good-sized bedrooms, master with fitted wardrobes and further good sized single bedroom, modern FAMILY Bathroom with shower over bath, wash basin and w/c. To the outside is a DRIVEWAY with amply parking, to the rear is an ENCLOSED Garden with patio, grassed area and SUMMERHOUSE. Viewing is highly recommended to see the true beauty this home has to offer.

- Three Bedroom Detached
- Spacious Throughout
- Modern Kitchen with Breakfast Bar
- Separate Large Lounge
- Master Bedroom With Fitted Wardrobes

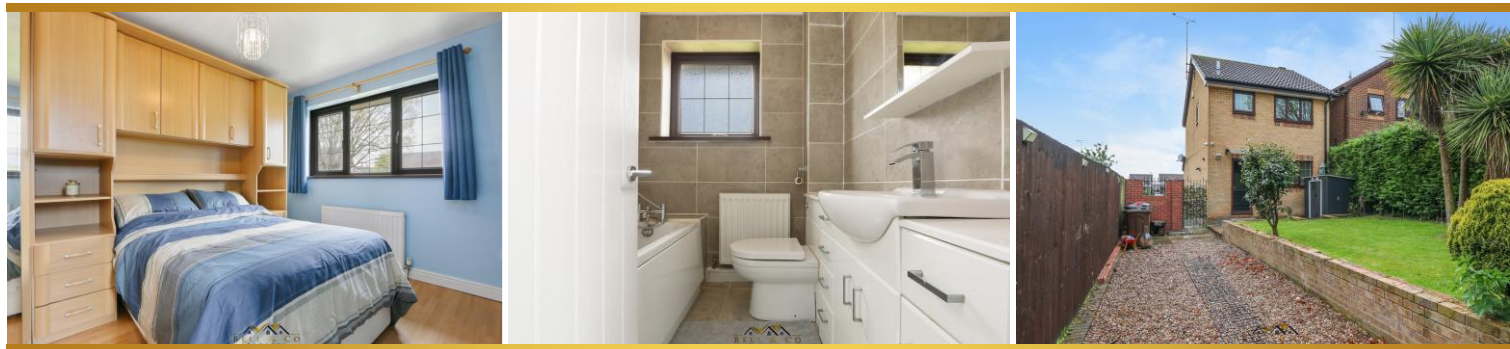

GROUND FLOOR
358 sq.ft. (33.3 sq.m.) approx.

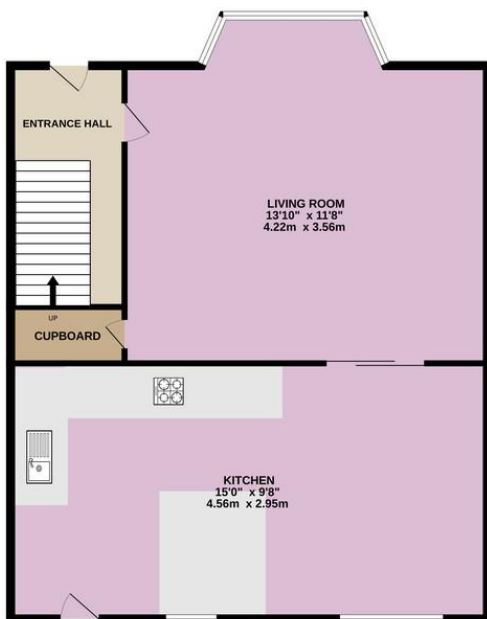

1ST FLOOR
358 sq.ft. (33.3 sq.m.) approx.

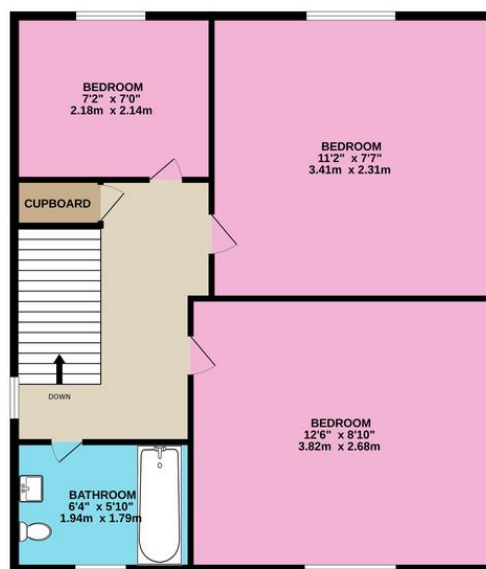

TOTAL FLOOR AREA: 717 sq.ft. (66.6 sq.m.) approx.

Whilst every attempt has been made to ensure the accuracy of the floorplan contained here, measurements of doors, windows, rooms and any other items are approximate and no responsibility is taken for any error, omission or mis-statement. This plan is for illustrative purposes only and should be used as such by any prospective purchaser. The services, systems and appliances shown have not been tested and no guarantee as to their operability or efficiency can be given.
Made with Metropix ©2023

Contact Details

79 Wales Road
Kiveton Park
Sheffield
South Yorkshire
S26 6RA

www.bellcoestates.com

03333 580590

43 Brampton Meadows
Thurcroft
ROTHERHAM
S66 9ND

Energy rating

D

Valid until
5 May 2033

Certificate number
2517-5375-8218-7752-6761

Property type

Detached house

Total floor area

67 square metres

Agents Note: Whilst every care has been taken to prepare these sales particulars, they are for guidance purposes only. All measurements are approximate and are for general guidance purposes only and whilst every care has been taken to ensure their accuracy, they should not be relied upon and potential buyers are advised to recheck the measurements