

For Sale / To Let

London Road, Kingston Upon Thames, KT2 6RA



REF: AMP4223

- Secure covered car park currently benefitting from Sui Gen Use
- Includes garage, office/storage and WC facilities
- Approximately 5,580 sq. ft
- May be suitable for alternative uses
- Comprises of 20 car spaces
- In a predominantly residential area



An aerial photograph of a residential complex. The complex consists of several multi-story brick buildings with red-tiled roofs, arranged in a U-shape around a central area. This central area contains a paved car park with several cars parked, a smaller paved area, and some green spaces with trees and shrubs. The surrounding area includes other buildings, roads, and parking lots. A dark blue semi-transparent box is overlaid on the top right of the image, containing the title 'Description' and a paragraph of text. A white box with the reference number 'REF: AMP4223' is located in the bottom left corner. The bottom of the image features a dark blue banner with the text 'Secure Covered Car Park Currently Benefitting From Sui Gen Use' and the 'Alex Martin' logo and name on the right.

Description

This secure covered car park currently benefitting from Sui Gen use is approximately 5,580 sq. ft and comprises of 20 car spaces. The space also includes a garage, office/storage and WC facilities. It may also be suitable for alternative uses.

REF: AMP4223

Secure Covered Car Park Currently Benefitting From Sui Gen Use

 Alex Martin



Location

This site is located in Kingston Upon Thames, South West London. It is in a predominantly residential area and has many amenities nearby including Supermarkets, Cafes and Retail stores with the likes of Asda, Costa Coffee and Primark. The closest stations are Kingston and Norbiton which provide you with South Western Railway services and bus services also readily available.

REF: AMP4223

Secure Covered Car Park Currently Benefitting From Sui Gen Use

 Alex Martin

FLOORPLAN

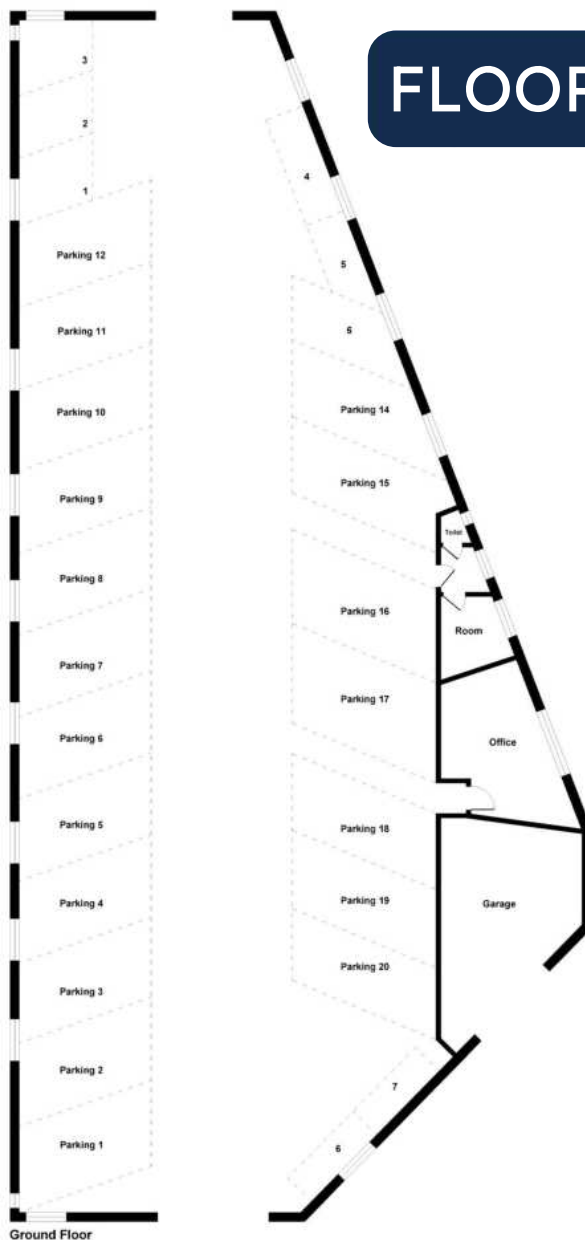

Ground Floor

Accommodation:

Total - 5,580 sq. ft

VAT:

Not Applicable

Terms:

Guide Price/Rent - POA

EPC:

Not required

Viewings:

Strictly by appointment with Alex Martin



ALEX DAWSON

E alex@alexmartin.co.uk

M 07949 745533

T 020 7100 2348



JOE FOX

E joe@alexmartin.co.uk

M 07469 170711

T 020 7100 2348

REF: AMP4222

Secure Covered Car Park Currently Benefitting From Sui Gen Use

Alex Martin
Alpha House
100 Borough High Street
London, SE1 1LB

www.alexmartin.co.uk