



Living
made
better

Hillary Drive
Isleworth, TW7 7EG



Asking Price £310,000

Hillary Drive, Isleworth, TW7 7EG

Madison Brook

Property Summary

A well-presented two-bedroom ground floor apartment situated within a gated development on Hillary Drive. Offering approximately 540 sq ft of accommodation, the property comprises a spacious reception room, separate fitted kitchen, two bedrooms, a modern family bathroom and a shower room.

Further benefits include allocated parking, communal gardens, a long lease of approximately 97 years remaining, and no onward chain. Conveniently located within walking distance of local amenities and transport links, this property is ideal for first-time buyers, downsizers or investors. Early viewing advised.

Service Charge: £1,740 pa | Ground Rent: £302 pa | Lease Remaining: 97 years

Floorplan

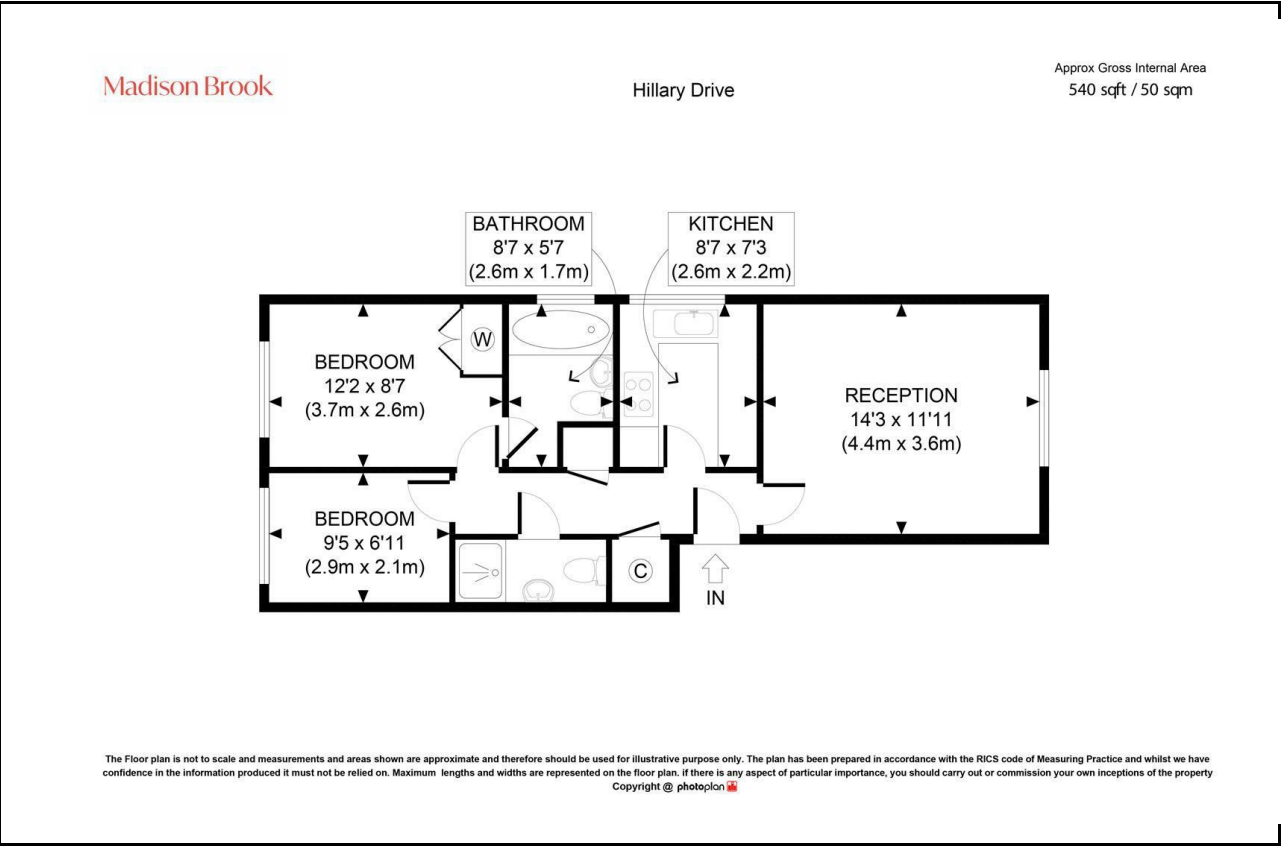

Area Map

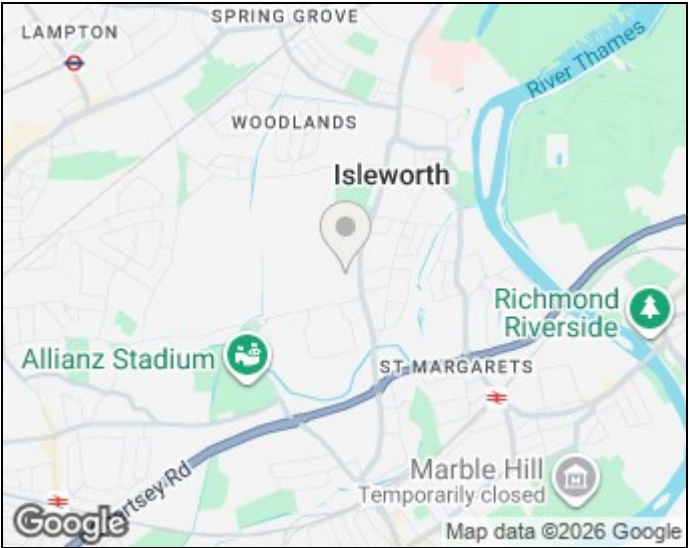

Energy Efficiency Graph

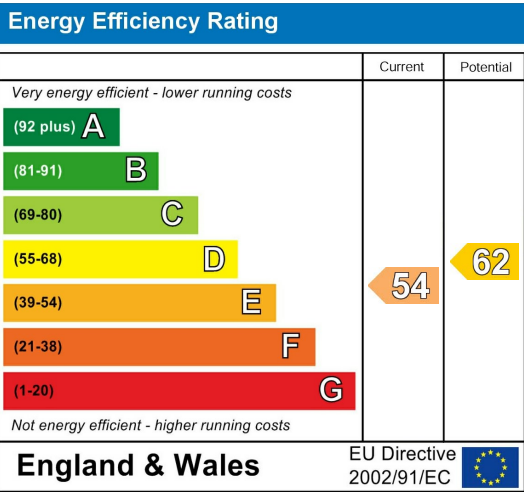

These particulars, whilst believed to be accurate are set out as a general outline only for guidance and do not constitute any part of an offer or contract. Intending purchasers should not rely on them as statements of representation of fact, but must satisfy themselves by inspection or otherwise as to their accuracy. No person in this firm's employment has the authority to make or give any representation or warranty in respect of the property.

16 Church Street, Twickenham, TW1 3NJ
Tel: 020 3946 6400 Email:
twickenham@madisonbrook.com
<https://madisonbrook.com/>